

Fans

F 800, 1000, 1200, 1800, 3000, 5000, 8000, C 600

F 800

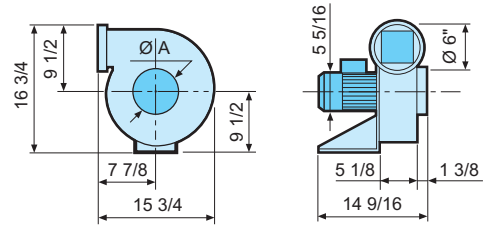

F 1000/1200

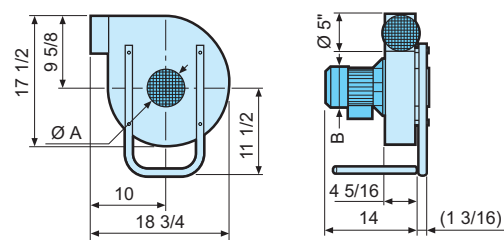

F 1800/3000

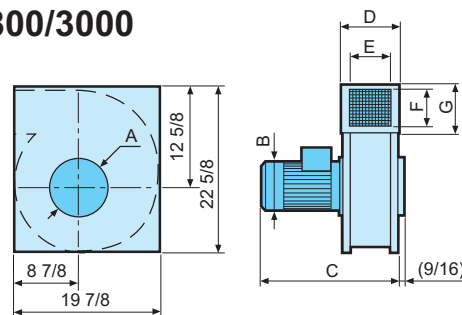

F 5000

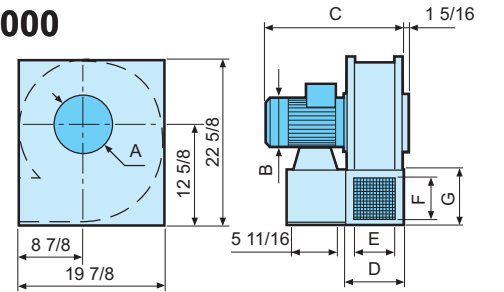

F 8000

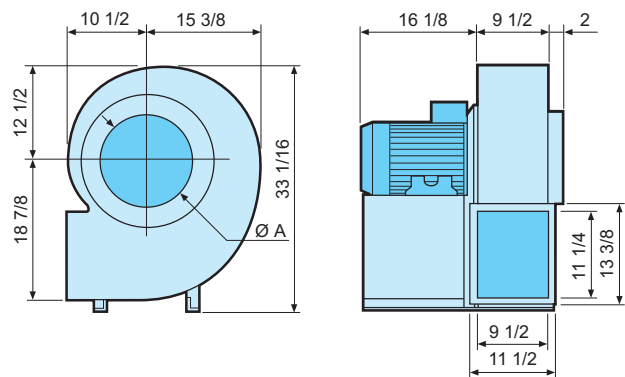

C 600

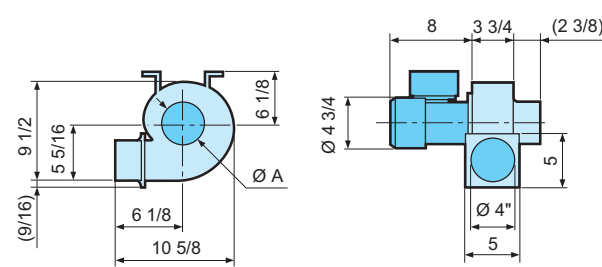

Designation	Measurement						
	A	B	C	D	E	F	G
F 800	$\varnothing 6$ "	-	-	-	-	-	-
F 1000	$\varnothing 5$ "	$\varnothing 5 \frac{1}{2}$ "	-	-	-	-	-
F 1200	$\varnothing 5$ "	$\varnothing 5 \frac{7}{8}$ "	-	-	-	-	-
F 1800	$\varnothing 6$ "	$\varnothing 6$ "	$13 \frac{3}{8}$ "	-	$4 \frac{5}{16}$ "	$5 \frac{1}{2}$ "	$6 \frac{1}{2}$ "
F 3000	$\varnothing 8$ "	$\varnothing 7$ "	$19 \frac{5}{16}$ "	$7 \frac{1}{2}$ "	$5 \frac{1}{2}$ "	$5 \frac{1}{2}$ "	$6 \frac{1}{2}$ "
F 5000	$\varnothing 13$ "	$\varnothing 9$ "	24 "	$11 \frac{1}{2}$ "	$9 \frac{1}{2}$ "	$7 \frac{11}{16}$ "	$8 \frac{11}{16}$ "
F 8000	$\varnothing 13$ "	-	-	-	-	-	-
C 600	$\varnothing 4$ "	-	-	-	-	-	-

Designation	No of revs rpm	Rated power		Rated current		Voltage V	Weight lb
		kW	Hp	A 1-phase 120 V	A 3-phase 208 V 460 V		
F 800 -3	3410	0.37	0.5		1.69	208	24
F 800 -1	3450	0.37	0.5	4.8		120	26
F 1000 -3	3440	0.55	0.75		2.37	208	24
F 1000 -1	3400	0.55	0.75			120	29
F 1200 -3	3420	0.75	1		3.3	208	33
F 1200 -1	3430	0.75	1	10.6		120	38
F 1800 -3	2444	1.1	1.5		4.6	208or460	53
F 1800 -1	3450	1.1	1.5	15.9	2.4	120	55
F 3000	3420	2.2	3.0		8.5	208or460	70
F 5000	3444	4.0	5.5		13.8	208or460	115
F 8000	3444	7.5	10		25.5	208or460	187
C 600-3		0.25	0.33		1.24	208	15
C 600-1	3450	0.25	0.33	4.2		120	13

FANS F

Fan casing

Made of powder coated sheet steel.

Impellers

T-impellers made of cast aluminium alloy.

Motor

3-phase or single phase asynchronous motors. Housing rated IP 55. Insulation class F
Versions available on request include other voltages, two-speed and explosion proof.

Accessories

The MOVEX range also includes contactors and manually operated protective motor switches.
Where variable fan speeds are required, use the MOVEX electronic controller SFO, which may be combined with the pressure regulator ST 200 to optimise fan performance. See sales sheet Control Units.

Other information

Fans F 1000 and F 1200 are supplied complete with mounting brackets. Other versions have integrated mounting fittings.
MOVEX may also supply larger fans on request.

FANS C

Fan casing

Made of powder coated sheet steel.

Impellers

F-impellers made of steel plate coated with zinc.

Motor

3-phase or single phase asynchronous motors. Housing rated IP 55. Insulation Class F.

Accessories

The MOVEX range also includes contactors and manually operated protective motor switches.
Where variable fan speeds are required, use the MOVEX electronic controller SFO, which may be combined with the pressure regulator ST 200 to optimise fan performance. See sales sheet Control Units.

CUSTOMER:
CUSTOMER P.O.:
PROJECT:
ENGINEER:
SALES REP.:
IDENTIFICATION / TAGGING:

> www.lev-co.com • 1.888.862.5356

lev-co

The device depicted and described hereon embodies proprietary information owned by the manufacturer. All design, manufacturing, reproduction, sales and patent rights regarding this device or drawing reserved except where explicit right is guaranteed in writing. We reserve the right to make design changes.

Drawn by: Janos B
Date: 1/12/2015
Scale: NTS
Weight: N/A

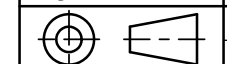

MOVEX
F-FANS
Specification Drawing
Drawing No.: -
Material: -
File Name: MOVEX-F-FANS-SD
Sheet: 1/3

PERFORMANCE

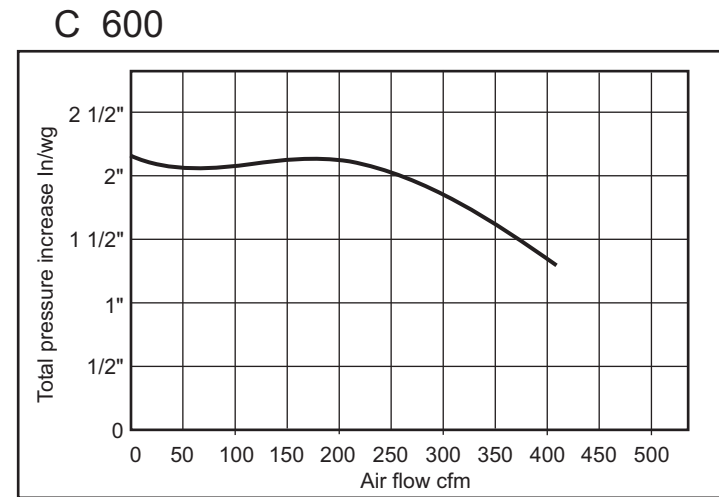
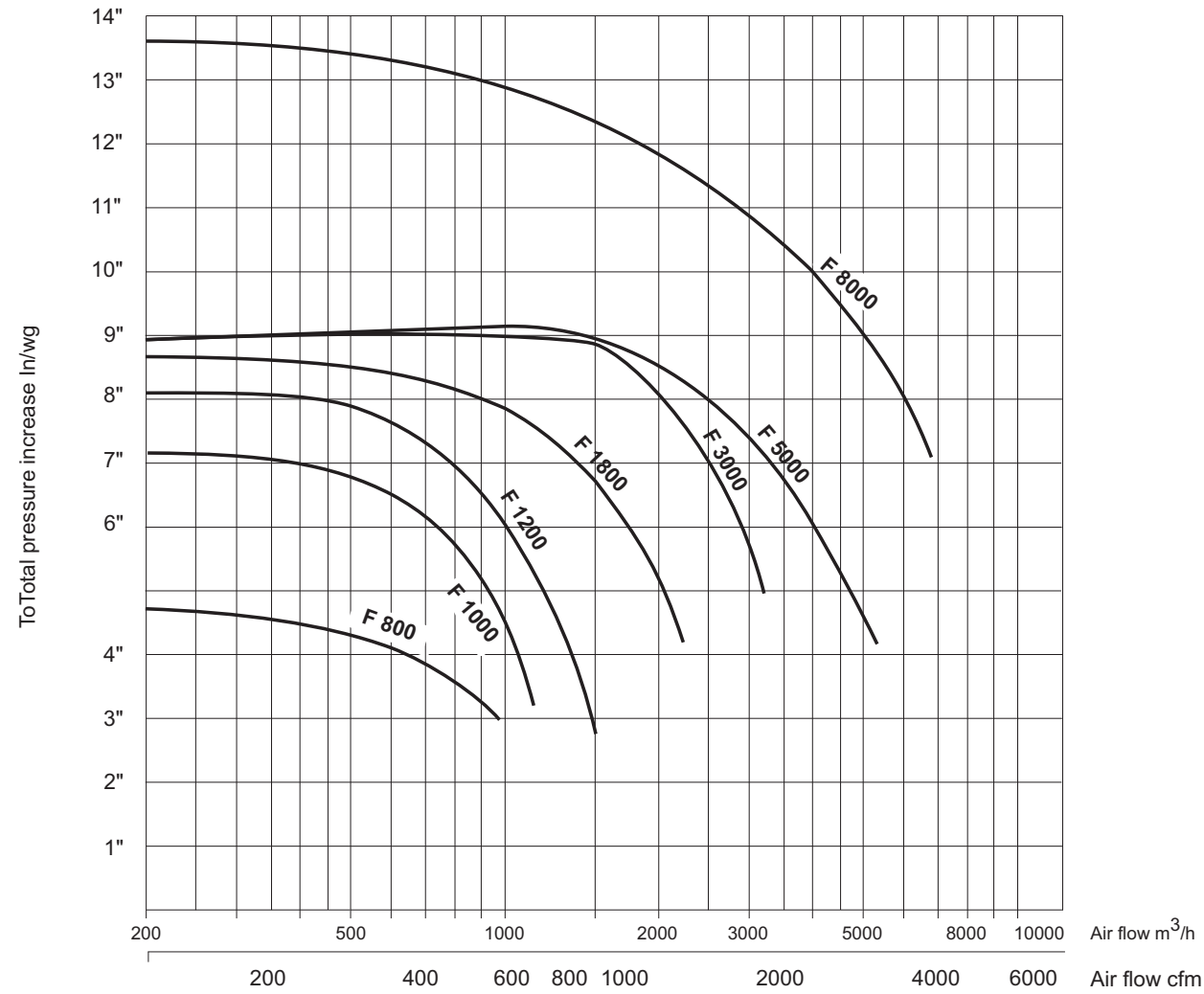

— Total pressure

CUSTOMER:
 CUSTOMER P.O.:
 PROJECT:
 ENGINEER:
 SALES REP.:
 IDENTIFICATION / TAGGING:

> www.lev-co.com • 1.888.862.5356

lev-co

The device depicted and described hereon embodies proprietary information owned by the manufacturer. All design, manufacturing, reproduction, sales and patent rights regarding this device or drawing reserved except where explicit right is guaranteed in writing. We reserve the right to make design changes.

Drawn by: Janos B
 Date: 1/12/2015
 Scale: NTS
 Weight: N/A

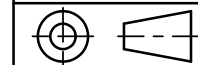

**MOVEX
 F-FANS**
 Specification Drawing

Drawing No.: - File Name: MOVEX-F-FANS-SD
 Material: - Sheet: 2/3

CLOCKWISE ROTATION

COUNTERCLOCKWISE ROTATION

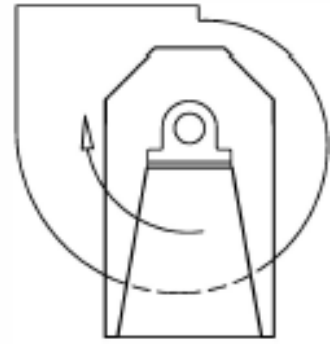

CLOCKWISE
UP BLAST

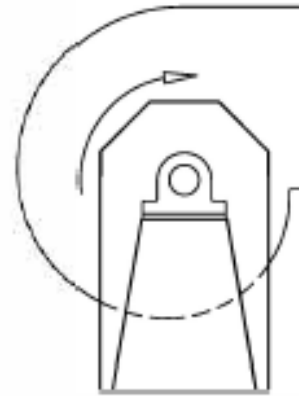

CLOCKWISE
TOP HORIZONTAL

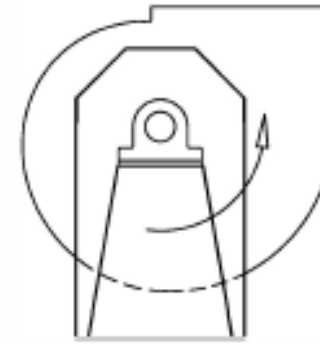

COUNTERCLOCKWISE
UP BLAST

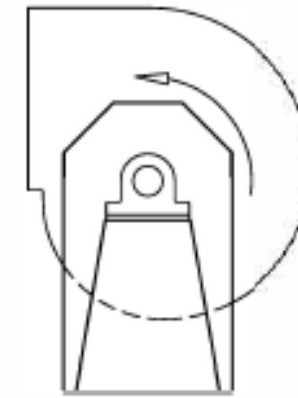

COUNTERCLOCKWISE
TOP HORIZONTAL

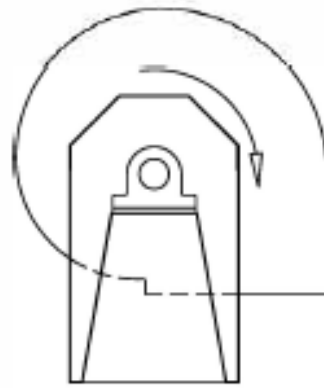

CLOCKWISE
DOWN BLAST



CLOCKWISE
BOTTOM HORIZONTAL

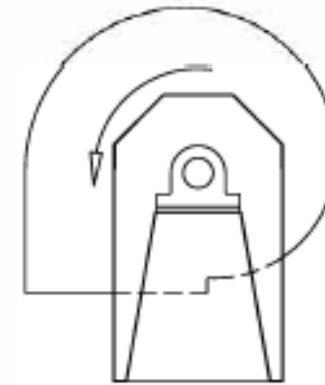

COUNTERCLOCKWISE
DOWN BLAST



COUNTERCLOCKWISE
BOTTOM HORIZONTAL

NOTES:

1. DIRECTION OF ROTATION IS DETERMINED FROM DRIVE SIDE OF FAN.
2. SAME AS AMCA STANDARD 99-2406
3. LEV-CO FANS ARE ASSEMBLED IN CLOCKWISE TOP HORIZONTAL ORIENTATION UNLESS OTHERWISE SPECIFIED

CUSTOMER:
CUSTOMER P.O.:
PROJECT:
ENGINEER:
SALES REP.:
IDENTIFICATION / TAGGING:

> www.lev-co.com • 1.888.862.5356

lev-co

The device depicted and described hereon embodies proprietary information owned by the manufacturer. All design, manufacturing, reproduction, sales and patent rights regarding this device or drawing reserved except where explicit right is guaranteed in writing. We reserve the right to make design changes.

Drawn by: Janos B
Date: 1/12/2015
Scale: NTS
Weight: N/A

**MOVEX
F-FANS**

Specification Drawing

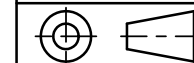

Drawing No.: -
Material: -
File Name: MOVEX-F-FANS-SD

Sheet: 3/3