

**Several configurations to meet customers needs**

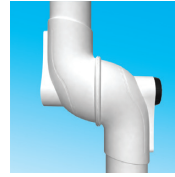

Standard Joints in polypropylene and tubes in aluminum, fit most lab environments.



PP Joints and tubes in polypropylene, used in environments with aggressive contaminants.



ATEX Joints and tubes in conductive polypropylene, used for extraction of contaminants in explosive environments. In compliance with ATEX directive 94/9/EC.



ESD Joints and tubes in conductive polypropylene. E.g. used in the electronics industry, for example. Certified according to EN 61340-5-1.

**Models**

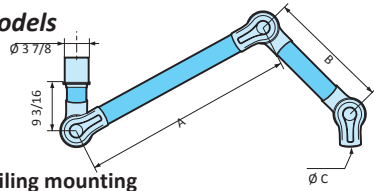

**Ceiling mounting**

Designation	Dimensions (inch)			Weight
Standard	PP	ESD	ATEX	lb
MET 1000-75	PP	ES	EX	5
MET 1300-75	PP	ES	EX	5.7
MET 1500-75	PP	ES	EX	6
MET 2000-75	PP	ES	EX	7.1
*METS 1500-75	PP	ES	EX	6
*METS 2000-75	PP	ES	EX	7.1

**Model with gas spring METS\***

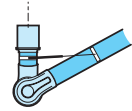

**Table mounting**

Designation	Dimensions (inch)			Weight
Standard	PP	ESD	ATEX	lb
MEB 1000-75	PP	ES	EX	5
MEB 1300-75	PP	ES	EX	5.7
MEB 1500-75	PP	ES	EX	6
MEB 2000-75	PP	ES	EX	7.1

**Hoods**

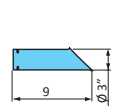

**SUCTION NOZZLE**  
MES 300-75 (PP, ES)

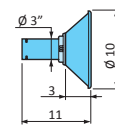

**METAL HOOD**  
MEM 250-75 (ES, EXD) Standard  
MEMB 250-75 With working light



**DOME HOOD**  
MEK 350-75 (PP, ES, EX)

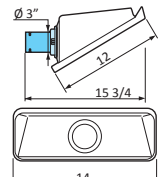

**SQUARE HOOD**  
MESH 350-75 (PP)

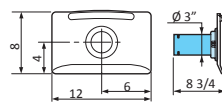

**FLAT SCREEN HOOD**  
MEPH 300-75 (PP, ES, EX)

**Brackets**

All brackets have  $\varnothing 4"$  duct connections.

**Ceiling bracket MTI**

The ceiling bracket can be fitted with sleeves both below and above a false ceiling; in the latter case preferably together with MTI CT. MTI can be supplied in lengths over 80" upon request. For aggressive environments, we recommend the MTI ceiling bracket, supplied with an internal epoxy coating.

Designation for model 75			Length (inch)	Weight (lb)
Standard	ESD	ATEX		
MTI 250	ES	EX	16	7
MTI 500	ES	EX	20	8
MTI 750	ES	EX	30	10
MTI 1000	ES	EX	40	12
MTI 1250	ES	EX	50	13
MTI 1500	ES	EX	60	14
MTI 1750	ES	EX	70	15
MTI 2000	ES	EX	80	17

**Wall bracket MVK**

Designation for model 75			Weight (lb)
Standard	ESD	ATEX	
MVK	ES	EX	5

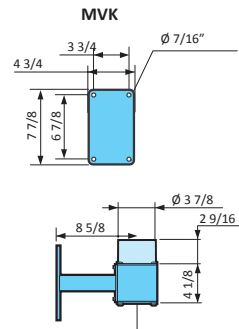
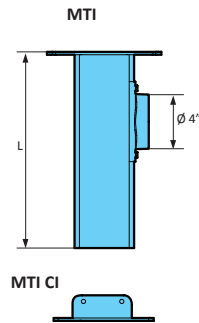
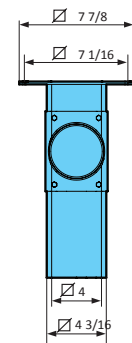

**Reach at recommended installation height**

The following installation heights and lateral placements in relation to the work space are recommended for optimised extraction.

**Recommended installation height**

Designation	H inch
MET 1000-75	67-78
MET 1300-75	75-86
MET 1500-75	78-91
MET 2000-75	86-98

**Recommended side displacement**

in relation to the workarea

Designation	S inch
MET 1000-75	12-24
MET 1300-75	16-28
MET 1500-75	20-32
MET 2000-75	28-40

**Recommended values**

Function	Airflow	
Laboratories	40 l/s	88 cfm
Schools - Science classrooms	40 l/s	88 cfm

**Material description**

**Friction joints**

Ball-bearing-equipped adjustable friction joints in polypropylene (PP) with guide ring of low-friction treated rubber.

Support springs and other component parts in zinc-plated steel or stainless steel.

**Tubes**

Made from thin-wall anodized aluminum, alternatively from polypropylene. Air-tight damper supplied as standard.

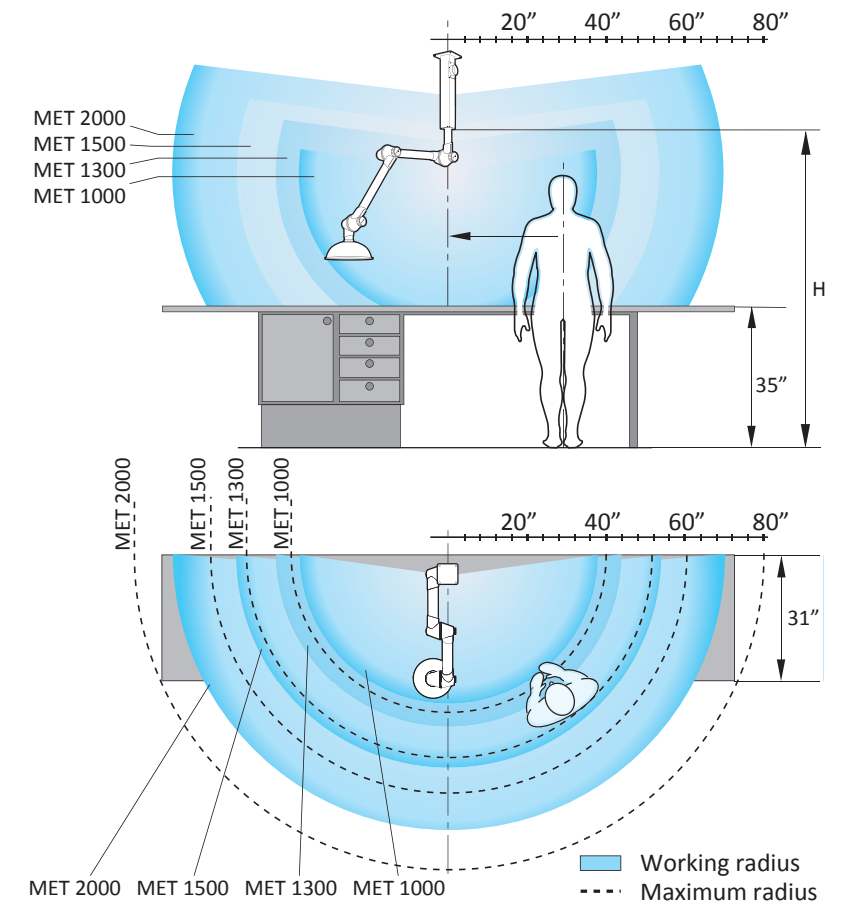

**Delivery**

**Ceiling** - Supplied assembled excluding hood or nozzle. MTI or MTF ceiling bracket ordered separately.

**Wall** - assembled, complete with MVK wall bracket, excluding hood or nozzle.

**Table** - assembled, with mounting plate for table mounting, excluding hood or nozzle. Flexible table bracket MBF ordered separately.

CUSTOMER:  
CUSTOMER P.O.:  
PROJECT:  
ENGINEER:  
SALES REP.:  
IDENTIFICATION / TAGGING:

> [www.lev-co.com](http://www.lev-co.com) • 1.888.862.5356

**lev-co**

The device depicted and described hereon embodies proprietary information owned by the manufacturer. All design, manufacturing, reproduction, sales and patent rights regarding this device or drawing reserved except where explicit right is guaranteed in writing. We reserve the right to make design changes.

Drawn by: Janos B  
Date: 1/14/2015  
Scale: NTS  
Weight: N/A

**MOVEX ME**

Specification Drawing

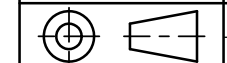

Drawing No.: -  
Material: -  
File Name: MOVEX-ME-SD  
Sheet: 1/1