

P-147 TO P-154

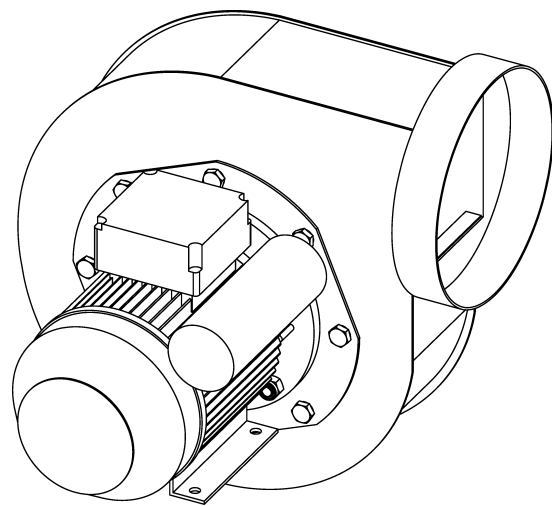

P-155 & P-156 & P-156-HF

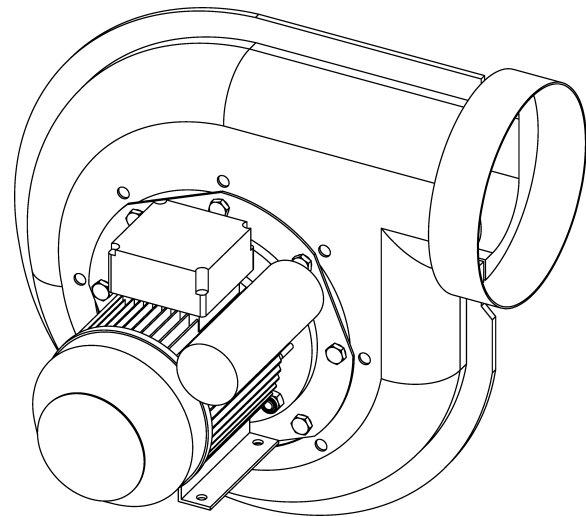

P-MAX Fans Pressure Curves

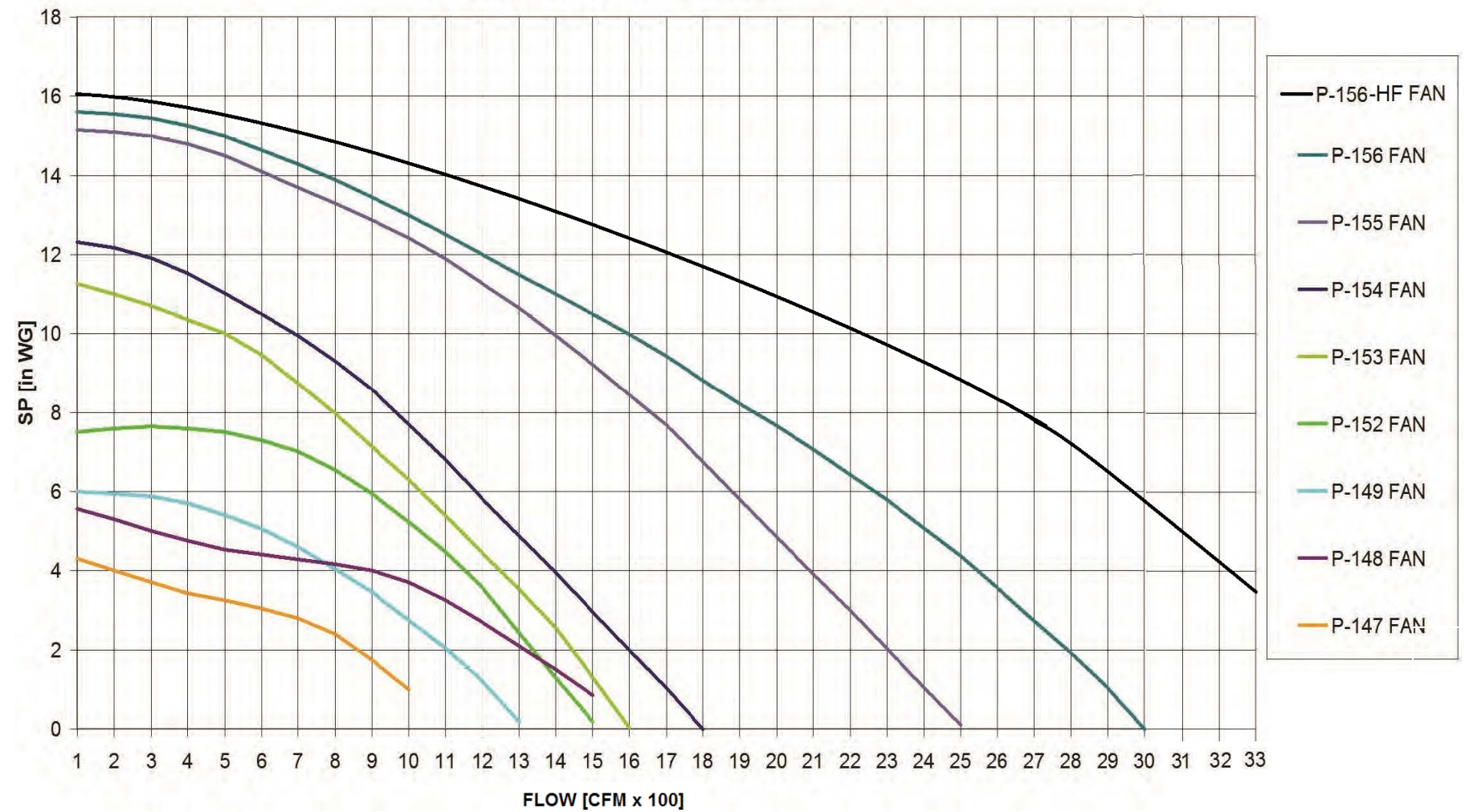

! NB: all Lev-Co P-max fans come in a standard configuration of Clockwise rotation / Top horizontal discharge. For alternate discharges, please indicate on your purchase order and approved submittal drawings. Alternate rotation is not available.

| FAN MODEL | L1 | L2 | ØD | W | Weight [lbs] |
|-----------|---------|-----------|----|--------|--------------|
| P-147 | 16" | 16" | 8" | 4 1/4" | 28 |
| P-148 | 16" | 16" | 8" | 4 1/4" | 29 |
| P-149 | 16" | 16" | 8" | 4 1/4" | 36 |
| P-152 | 16" | 16" | 8" | 4 1/4" | 38 |
| P-153 | 18 1/4" | 19 1/8" | 8" | 4 1/4" | 47 |
| P-154 | 18 1/4" | 19 1/8" | 8" | 4 1/4" | 49 |
| P-155 | 25 1/4" | 22" | 8" | 6" | 73 |
| P-156 | 25 1/4" | 22" | 8" | 6" | 79 |
| P-156-HF | 24" | 23 21/32" | 8" | 8 3/4" | 180 |

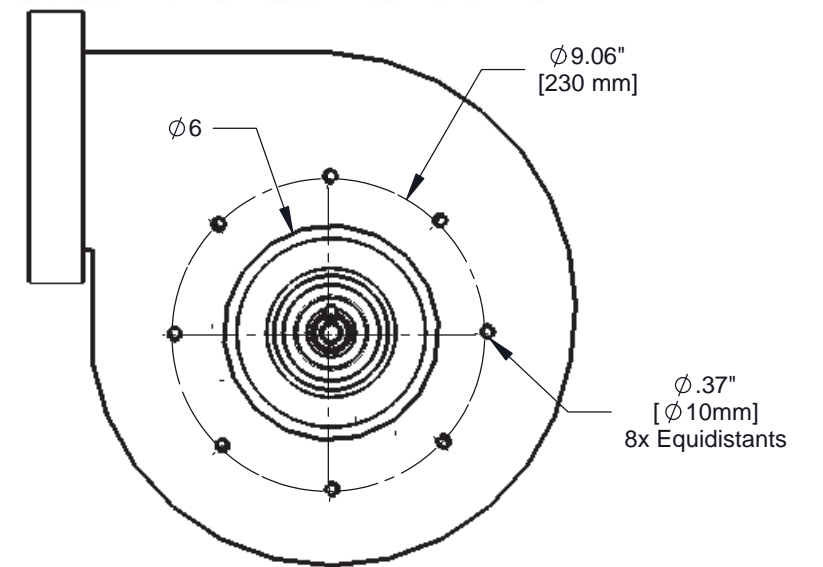
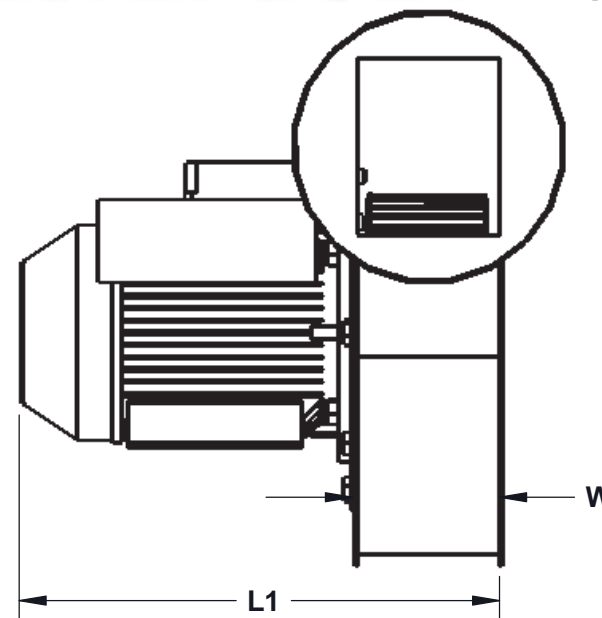
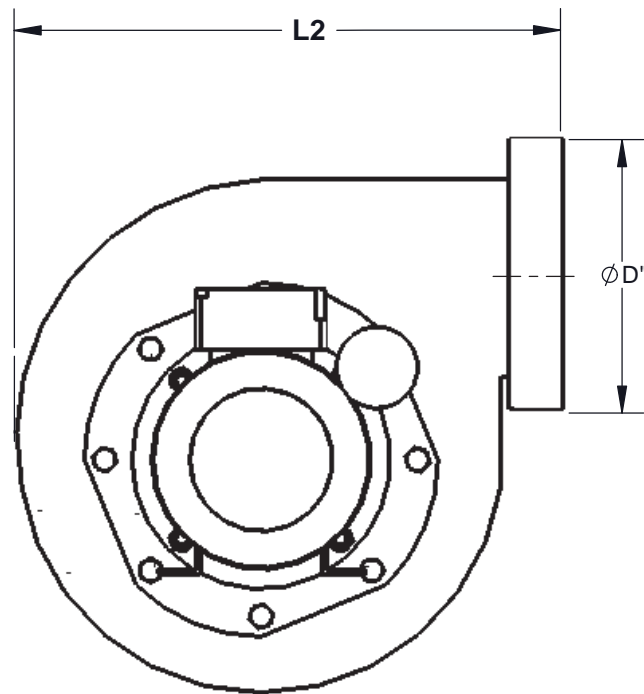

13-03

CUSTOMER:
 CUSTOMER P.O.:
 PROJECT:
 ENGINEER:
 SALES REP.:
 IDENTIFICATION / TAGGING:

> www.lev-co.com • 1.888.862.5356

lev-co

The device depicted and described hereon embodies proprietary information owned by the manufacturer. All design, manufacturing, reproduction, sales and patent rights regarding this device or drawing reserved except where explicit right is guaranteed in writing. We reserve the right to make design changes.

Drawn by: JANOS B
 Date: 6/23/2015
 Scale: NTS
 Weight: N/A

13-03 P-MAX
Direct Drive Fan
 Specification Drawing

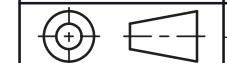

Drawing No.: -
 Material: -
 File Name: (13-03) P-Max Fan - SD
 Sheet: 1/10

ULTRA LOW NOISE FAN

- P-147-55dBA-1 ULTRA LOW NOISE P-MAX Fan 115V/1/60 0.5HP
- P-147-55dBA-2 ULTRA LOW NOISE P-MAX Fan 208-230V/1/60 0.5HP
- P-147-55dBA-3 ULTRA LOW NOISE P-MAX Fan 230-460V/3/60 0.5HP
- P-147-55dBA-4 ULTRA LOW NOISE P-MAX Fan 575V/3/60 0.5HP
- P-148-55dBA-1 ULTRA LOW NOISE P-MAX Fan 115V/1/60 1HP
- P-148-55dBA-2 ULTRA LOW NOISE P-MAX Fan 208-230V/1/60 1HP
- P-148-55dBA-3 ULTRA LOW NOISE P-MAX Fan 230-460V/3/60 1HP
- P-148-55dBA-4 ULTRA LOW NOISE P-MAX Fan 575V/3/60 1HP
- P-149-55dBA-1 ULTRA LOW NOISE P-MAX Fan 115V/1/60 1HP
- P-149-55dBA-2 ULTRA LOW NOISE P-MAX Fan 208-230V/1/60 1HP
- P-149-55dBA-3 ULTRA LOW NOISE P-MAX Fan 230-460V/3/60 1HP
- P-149-55dBA-4 ULTRA LOW NOISE P-MAX Fan 575V/3/60 1HP
- P-152-55dBA-1 ULTRA LOW NOISE P-MAX Fan 115V/1/60 1.5HP
- P-152-55dBA-2 ULTRA LOW NOISE P-MAX Fan 230-460V/3/60 1.5HP
- P-152-55dBA-3 ULTRA LOW NOISE P-MAX Fan 575V/3/60 1.5HP

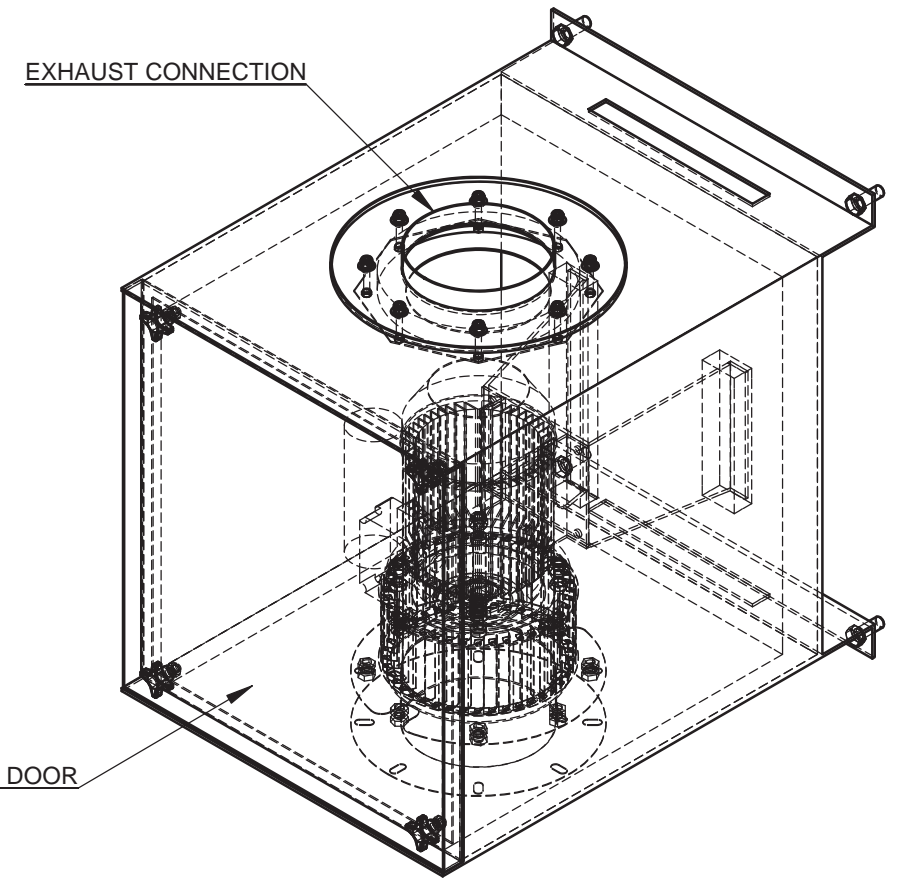
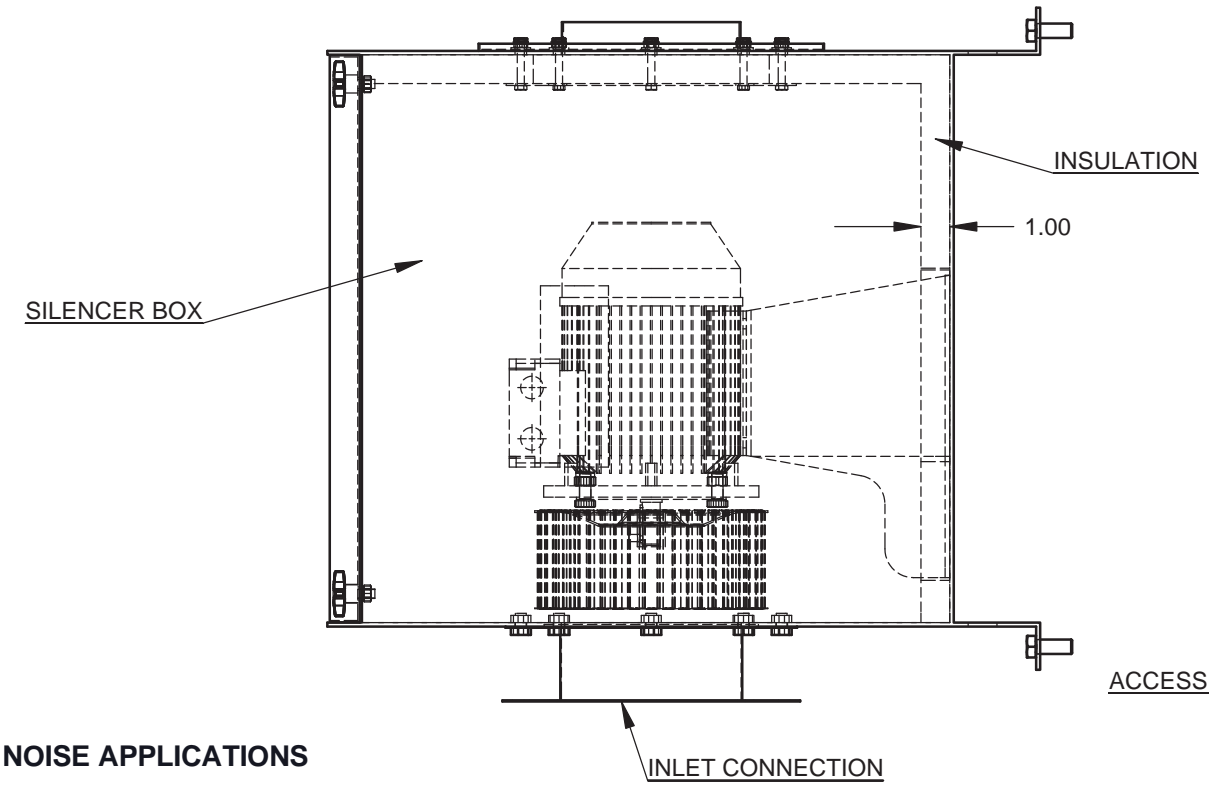
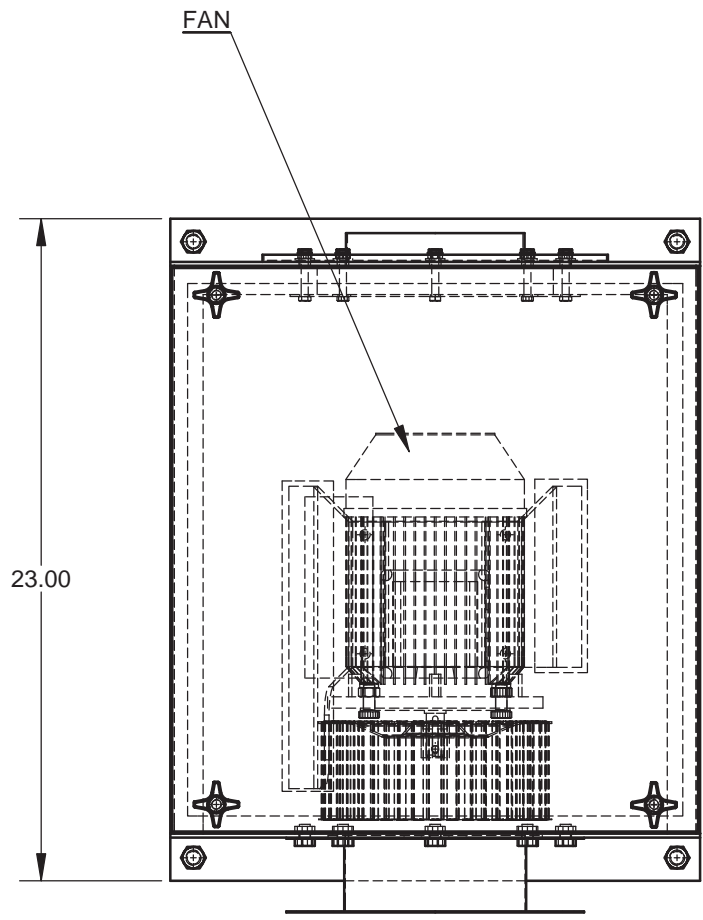
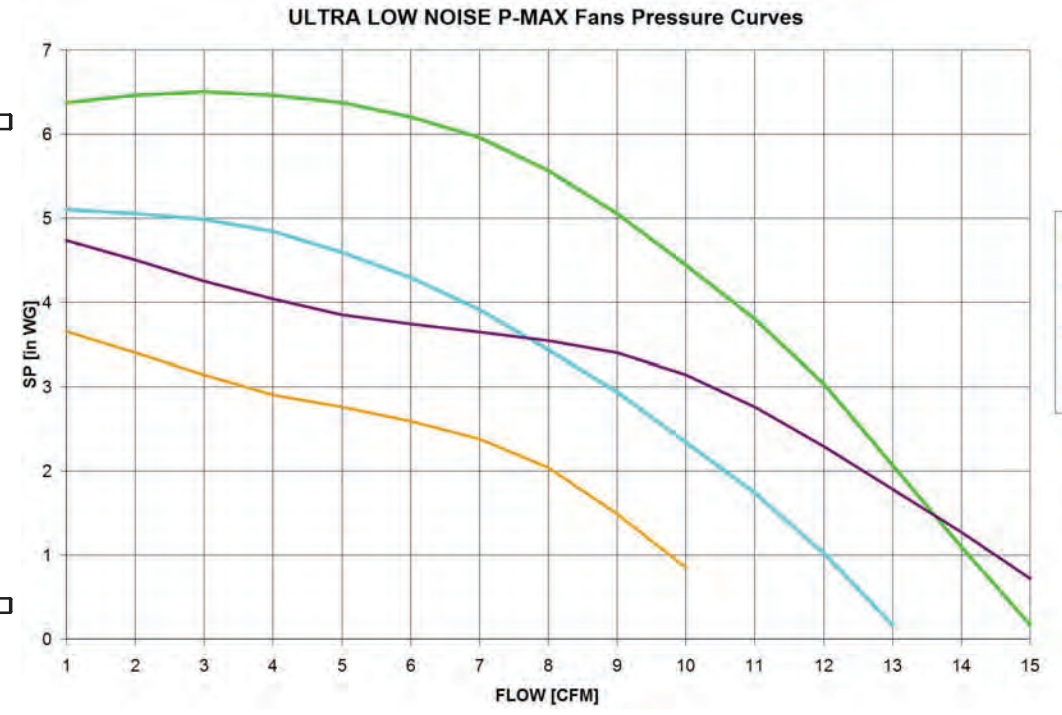
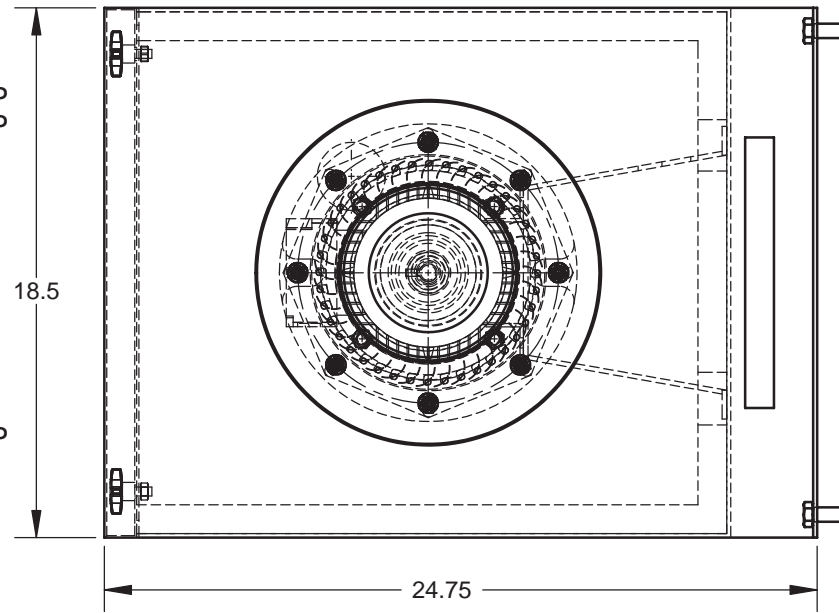

SOUND ATTENUATING CONSTRUCTION FOR ULTRA LOW NOISE APPLICATIONS

13-03

| | |
|---------------------------|--|
| CUSTOMER: | |
| CUSTOMER P.O.: | |
| PROJECT: | |
| ENGINEER: | |
| SALES REP.: | |
| IDENTIFICATION / TAGGING: | |

www.lev-co.com • 1.888.862.5356



The device depicted and described hereon embodies proprietary information owned by the manufacturer. All design, manufacturing, reproduction, sales and patent rights regarding this device or drawing reserved except where explicit right is guaranteed in writing. We reserve the right to make design changes.

| | |
|-----------|-----------|
| Drawn by: | JANOS B |
| Date: | 6/23/2015 |
| Scale: | NTS |
| Weight: | N/A |

| | |
|-------------------------------------|------------------------|
| 13-03 P-MAX Direct Drive Fan | |
| Specification Drawing | |
| Drawing No.: | - |
| File Name: | (13-03) P-Max Fan - SD |
| Material: | - |
| Sheet: | 2/10 |

P-MAX FAN WITH SIL-8 SILENCER AND EXHAUST DUCT KIT (PDK-8) OPTION

SIL-8 SILENCER OPTION

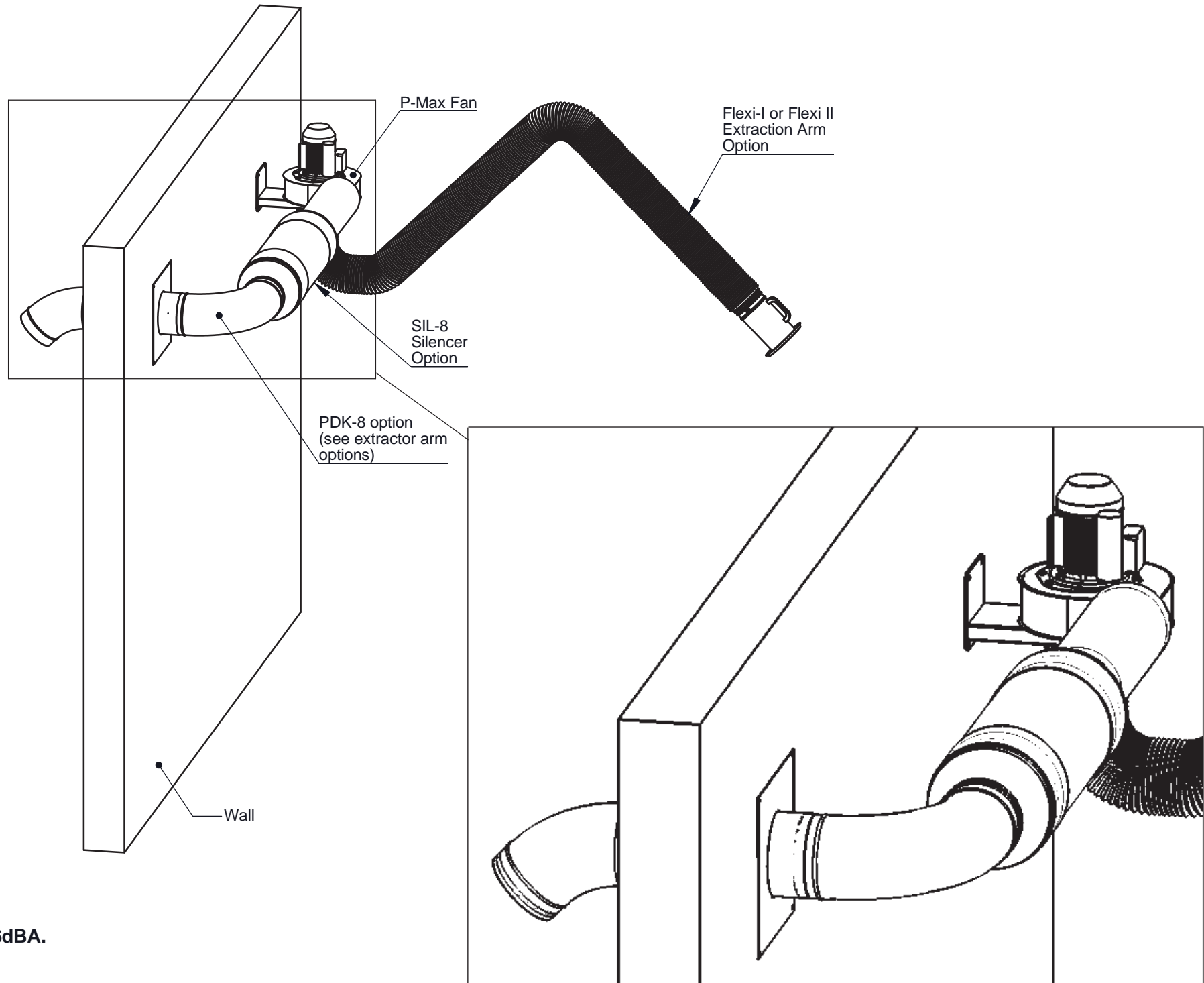
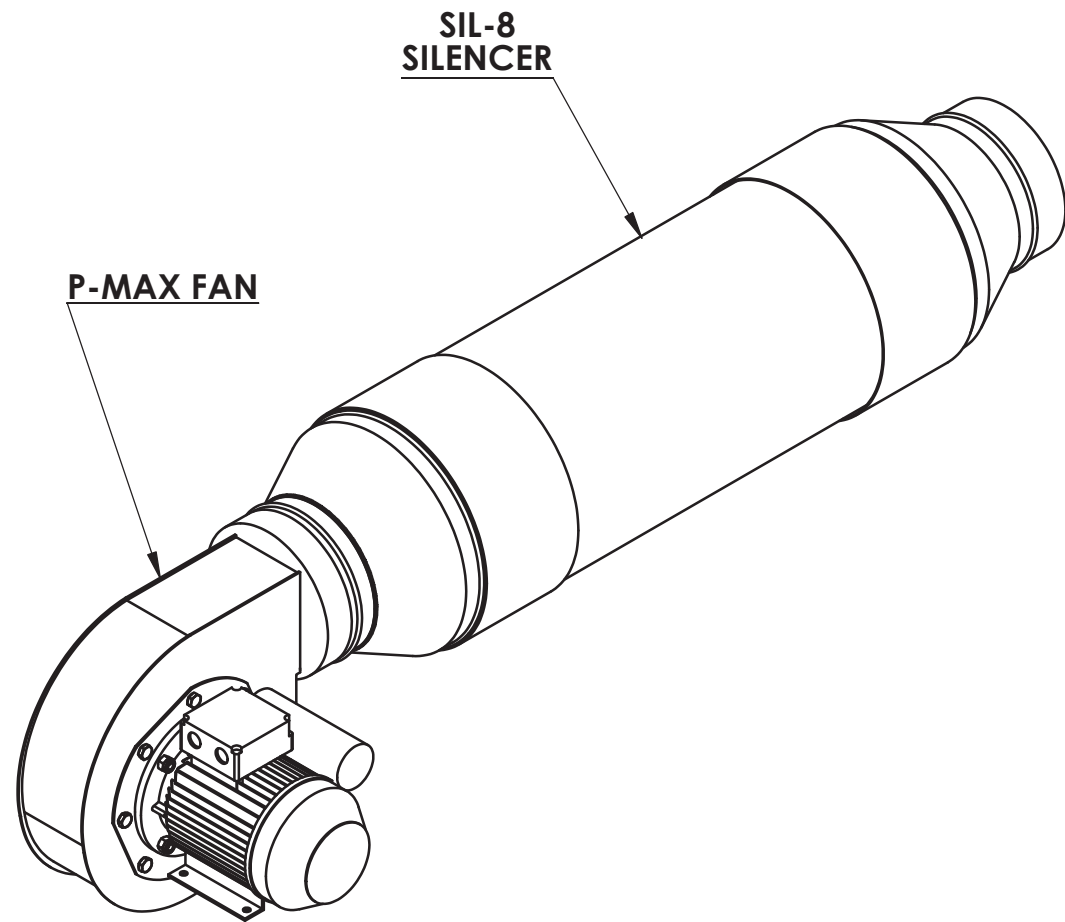

IMPORTANT!

- THE SIL-8 SILENCER OPTION REDUCES THE NOISE LEVEL WITH AN AVERAGE OF 6dBA.

13-03

| |
|---------------------------|
| CUSTOMER: |
| CUSTOMER P.O.: |
| PROJECT: |
| ENGINEER: |
| SALES REP.: |
| IDENTIFICATION / TAGGING: |

> www.lev-co.com • 1.888.862.5356

lev-co

The device depicted and described hereon embodies proprietary information owned by the manufacturer. All design, manufacturing, reproduction, sales and patent rights regarding this device or drawing reserved except where explicit right is guaranteed in writing. We reserve the right to make design changes.

| | |
|-----------|-----------|
| Drawn by: | JANOS B |
| Date: | 6/23/2015 |
| Scale: | NTS |
| Weight: | N/A |

**13-03 P-MAX
Direct Drive Fan
Specification Drawing**

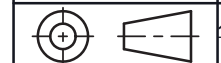

| | | | |
|--------------|---|------------|------------------------|
| Drawing No.: | - | File Name: | (13-03) P-Max Fan - SD |
| Material: | - | Sheet: | 3/10 |

AVAILABLE SILENCER OPTIONS AND PARAMETERS:

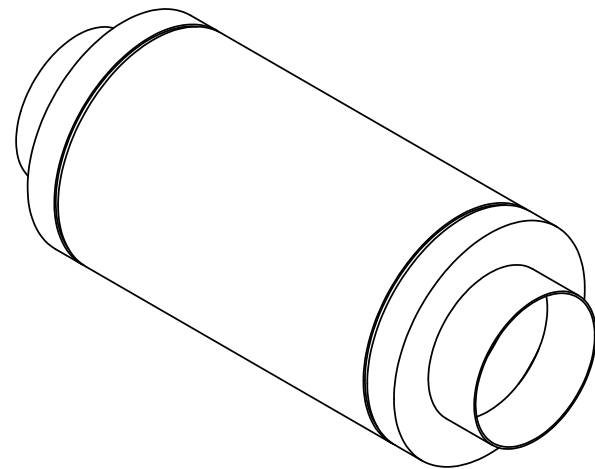
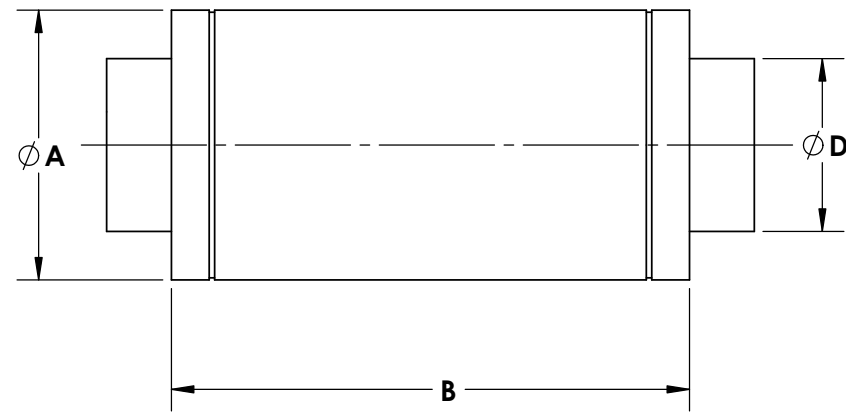

MODEL: SIL-X Silencers

SIL-X Silencers are designed to reduce fan noise from traveling along ventilation ducts. These silencers may be used in either supply or exhaust ducts, and are available in 4, 6, 8, 10, 12.4, and 16" diameters.

SOUND SUPPRESSION BY OCTAVE BAND (dB)

| MODEL | 125 Hz | 250 Hz | 500 Hz | 1000 Hz | 2000 Hz | 4000 Hz | 8000 Hz |
|----------|--------|--------|--------|---------|---------|---------|---------|
| SIL-4 | 8 | 14 | 26 | 34 | 41 | 45 | 25 |
| SIL-6 | 5 | 10 | 18 | 23 | 33 | 30 | 19 |
| SIL-8 | 4 | 9 | 17 | 22 | 29 | 25 | 18 |
| SIL-10 | 6 | 11 | 21 | 27 | 39 | 25 | 19 |
| SIL-12.4 | 5 | 9 | 18 | 23 | 32 | 20 | 18 |
| SIL-16 | 5 | 8 | 11 | 23 | 19 | 17 | 15 |

AVAILABLE MODELS AND DIMENSIONS:

| MODEL | A | B | D* | SHIPPING WEIGHT [lbs] |
|----------|------|------|------|-----------------------|
| SIL-4 | 8.0 | 23.6 | 4.0 | 13 |
| SIL-6 | 10.2 | 23.6 | 6.0 | 17 |
| SIL-8 | 12.5 | 23.6 | 8.0 | 20 |
| SIL-10 | 14.0 | 35.5 | 10.0 | 35 |
| SIL-12.4 | 17.7 | 35.5 | 12.4 | 56 |
| SIL-16 | 25.0 | 35.5 | 16.0 | 90 |

* - Duct dimensions are 1/8" smaller than duct size.

CUSTOMER:
 CUSTOMER P.O.:
 PROJECT:
 ENGINEER:
 SALES REP.:
 IDENTIFICATION / TAGGING:

> www.lev-co.com • 1.888.862.5356



The device depicted and described hereon embodies proprietary information owned by the manufacturer. All design, manufacturing, reproduction, sales and patent rights regarding this device or drawing reserved except where explicit right is guaranteed in writing. We reserve the right to make design changes.

Drawn by: Janos
 Date: 12/10/2015
 Scale: NTS
 Weight: N/A

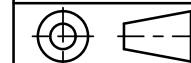

**13-03 P-MAX
 Direct Drive Fan
 Specification Drawing**

Drawing No.: -
 Material: -
 File Name: SIL-X
 Sheet: 4/10

P-MAX FAN WITH EXHAUST DUCT KIT (PDK-8) OPTION

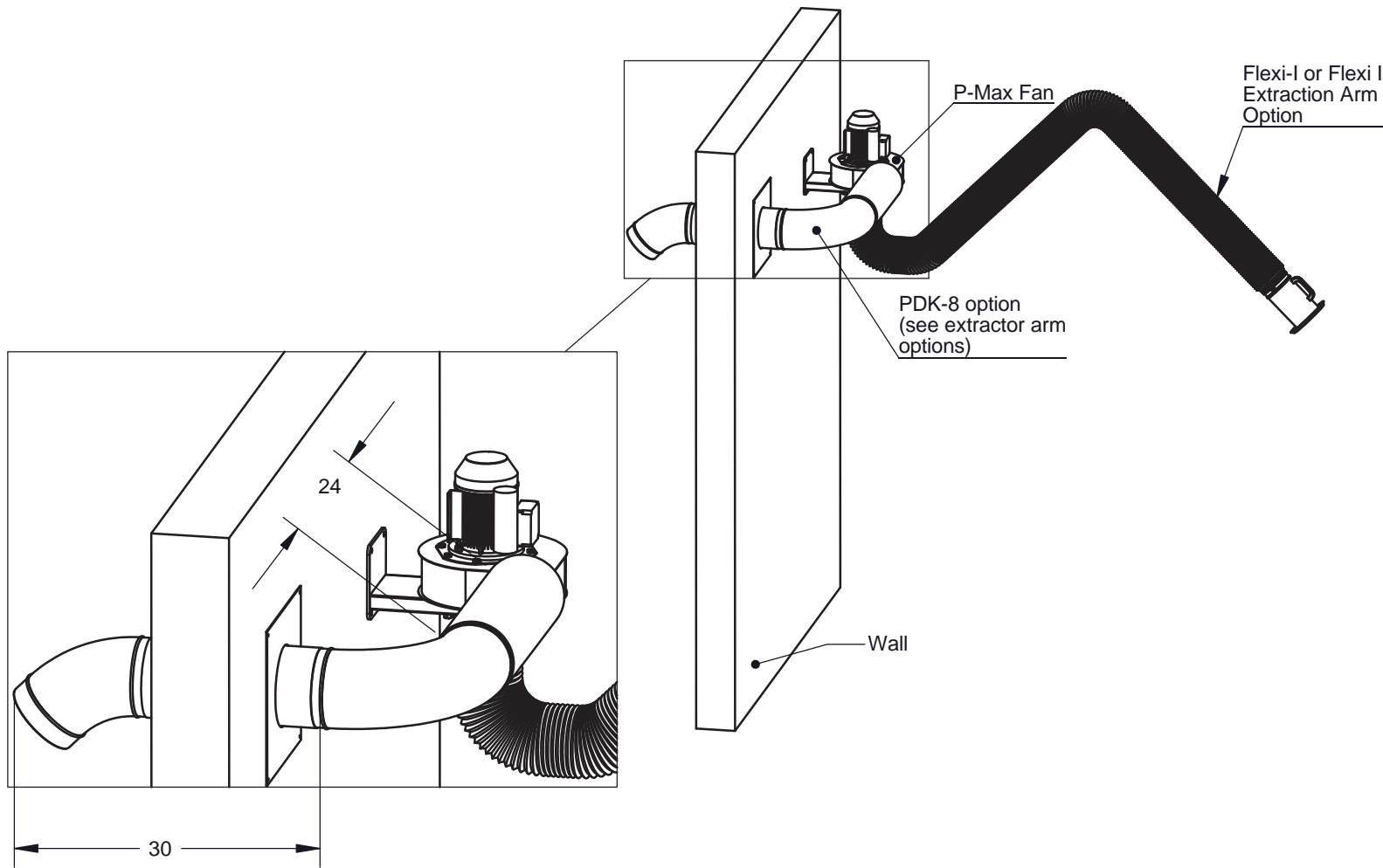

P-MAX FAN WITH EXHAUST DUCT KIT AND NO LOSS STACK (PDK-8-NLS) OPTION

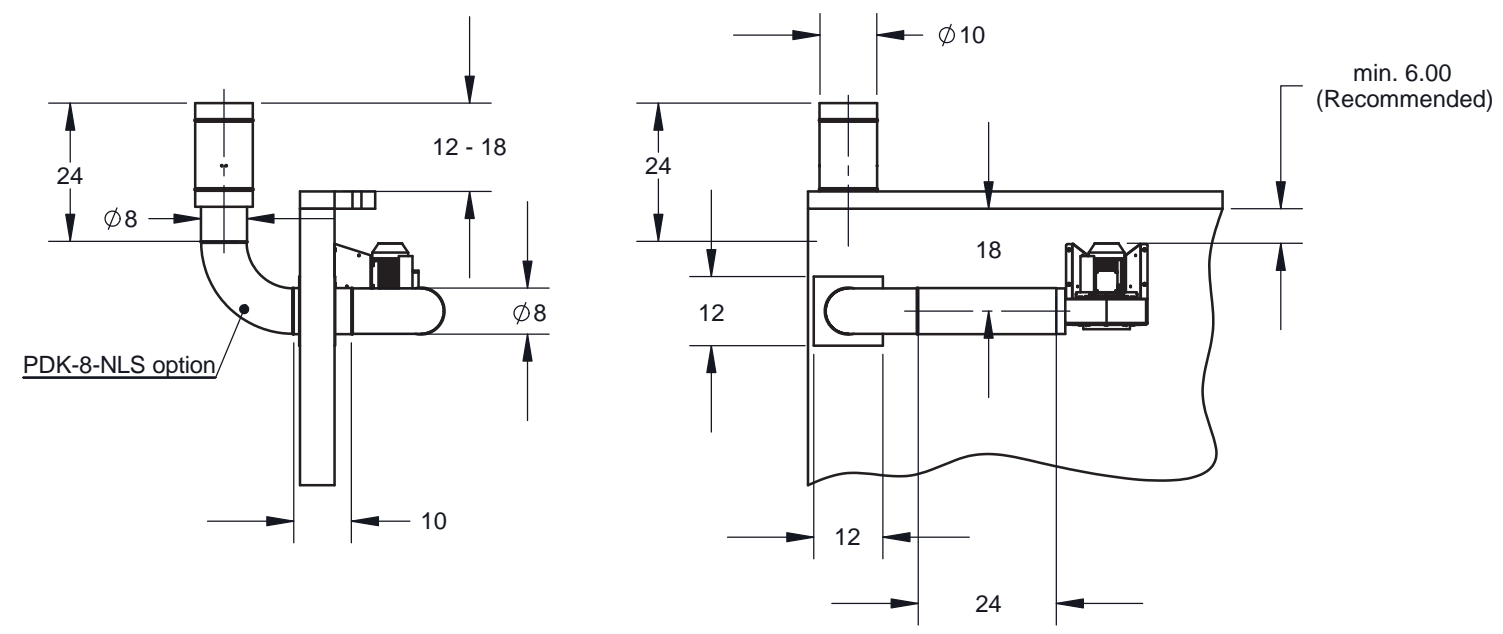

NO LOSS STACK WITH BACKDRAFT DAMPER

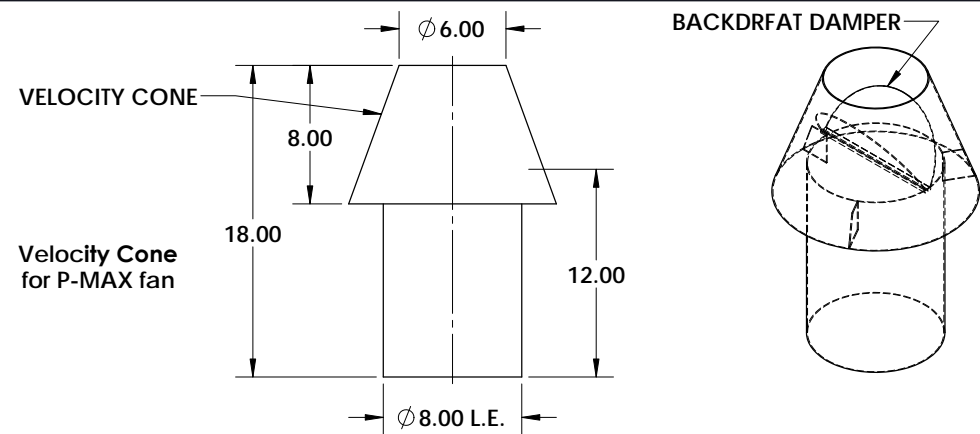
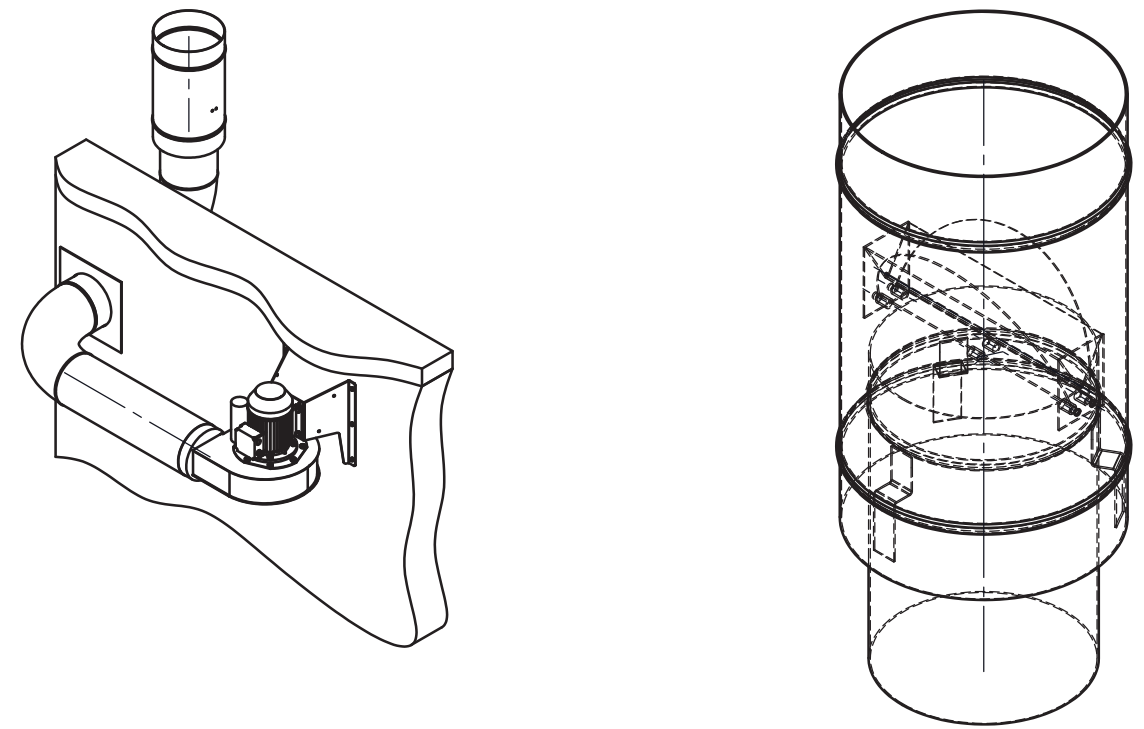

RAIN-CAP

Velocity Cone for P-MAX fan

13-03

| | |
|---------------------------|--|
| CUSTOMER: | |
| CUSTOMER P.O.: | |
| PROJECT: | |
| ENGINEER: | |
| SALES REP.: | |
| IDENTIFICATION / TAGGING: | |

www.lev-co.com • 1.888.862.5356



The device depicted and described hereon embodies proprietary information owned by the manufacturer. All design, manufacturing, reproduction, sales and patent rights regarding this device or drawing reserved except where explicit right is guaranteed in writing. We reserve the right to make design changes.

| | |
|-----------|-----------|
| Drawn by: | JANOS B |
| Date: | 6/23/2015 |
| Scale: | NTS |
| Weight: | N/A |

| | |
|-------------------------------------|------------------------|
| 13-03 P-MAX Direct Drive Fan | |
| Specification Drawing | |
| Drawing No.: | - |
| File Name: | (13-03) P-Max Fan - SD |
| Material: | - |
| Sheet: | 5/10 |

SOUND LEVEL CHARTS

1 HP MOTOR

2 HP MOTOR

3 HP MOTOR

SOUND PRESSURE LEVEL

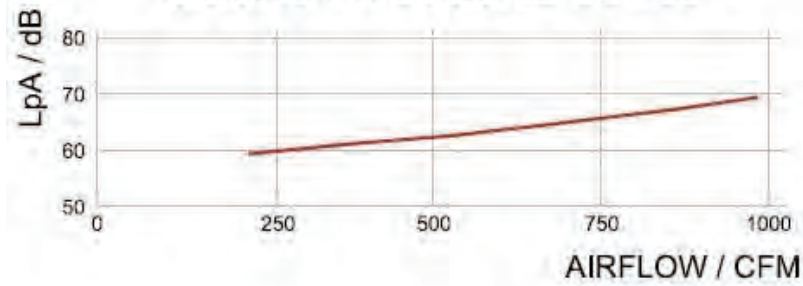

SOUND PRESSURE LEVEL

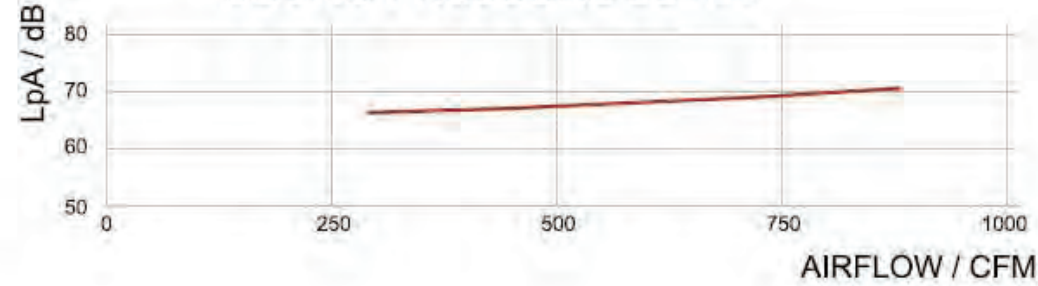

SOUND PRESSURE LEVEL

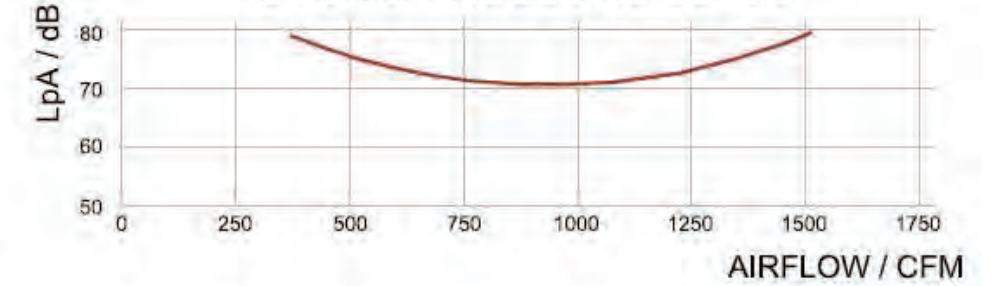

SOUND POWER LEVEL

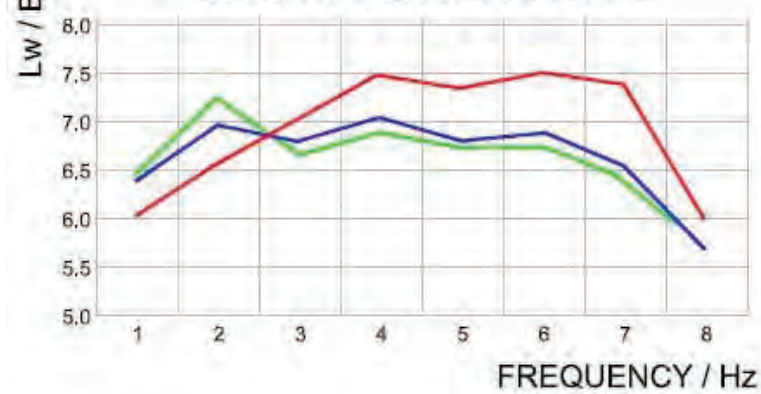

SOUND POWER LEVEL

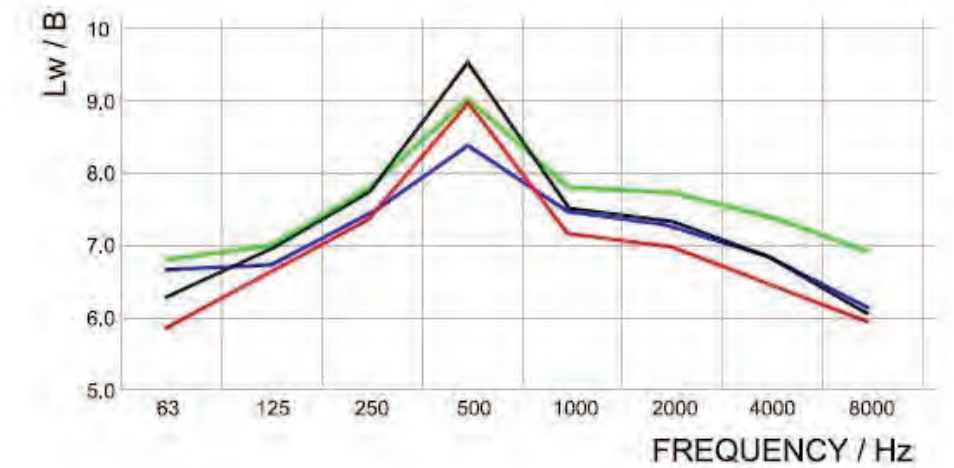
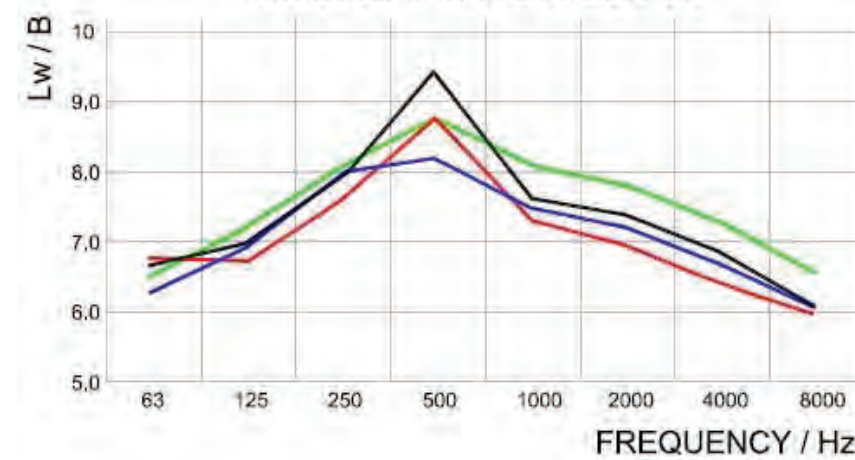

- 300 CFM
- 550 CFM
- 875 CFM

- 1225 CFM
- 875 CFM
- 575 CFM
- 287 CFM

- 1400 CFM
- 1100 CFM
- 750 CFM
- 425 CFM

13-03

| |
|---------------------------|
| CUSTOMER: |
| CUSTOMER P.O.: |
| PROJECT: |
| ENGINEER: |
| SALES REP.: |
| IDENTIFICATION / TAGGING: |

> www.lev-co.com • 1.888.862.5356

lev-co

The device depicted and described hereon embodies proprietary information owned by the manufacturer. All design, manufacturing, reproduction, sales and patent rights regarding this device or drawing reserved except where explicit right is guaranteed in writing. We reserve the right to make design changes.

| | |
|-----------|-----------|
| Drawn by: | JANOS B |
| Date: | 6/23/2015 |
| Scale: | NTS |
| Weight: | N/A |

**13-03 P-MAX
Direct Drive Fan**
Specification Drawing

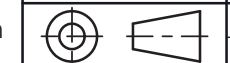

| | | | |
|--------------|---|------------|------------------------|
| Drawing No.: | - | File Name: | (13-03) P-Max Fan - SD |
| Material: | - | Sheet: | 6/10 |

MOTOR AMPERAGES

| | 0.75 HP | 1 HP | 1.5 HP | 2 HP | 3 HP | 5 HP | 7.5 HP | 10 HP |
|-----------------------|---------|--------|--------|--------|--------|--------|--------|--------|
| 110-120 V / 1 / 60 Hz | 9 A | 12.4 A | 17.4 A | | | | | |
| 220-240 V / 1 / 60 Hz | 4.5 A | 6.2 A | 8.7 A | 10.8 A | 15.2 A | 24.4 A | | |
| 220-240 V / 3 / 60 Hz | 2.4 A | 3.2 A | 4.6 A | 5.4 A | 7.6 A | 12.2 A | 18 A | 23.6 A |
| 440-480 V / 3 / 60 Hz | 1.2 A | 1.6 A | 2.3 A | 2.8 A | 3.8 A | 6.1 A | 9.0 A | 11.8 A |
| 575 V / 3 / 60 Hz | 1 A | 1.3 A | 1.7 A | 2.2 A | 3.0 A | 4.9 A | 7.2 A | 9.4 A |

OPTIONAL MOTOR MOUNTING BRACKETS

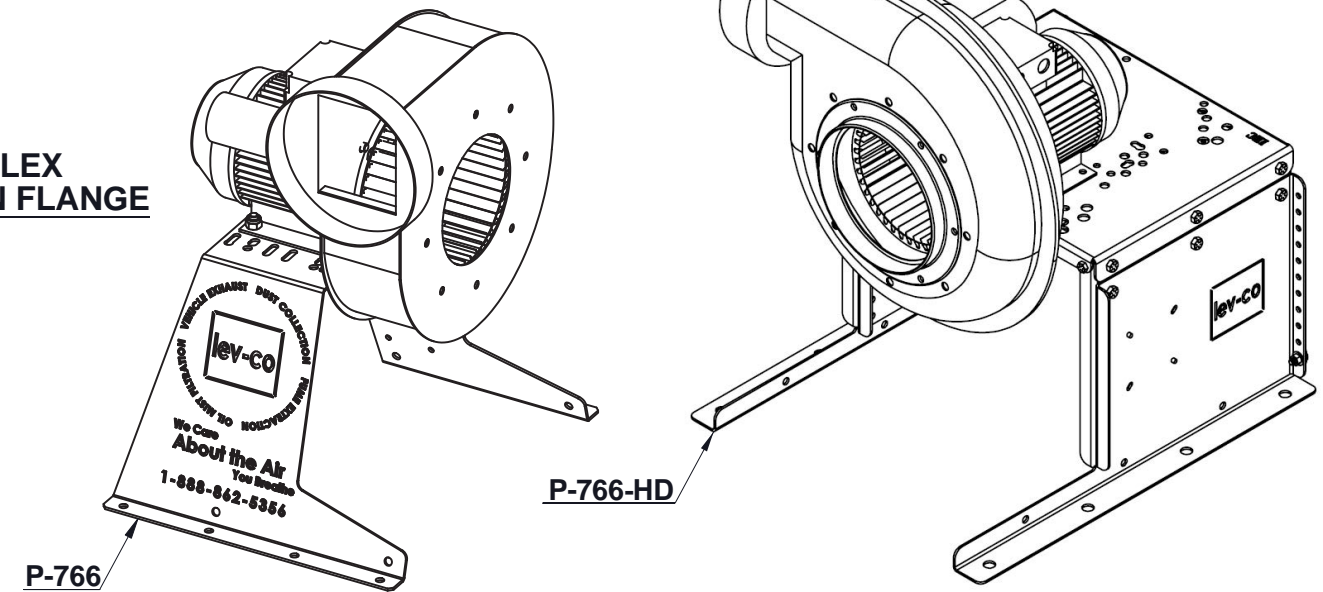
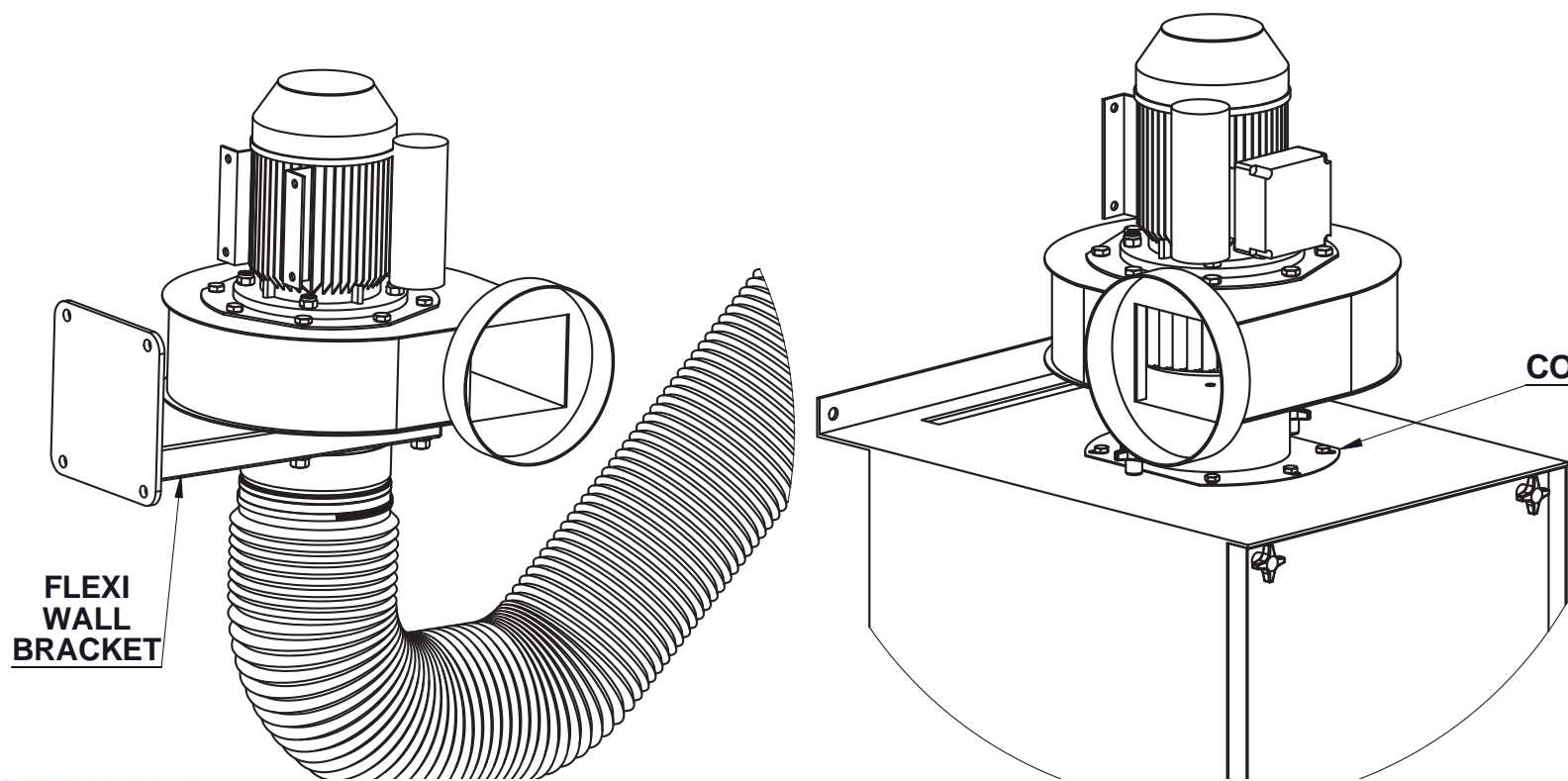
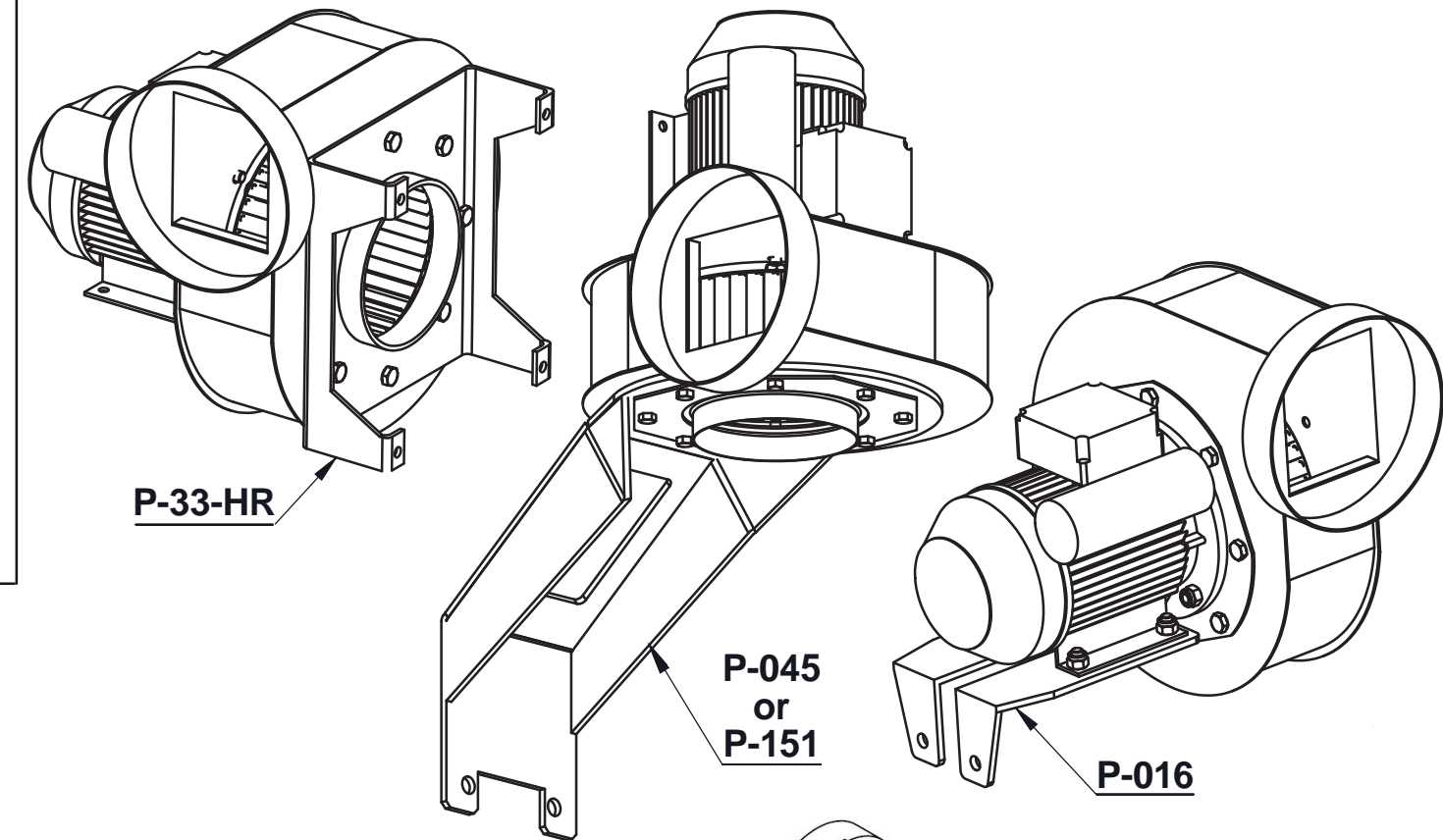

13-03

CUSTOMER:
 CUSTOMER P.O.:
 PROJECT:
 ENGINEER:
 SALES REP.:
 IDENTIFICATION / TAGGING:

> www.lev-co.com • 1.888.862.5356

lev-co

The device depicted and described hereon embodies proprietary information owned by the manufacturer. All design, manufacturing, reproduction, sales and patent rights regarding this device or drawing reserved except where explicit right is guaranteed in writing. We reserve the right to make design changes.

Drawn by: JANOS B
 Date: 6/23/2015
 Scale: NTS
 Weight: N/A

13-03 P-MAX
Direct Drive Fan
 Specification Drawing

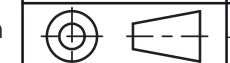

Drawing No.: -
 Material: -
 File Name: (13-03) P-Max Fan - SD
 Sheet: 7/10

MOUNTING HOLE PATTERNS

P-766

P-766-HD

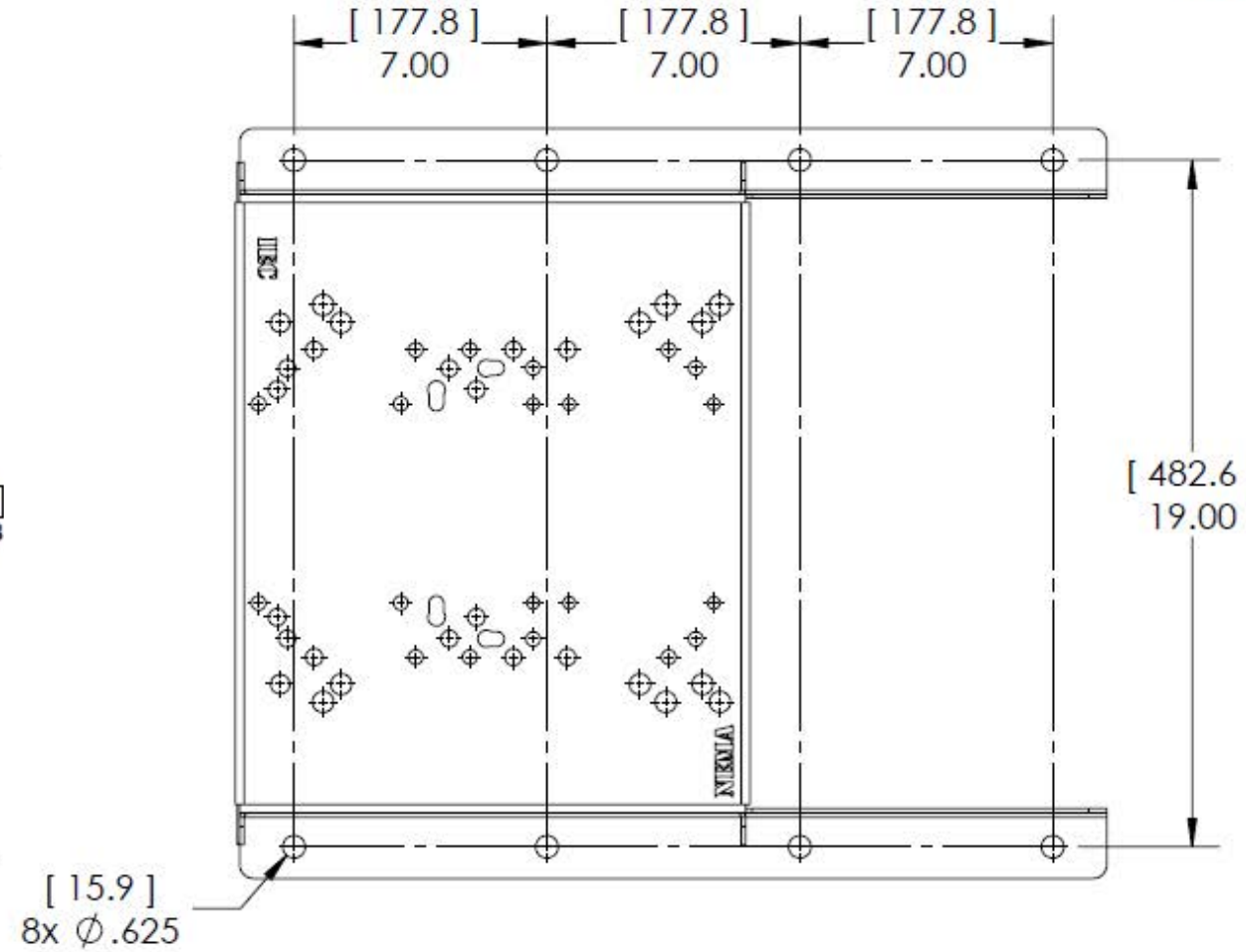
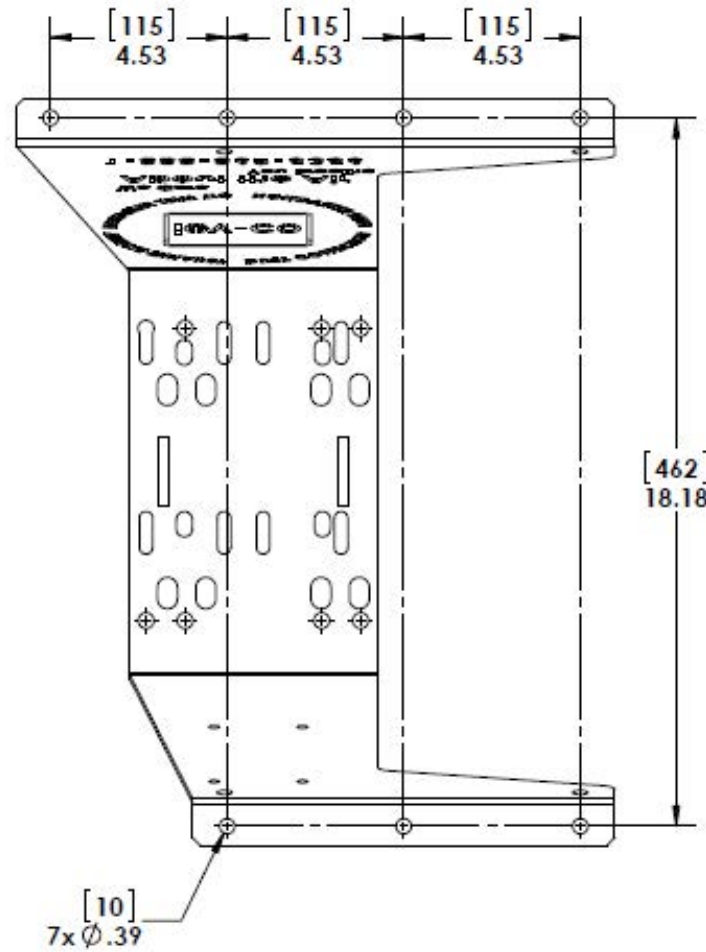

Note:
Adjustable height
between 14.1" [358.6mm]
and 24.12" [612.6mm]

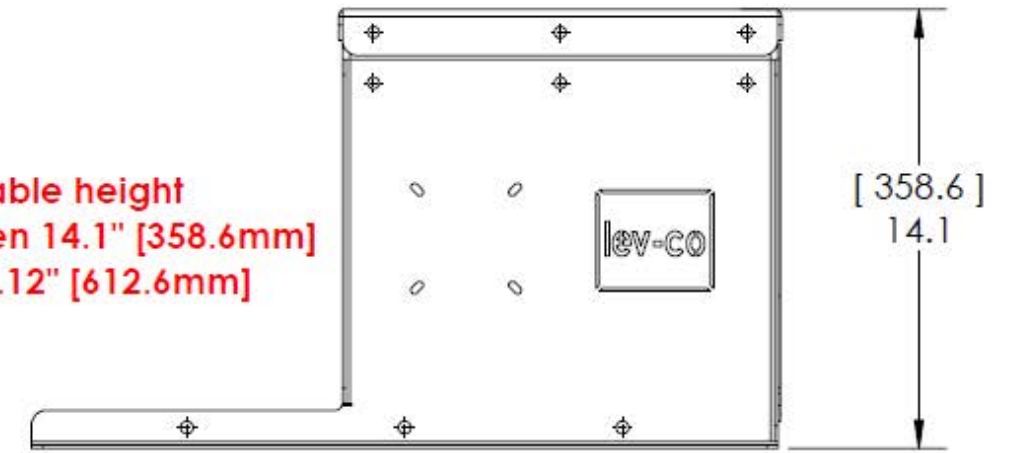

INITIAL POSITION

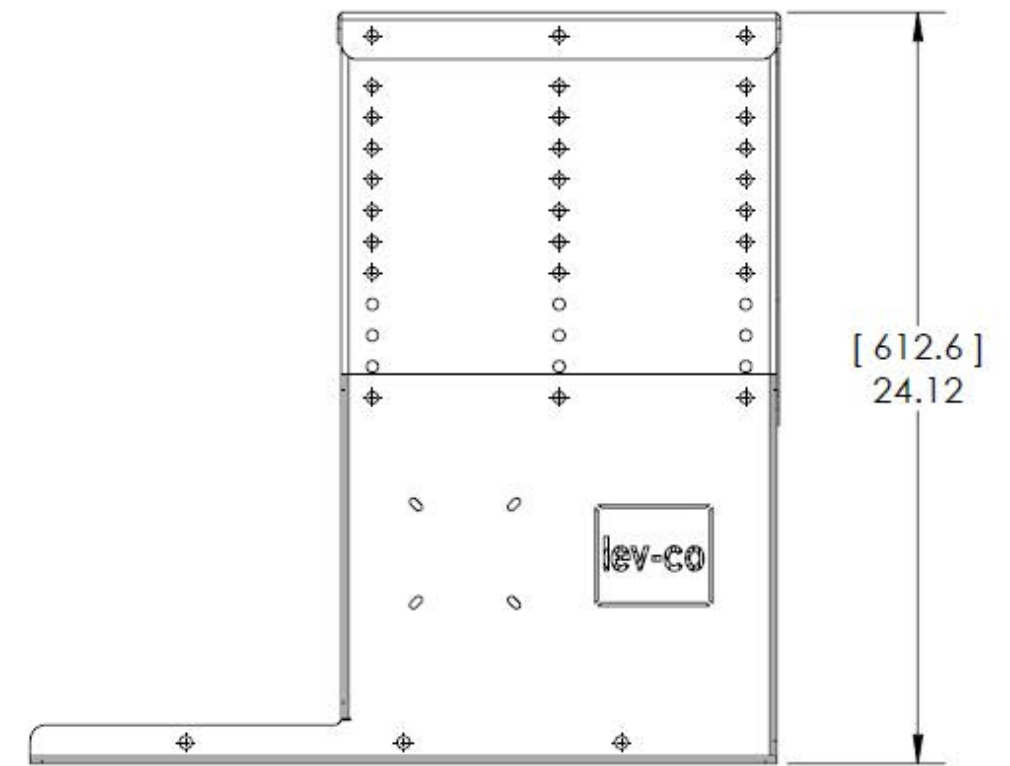

ALTERNATE POSITION

13-03

| |
|---------------------------|
| CUSTOMER: |
| CUSTOMER P.O.: |
| PROJECT: |
| ENGINEER: |
| SALES REP.: |
| IDENTIFICATION / TAGGING: |

> www.lev-co.com • 1.888.862.5356

lev-co

The device depicted and described hereon embodies proprietary information owned by the manufacturer. All design, manufacturing, reproduction, sales and patent rights regarding this device or drawing reserved except where explicit right is guaranteed in writing. We reserve the right to make design changes.

| | |
|-----------|-----------|
| Drawn by: | JANOS B |
| Date: | 6/23/2015 |
| Scale: | NTS |
| Weight: | N/A |

**13-03 P-MAX
Direct Drive Fan**
Specification Drawing

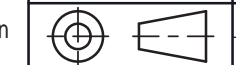

| | | | |
|--------------|---|------------|------------------------|
| Drawing No.: | - | File Name: | (13-03) P-Max Fan - SD |
| Material: | - | Sheet: | 8/10 |

CLOCKWISE ROTATION

COUNTERCLOCKWISE ROTATION

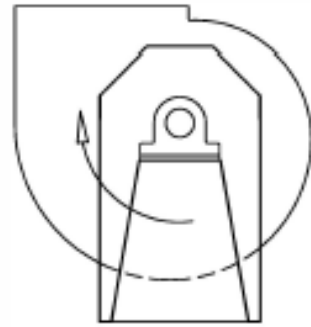

CLOCKWISE
UP BLAST

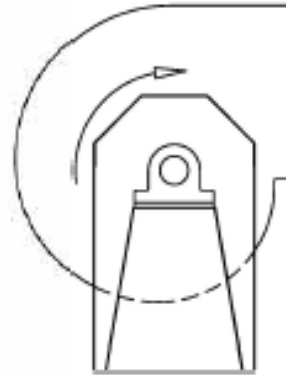

CLOCKWISE
TOP HORIZONTAL

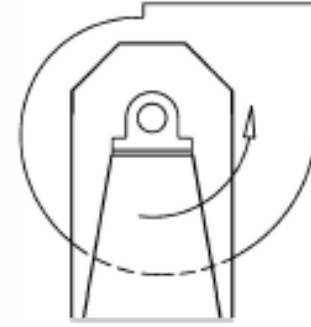

COUNTERCLOCKWISE
UP BLAST

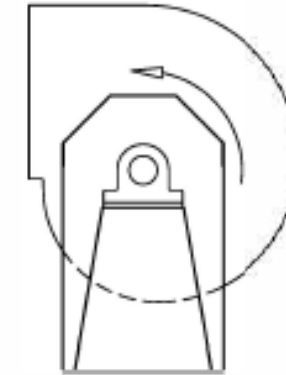

COUNTERCLOCKWISE
TOP HORIZONTAL

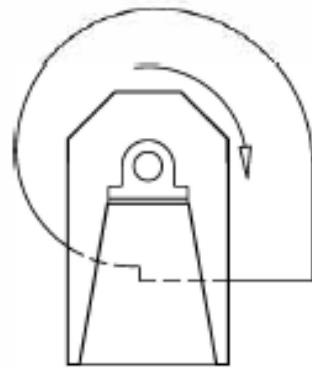

CLOCKWISE
DOWN BLAST

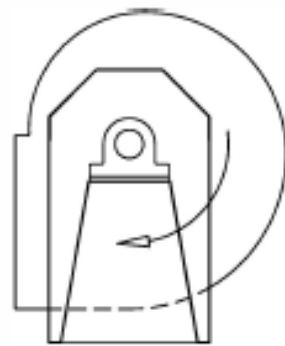

CLOCKWISE
BOTTOM HORIZONTAL

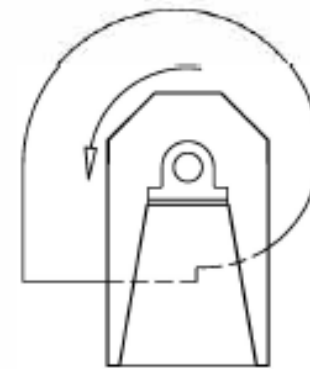

COUNTERCLOCKWISE
DOWN BLAST



COUNTERCLOCKWISE
BOTTOM HORIZONTAL

NOTES:

1. DIRECTION OF ROTATION IS DETERMINED FROM DRIVE SIDE OF FAN.
2. SAME AS AMCA STANDARD 99-2406
3. LEV-CO FANS ARE ASSEMBLED IN CLOCKWISE TOP HORIZONTAL ORIENTATION UNLESS OTHERWISE SPECIFIED

13-03

| | |
|---------------------------|--|
| CUSTOMER: | |
| CUSTOMER P.O.: | |
| PROJECT: | |
| ENGINEER: | |
| SALES REP.: | |
| IDENTIFICATION / TAGGING: | |

> www.lev-co.com • 1.888.862.5356

lev-co

The device depicted and described hereon embodies proprietary information owned by the manufacturer. All design, manufacturing, reproduction, sales and patent rights regarding this device or drawing reserved except where explicit right is guaranteed in writing. We reserve the right to make design changes.

| | |
|-----------|-----------|
| Drawn by: | JANOS B |
| Date: | 6/23/2015 |
| Scale: | NTS |
| Weight: | N/A |

**13-03 P-MAX
Direct Drive Fan**
Specification Drawing



| | | | |
|--------------|---|------------|------------------------|
| Drawing No.: | - | File Name: | (13-03) P-Max Fan - SD |
| Material: | - | Sheet: | 9/10 |

MODELS & OPTIONS:

| Part # | Description | | | |
|--|--|---|--|--|
| Main System / Part | | | | |
| <input type="checkbox"/> | P-147-1 | P-Max direct drive fan 0.5 HP 115V/1/60. | | |
| <input type="checkbox"/> | P-147-2 | P-Max direct drive fan 0.5 HP 208-230V/1/60 | | |
| <input type="checkbox"/> | P-147-3 | P-Max direct drive fan 0.5 HP 230-460V/3/60. | | |
| <input type="checkbox"/> | P-147-4 | P-Max direct drive fan 0.5 HP 575V/3/60. | | |
| <input type="checkbox"/> | P-148-1 | P-Max® direct drive fan 1 HP 115V/1/60. | | |
| <input type="checkbox"/> | P-148-2 | P-Max® direct drive fan 1 HP 208-230V/1/60. | | |
| <input type="checkbox"/> | P-148-3 | P-Max® direct drive fan 1 HP 230-460V/3/60. | | |
| <input type="checkbox"/> | P-148-4 | P-Max® direct drive fan 1 HP 575V/3/60. | | |
| <input type="checkbox"/> | P-149-1 | P-Max® direct drive fan 1 HP 115/1/60 | | |
| <input type="checkbox"/> | P-149-2 | P-Max® direct drive fan 1 HP 208-230/460/3/60 | | |
| <input type="checkbox"/> | P-149-3 | P-Max® direct drive fan 1 HP 575-600/3/60 | | |
| <input type="checkbox"/> | P-149-4 | P-Max® direct drive fan 1 HP 230/1/60 | | |
| <input type="checkbox"/> | P-152-1 | P-Max® direct drive fan 1.5 HP 115/230/1/60 (use 2HP motor when the TSP is less than 4" w.g.) | | |
| <input type="checkbox"/> | P-152-2 | P-Max® direct drive fan 1.5 HP 208-230/460/3/60 (use 2HP motor when the TSP is less than 4" w.g.) | | |
| <input type="checkbox"/> | P-152-3 | P-Max® direct drive fan 1.5 HP 575-600V/3/60 (use 2HP motor when the TSP is less than 4" w.g.) | | |
| <input type="checkbox"/> | P-153-1 | 2.0 HP direct drive fan 115/1/60 with BI aluminum wheel with self cleaning blades, AMCA type B spark resistance construction (rated for 1200CFM@5" w.g.) | | |
| <input type="checkbox"/> | P-153-2 | 2 HP direct drive fan 208-230/460/3/60 with BI aluminum wheel with self cleaning blades, AMCA type B spark resistance construction (rated for 1200CFM@5" w.g.) | | |
| <input type="checkbox"/> | P-153-3 | 2 HP direct drive fan 575/3/60 with BI aluminum wheel with self cleaning blades, AMCA type B spark resistance construction (rated for 1200CFM@5" w.g.) | | |
| <input type="checkbox"/> | P-154-1 | 3 HP direct drive fan 208-230/460/3/60 with BI aluminum wheel with self cleaning blades, AMCA type B spark resistance construction (rated for 1800CFM@5.5" w.g.) | | |
| <input type="checkbox"/> | P-154-2 | 3 HP direct drive fan 575/3/60 with BI aluminum wheel with self cleaning blades, AMCA type B spark resistance construction (rated for 1800CFM@5.5" w.g.) | | |
| <input type="checkbox"/> | P-155-1 | 5 HP direct drive fan 208-230/460/3/60 with BI aluminum wheel with self cleaning blades, AMCA type B spark resistance construction (rated for 1300CFM@10" w.g.) | | |
| <input type="checkbox"/> | P-155-2 | 5 HP direct drive fan 575/3/60 with BI aluminum wheel with self cleaning blades, AMCA type B spark resistance construction (rated for 1300CFM@10" w.g.) | | |
| <input type="checkbox"/> | P-156-1 | 7.5 HP direct drive fan 208-230/460/3/60 with BI aluminum wheel with self cleaning blades, AMCA type B spark resistance construction (rated for 1600CFM@10" w.g.) | | |
| <input type="checkbox"/> | P-156-2 | 7.5 HP direct drive fan 575/3/60 with BI aluminum wheel with self cleaning blades, AMCA type B spark resistance construction (rated for 1600CFM@10" w.g.) | | |
| Ultra Low Noise Fan | | | | |
| <input type="checkbox"/> | P-152-55dBA | ULTRA LOW NOISE P-Max Fan 115v/1/60 1.5hp Fan | | |
| <input type="checkbox"/> | P-152-55dBA | ULTRA LOW NOISE P-Max Fan 230-460v/3/60 1.5hp Fan | | |
| <input type="checkbox"/> | P-152-55dBA | ULTRA LOW NOISE P-Max Fan 575v/3/60 1.5hp Fan | | |
| Explosion Proof Option (when ordering main unit) | | | | |
| <input type="checkbox"/> | P-149-EXP | Explosion proof option for all P-149 Fans. Option comes complete with Class 1, Group D, Div. 1 Explosion Proof Motor and Spark Resistant (Aluminum) Impeller. It doesn't include the motor starter | | |
| Hose Connectors and Fittings | | | | |
| <input type="checkbox"/> | R-060 | Inlet Ø125 galvanized, 8 bolts M8 x 16mm. Packed in plastic. | | |
| <input type="checkbox"/> | R-061 | Inlet Ø150/160 powder coated black, 8 bolts M8 x 16mm. Packed in plastic. | | |
| <input type="checkbox"/> | R-062 | Inlet Ø200 powder coated black, 8 bolts M8 x 16mm. Packed in plastic. | | |
| <input type="checkbox"/> | R-063 | Inlet Ø100 powder coated black, 8 bolts M8 x 16mm. Packed in plastic. | | |
| <input type="checkbox"/> | R-064 | Inlet Ø75 powder coated black, 8 bolts M8 x 16mm. Packed in plastic. | | |
| 10HP High Pressure Fans: | | | | |
| <input type="checkbox"/> | P-156-HF-1 | 10 HP direct drive fan 208-230/460/3/60 with BI(cast) aluminum wheel with self cleaning blades, AMCA type B spark resistance construction (rated for 1600CFM@10 w.g.) Comes complete with an 8" dia. inlet and outlet collar. If a mounting bracket is required pls use part number P-766-155/156/156HF. | | |
| <input type="checkbox"/> | P-156-HF-2 | 10 HP direct drive fan 575/3/60 with BI(cast) aluminum wheel with self cleaning blades, AMCA type B spark resistance construction (rated for 1600CFM@10 w.g.) Comes complete with an 8" dia. inlet and outlet collar. If a mounting bracket is required pls use part number P-766-155/156/156HF. | | |
| Fan Mounting Brackets | | | | |
| <input type="checkbox"/> | OM-092 | P-Max Fan/Duct mounting bracket for 2 x 150mm (6")Ø Hoses c/w 150/160 mm (6"Ø/6.33") hose/duct connection. Package contains: Plastic cover (Block end) in cases where only one hose is used 2 - 5" Ø reducers for connections to 5" Ø hoses 2 - 4" Ø reducers for connections to 4" Ø hoses P-Max Fan mounting bracket for Pro-Flex & Supermax Extraction Arms. P-MAX fan mounting bracket for spring recoil hose reels. P-MAX fan mounting bracket c/w swivel. For P-Max fan on H-Max Ext. Boom for Flexi-I, Pro-Flex Extr.Crane(4",5",6.5"),VE Ext. Boom for Hose Reels&Hose Drops(4",5",6")&VE articulating Crane for Hose Drops (4", 5", 6") P-MAX fan mounting bracket c/w swivel. To be used to install a P-Max fan on a H-Max Extension Boom for Flexi-II and E-Z Arm, Pro-Flex Extraction Crane (8" dia.), VE Extension Boom for Hose Reels&Hose Drops (8" dia.) and VE articulating Crane for Hose Drops (8" dia.) P-Max fan mounting bracket for E-Z Arm. P-MAX fan mounting bracket for wall, ceiling or roof - Galvanized P-MAX fan mounting bracket for wall, ceiling or roof - Heavy Duty - Galvanized Portable frame with handle for P-Max portable fan Set of 4 wheels for P-Max portable fan | | |
| <input type="checkbox"/> | P-016 | | | |
| <input type="checkbox"/> | P-033-HR | | | |
| <input type="checkbox"/> | P-045 | | | |
| <input type="checkbox"/> | P-151 | | | |
| <input type="checkbox"/> | P-765 | | | |
| <input type="checkbox"/> | P-766 | | | |
| <input type="checkbox"/> | P-766-HD | | | |
| <input type="checkbox"/> | P-766-PRT | | | |
| <input type="checkbox"/> | P-766-WLK | | | |
| Energy Saving Options (Automatic Dampers, Timers, VFD's...) | | | | |
| <input type="checkbox"/> | P-014-1 | Energy Saver Automatic E-Max® 208-230V/3/60: automatic start/stop of the fan by welding. | | |
| <input type="checkbox"/> | P-014-2 | Energy Saver Automatic E-Max® 460V/3/60: automatic start/stop of the fan by welding. | | |
| <input type="checkbox"/> | P-108 | Energy Saver Damper S-MAX 160 MM (6.5") 115/1/60. For use with Extractor Arms and Vehicle Exhaust Hoses. Damper is electrically operated and micro-switch controlled. (Hood mounted for extractor arm and reel mounted for hose reels, micro-switch Model: MS-12 is sold separately.) Ideal for Multi-Station and Multi-Drop applications. | | |
| <input type="checkbox"/> | P-109 | Energy Saver Damper S-MAX 160 or 200 MM. For use with Extractor Arms and other welding smoke applications. Damper is electrically operated and current sensor controlled. | | |
| <input type="checkbox"/> | P-118 | Ideal for Multi-Station and Multi-Drop applications. Voltage 220/1/60 Energy saver Control Unit C-Max: Automatic Start Stop of central fan. Must be used in conjunction with P-108 or P-109 Energy Saver Automatic Dampers. The C-Max strts the central fan as soon as a one of the dampers is open and and it stops the central fan automatically when none of the extractors are in use. Adjustable over-run period. Motor overload included. Field installation required | | |
| Sound Attenuation | | | | |
| <input type="checkbox"/> | SIL-8 | Silencer for P-Max series fan, 8" (200mm) (for use with P-Max Fans) | | |
| Automatic Motor Starter | | | | |
| <input type="checkbox"/> | P-025-24S-120V-1PH-2.0HP | Energy Saver E- Man® 115V/1/60. Fan Motor control station. Rated up to 2 HP. Permits automatic start-stop of the fan from the extractor arm hood, hose reel or other device with Remote Switch. Remote mounted switches must be ordered separately(EG: LS-12 - Hood mounted Switch, MS-12 Hose reels...). Comes complete with relevant Motor overload. Please specify Motor HP when ordering _____. Also includes a 50 VA 24V AC transformer for powering devices such as halogen Lights. | | |
| <input type="checkbox"/> | P-025-24S-208/230V-3PH-7.5HP | Energy Saver E- Man® 208-230V/3/60. Fan Motor control station. Rated up to 7.5 HP. Permits automatic start-stop of the fan from the extractor arm hood, hose reel or other device with Remote Switch. Remote mounted switches must be ordered separately (EG: LS-12 - Hood mounted Switch, MS-12 Hose reels...). Comes complete with relevant Motor overload. Please specify Motor HP when ordering _____. Also includes a 50 VA 24V AC transformer for powering devices such as halogen Lights. | | |
| <input type="checkbox"/> | P-025-24S-240V-1PH-3HP | Energy Saver E- Man® 240V/1/60. Fan Motor control station. Rated up to 3 HP. Permits automatic start-stop of the fan from the extractor arm hood, hose reel or other device with Remote Switch. Remote mounted switches must be ordered separately (EG: LS-12 - Hood mounted Switch, MS-12 Hose reels...). Comes complete with relevant Motor overload. Please specify Motor HP when ordering _____. Also includes a 50 VA 24V AC transformer for powering devices such as halogen Lights. | | |
| <input type="checkbox"/> | P-025-24S-460V-3PH-20HP | Energy Saver E- Man® 460V/3/60. Fan Motor control station. Rated up to 20 HP. Permits automatic start-stop of the fan from the extractor arm hood, hose reel or other device with Remote Switch. Remote mounted switches must be ordered separately (EG: LS-12 - Hood mounted Switch, MS-12 Hose reels...). Comes complete with relevant Motor overload. Please specify Motor HP when ordering _____. Also includes a 50 VA 24V AC transformer for powering devices such as halogen Lights. | | |
| <input type="checkbox"/> | P-025-24S-575V-3PH-20HP | Energy Saver E- Man® 575V/3/60. Fan Motor control station. Rated up to 20 HP. Permits automatic start-stop of the fan from the extractor arm hood, hose reel or other device with Remote Switch. Remote mounted switches must be ordered separately (EG: LS-12 - Hood mounted Switch, MS-12 Hose reels...). Comes complete with relevant Motor overload. Please specify Motor HP when ordering _____. Also includes a 50 VA 24V AC transformer for powering devices such as halogen Lights. | | |
| Fan, Light & Other Electrical Accessories | | | | |
| <input type="checkbox"/> | P-106 | Switch with 10 m cable for mounting on the hood of a fume extractor arm | | |
| Hose/Duct Connection Flange for P-Max fans (Also Called P-Flange) | | | | |
| <input type="checkbox"/> | P-F-075 | *Discontinued* see replacing part numbers R-060 through R-064 * Hose/Duct Connection Flange 75 mm (3") diameter. | | |
| <input type="checkbox"/> | P-F-100 | *Discontinued* see replacing part numbers R-060 through R-064 * Hose/Duct Connection Flange 100 mm (4") diameter. | | |
| <input type="checkbox"/> | P-F-125 | *Discontinued* see replacing part numbers R-060 through R-064 * Hose/Duct Connection Flange 125 mm (5") diameter. | | |
| <input type="checkbox"/> | P-F-150/160 | *Discontinued* see replacing part numbers R-060 through R-064 * Hose/Duct Connection Flange 150-160mm (6"-6.33") diameter. | | |
| <input type="checkbox"/> | P-F-160 | *Discontinued* see replacing part numbers R-060 through R-064 * Hose/Duct Connection Flange 160 mm (6.33") diameter. | | |
| <input type="checkbox"/> | P-F-200 | *Discontinued* see replacing part numbers R-060 through R-064 * Hose/Duct Connection Flange 200mm (8") diameter | | |
| Accessories for P-Max fans | | | | |
| <input type="checkbox"/> | P-SM-IN | Safety mesh for the inlet of P-Max fans. | | |
| <input type="checkbox"/> | P-SM-OT-Exhaust | Safety mesh for the exhaust outlet of P-Max fans. | | |
| Installation Accessories | | | | |
| <input type="checkbox"/> | IN-NLS-8 | 8" No-Loss Stack, 20 Gauge Galvanized, 4' overall height*. Complete with Internal Backdraft Damper. * alternate heights available upon request. | | |
| <input type="checkbox"/> | PDK-8 | Industrial grade duct kit for direct exhausting of P-Max fans. | | |
| <input type="checkbox"/> | PDK-RF-8 | Roof Curb Flashing for 8" diameter duct (Leak Proof) | | |

CUSTOMER:
 CUSTOMER P.O.:
 PROJECT:
 ENGINEER:
 SALES REP.:
 IDENTIFICATION / TAGGING:



The device depicted and described hereon embodies proprietary information owned by the manufacturer. All design, manufacturing, reproduction, sales and patent rights regarding this device or drawing reserved except where explicit right is guaranteed in writing. We reserve the right to make design changes.

Drawn by: JANOS B
 Date: 6/23/2015
 Scale: NTS
 Weight: N/A

13-03 P-MAX Direct Drive Fan
 Specification Drawing

Drawing No.: - File Name: (13-03) P-Max Fan - SD
 Material: - Sheet: 10/10