

OPTIONAL CYCLONE PREFILTER WITH OR WITHOUT INTERNAL CARTRIDGE

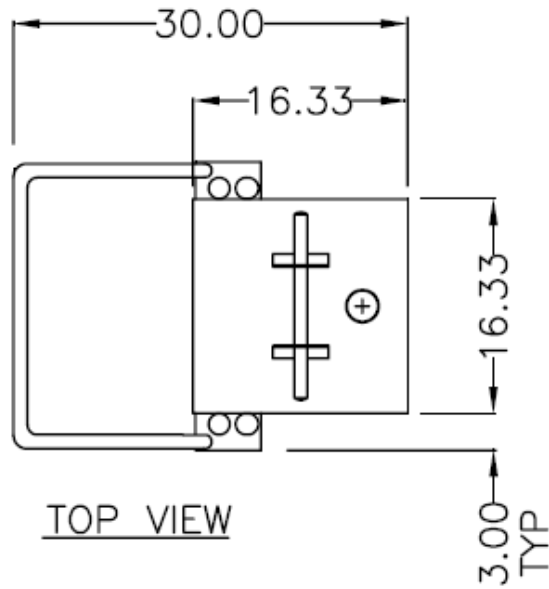

TOP VIEW

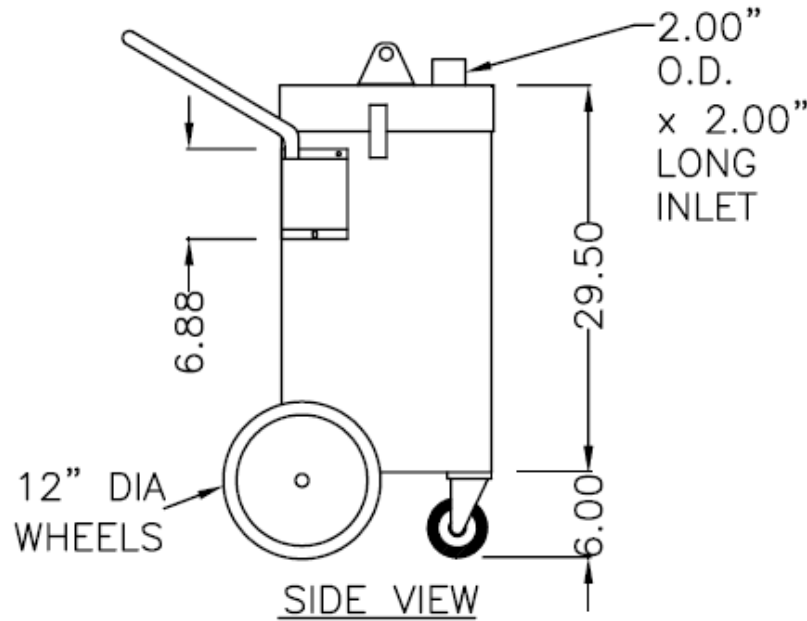

SIDE VIEW

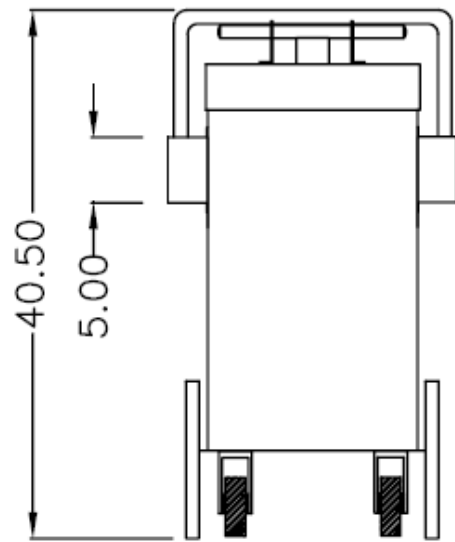

FRONT VIEW

- CONSTRUCTION:** 18 Gauge steel cabinet finished with Powder-Coat Finish. Includes 2" inlet connection and baffled inlet chamber, inlet adapter kit, on-off switch, 6' power cord, cord wrap/handle, big wheel kit, handle, 2 piece wand, and floor sweep tool.
- WEIGHT:** 77 lbs.
- AIRFLOW:** 200 CFM max/94" W.C. max (brush motors)  
107 CFM max/152" W.C. max (brushless motor)
- ELECTRICAL:**  (2)brush-type mtr/blwrs, 115/1/60, 15.8 total amps, std.  
 (2)230/50/60, 14.0 total amps, (brush), opt.  
 (1)120/60, 15.6 amps, Continuous duty, brushless, opt. (Not to be used in wet applications.)
- NOISE:** 74 dBA @ 5' (brush)  
68 dBA @ 5' (brushless)

**SPECIFICATIONS:**

- PREFILTERS:**  (1) Cyclone, opt.  
 (1) Cyclone w/internal cleanable/replaceable cartridge, opt.
- MAIN FILTERS:**  (1) 95% cartridge, std.  
 (1) 99.97% HEPA, opt.

- OTHER OPTIONS:**  Smoke gun attachment  
 Grinding hood kits  
 Sanding hood kits  
 Cyclone hanger

**REPLACEMENT PARTS:** Motor brushes (replace every 500 hours)

**FIRE SUPPRESSION:** Equipment provided by others.

\* AFS FILTER EFFICIENCIES BASED ON ASHRAE 52-76 TEST METHOD

FROM SOURCE

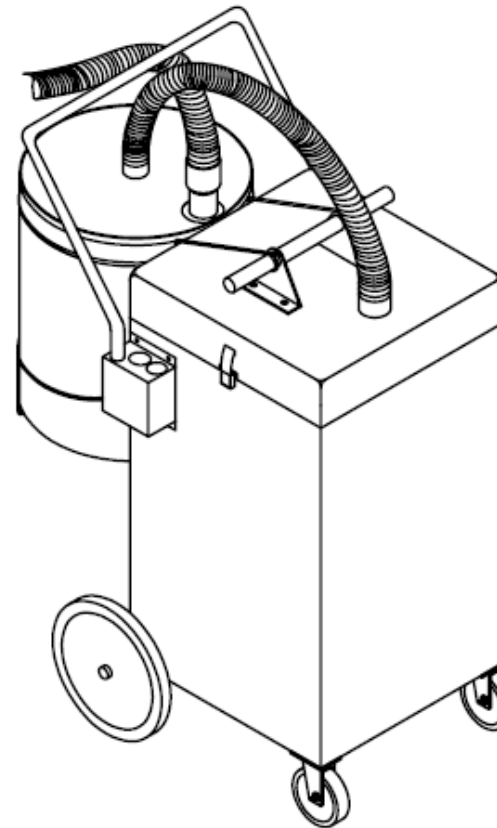

SHOWN WITH OPTIONAL CYCLONE PREFILTER & CYCLONE HANGER

**ACCESSORY HOODS**

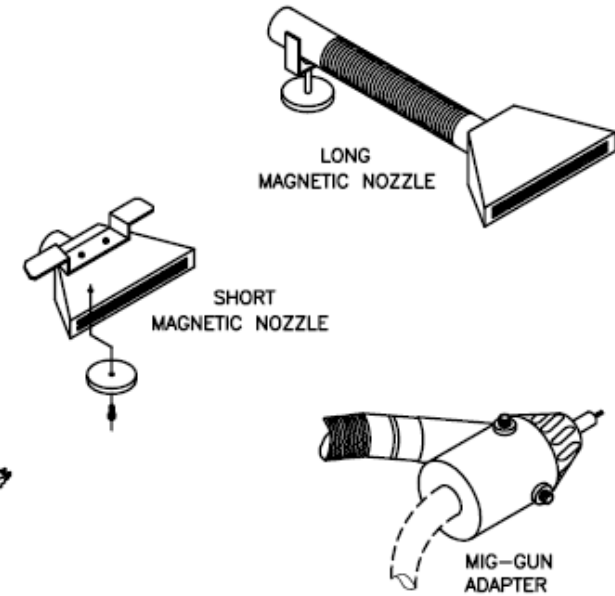

CUSTOMER:
CUSTOMER P.O.:
PROJECT:
ENGINEER:
SALES REP.:
IDENTIFICATION / TAGGING:

> [www.lev-co.com](http://www.lev-co.com) • 1.888.862.5356



The device depicted and described hereon embodies proprietary information owned by the manufacturer. All design, manufacturing, reproduction, sales and patent rights regarding this device or drawing reserved except where explicit right is guaranteed in writing. We reserve the right to make design changes.

Drawn by:	JANOS B
Date:	5/2/2008
Scale:	NTS
Weight:	N/A

<b>12-02 V1</b>	
<b>Portable</b>	
Specification Drawing	
Drawing No.:	File Name: (12-02) V1 Portable - SD
Material:	Product manufactured by: <b>Airflow SYSTEMS INC.</b>
Sheet: 1/2	

## MODELS & OPTIONS

**Part # Description**

### Main System / Part

- V1-CONT Portable high vacuum dust, smoke and fume collector w/ (1) Clean-2® cartridge filter, (1) Continuous Duty brushless motor/blower, 115/1/60Hz, with lighted on-off switch, 6' power cord, and cord wrap/handle. Rated 107 cfm max /152" WC max
- V1 Portable high vacuum dust, smoke and fume collector w/high efficiency cleanable/disposable cartridge filter, 2 brush-type motor blowers\*, 115/1/60, 15 amps, 2/lighted on-off switch & 6' power cord, cord wrap/handle & caster wheels. Must order hose connector separately.

### Fan / Motor Upgrades or Options (when ordering main unit)

- V1-BL Brushless motor assembly option for V-1.

### Filter Options (when ordering main unit)

- V1-2KT92017 Kit to Field Convert Std Cyclone to Internal Cartridge Filter Option for Standard V-1 Unit
- V1-2KT93016 Cyclone Barrel Holder Option for Standard V-1 Unit
- V1-CYC-F Cyclone with internal cleanable/replaceable cartridge filter. (15" dia. x 18" height and weighs 13 lbs.). Does not include Cyclone barrel holder - please add separately.

### Misc. Options

- V1-P Portable package, includes big wheel kit, & handle, 2 piece wand, and floor sweep tool, cyclone is an option. (Add 26 lbs. to ship weight).
- V1-2KT95702 "Y" Connector Kit Option for Standard V-1 Unit
- SGA-01 Smokeless Gun Adapter. Adapts to welding gun for on-tool capture of welding smoke. (Fits most standard welding guns.) 1 1/4" hose connection. Hose & hose clamps must be ordered separately

### "Hi-Vac" Hoses, Crush-resistant

- HVH-CR-1.25 1.25" diameter "HI VAC" Flexible hose - **price per foot**
- HVH-CR-1.5 1.5" diameter "HI VAC" Flexible hose - **price per foot**
- HVH-CR-2.0 2.0" diameter "HI VAC" Flexible hose - **price per foot**
- HVH-CR-2.5 2.5" diameter "HI VAC" Flexible hose - **price per foot**
- HVH-CR-3.0 3.0" diameter "HI VAC" Flexible hose - **price per foot**

### "Hi-Vac" Hoses, Wire Reinforced

- HVH-WR-0.75 0.75" diameter "HI-VAC" hose - **price per foot**
- HVH-WR-1.0 1.0" diameter "HI-VAC" hose - **price per foot**
- HVH-WR-1.25 1.25" diameter "HI-VAC" hose - **price per foot**
- HVH-WR-1.5 1.5" diameter "HI-VAC" hose - **price per foot**
- HVH-WR-1.75 1.75" diameter "HI-VAC" hose - **price per foot**
- HVH-WR-2.0 2.0" diameter "HI-VAC" hose - **price per foot**
- HVH-WR-2.25 2.25" diameter "HI-VAC" hose - **price per foot**
- HVH-WR-2.5 2.5" diameter "HI-VAC" hose - **price per foot**
- HVH-WR-3.0 3.0" diameter "HI-VAC" hose - **price per foot**
- HVH-WR-4.0 4.0" diameter "HI-VAC" hose - **price per foot**

### Hose Connectors and Fittings

- 7HD91402 1-1/2" NPT x 1-1/2" D Hose Barb
- 7HD91403 2" NPT x 2"D Hose Barb
- 7HP27002 1-1/2NPT x 1.75"D Copper Nipple
- 7HP28013 3"NPT x 2"NPT Reducer
- 2AZ67001 Fitting adapter kit 2" to 1.5" (Comes standard with Model V1).
- 7HD21001 1.5 x 1.5 Connector
- 7HD90000 1.0D, Non-Swivel Cuff
- 7HD91001 1.25D, Vinyl Swivel Cuff
- 7HD91002 1.5D, Vinyl Swivel Cuff
- 7HD91003 2.0D, Vinyl Swivel Cuff
- 7HD91004 1.25D x 1.5D Enlarger
- 7HD91005 1.5D, Non Swivel Cuff
- 7HD91006 1.5D x 1.75D Enlarger
- 7HD91007 2 x 1.5 Steel Reducer
- 7TL09002 2 Piece Wand, 54" Long, 1.5 diameter
- 7HD91011 2" x 1.5" reducer. To connect 2" hose to the 7TL0-9002 (2 piece wand).
- HOSE-C-1.25"x1.5" Hose Connector, Steel. Connects 1 1/4" to 1 1/2" vacuum hose.
- HOSE-C-1.75 Hose Connector Steel. Connects 1 3/4" hose to 2" vacuum hose

### Hose, Hood & Nozzle Options

- 7TL09001 Floor Sweep Tool
- 7TL09002 2 Piece Wand, 54" Long, 1.5 diameter

### Source Capture Nozzles, Suction Casings & Hoods

- 2AH17008 Nozzle, Soldering Iron.
- 2AH17003 Magnetic Nozzle, short. Nozzle comes complete with:  
2" diameter hose connection  
10 X 1.25" rectangular opening for capture of fumes and dust
- 2AH17004 Magnetic Nozzle, long. Nozzle comes complete with:  
2" diameter hose connection, 19" Long flexible steel duct  
10" x 1.25" rectangular opening for capture of fumes and dust
- OG-MG-001 ON-GUN suction nozzle for most 250-400 amp. MIG welding guns, as follows:  
50-80 CFM required per gun (depending on the application and welding gun amperage)  
Nozzle supplied with a 1" hose connection 10' hose c/w hose cuff (Hose and hose clamps must be ordered separately)
- OG-MG-005 ON-GUN suction nozzle for most "Push/Pull" MIG welding guns, as follows:  
60-100 CFM required per gun (depending on the application and welding gun amperage)  
Nozzle supplied with a 1" hose connection (Hose and hose clamps must be ordered separately)
- OG-MG-006 ON-GUN suction nozzle for most "Large Automatics" MIG welding guns, as follows:  
400+ amp.  
70-120 CFM required per gun (depending on the application and welding gun amperage)  
Nozzle supplied with a 1" hose connection (Hose and hose clamps must be ordered separately)

12-02

CUSTOMER:  
CUSTOMER P.O.:  
PROJECT:  
ENGINEER:  
SALES REP.:  
IDENTIFICATION / TAGGING:

> [www.lev-co.com](http://www.lev-co.com) • 1.888.862.5356

**lev-co**

The device depicted and described hereon embodies proprietary information owned by the manufacturer. All design, manufacturing, reproduction, sales and patent rights regarding this device or drawing reserved except where explicit right is guaranteed in writing. We reserve the right to make design changes.

Drawn by: JANOS B  
Date: 5/2/2008  
Scale: NTS  
Weight: N/A



**12-02 V1**  
**Portable**  
**Specification Drawing**

Drawing No.: - File Name: (12-02) V1 Portable - SD  
Material: Product manufactured by: **Airflow SYSTEMS INC.** Sheet: 2/2