

General Specifications (see last 2 pages for details):

Blower package:

- Standard 1.5HP 115V/1/60
- Optional 3.0HP 230-460-575V/3/60
- Optional 5.0HP 230-460-575V/3/60
- Optional 7.5HP 230-460-575V/3/60
- Optional 10 HP 230-460-575V/3/60

Construction:

- 12/14/16 ga. welded steel, powder coated cabinet

Extraction arm:

- Two Ø6.5" diameter 7'/10'/14'/17' long Flexi-I arm
- Optional arm lengths up to 43'

Filtration:

- With up to 99.9% filter efficiency the Wall Flex VERTICAL Cartridge Filter will clean the premises of welding fumes and light grinding dust. The cleaned air is re-circulated into the premises, with no heat loss at all. The access to the self-cleaning replaceable cartridge filter is easy and changing it takes just a couple of minutes.

Jet Pulse Cleaning:

- WFD-1000 has a very efficient built in compressed air cleaning system. In a few minutes it cleans the built in filter cartridge. Then just open the door and empty the dust pan.

Noise level:

- Base unit: 80dB(A) @ 3'
- w/Silencer option: 75 dB(A) @ 3'

Weight:

- Base unit: 286 lbs.
- w/Two Arms (max): 420 lbs

CUSTOMER:
CUSTOMER P.O.:
PROJECT:
ENGINEER:
SALES REP.:
IDENTIFICATION / TAGGING:

> www.lev-co.com • 1.888.862.5356

lev-co

The device depicted and described hereon embodies proprietary information owned by the manufacturer. All design, manufacturing, reproduction, sales and patent rights regarding this device or drawing reserved except where explicit right is guaranteed in writing. We reserve the right to make design changes.

Drawn by: Janos B
Date: 5/23/2014
Scale: NTS
Weight: N/A

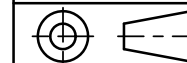

(03-051)
DUAL WALL FLEX
Specification Drawing
Drawing No.: -
Material: -
File Name: (03-051) Dual Wall Flex - SD
Sheet: 1/8

MOBILE UNIT OPTION IS ALSO AVAILABLE

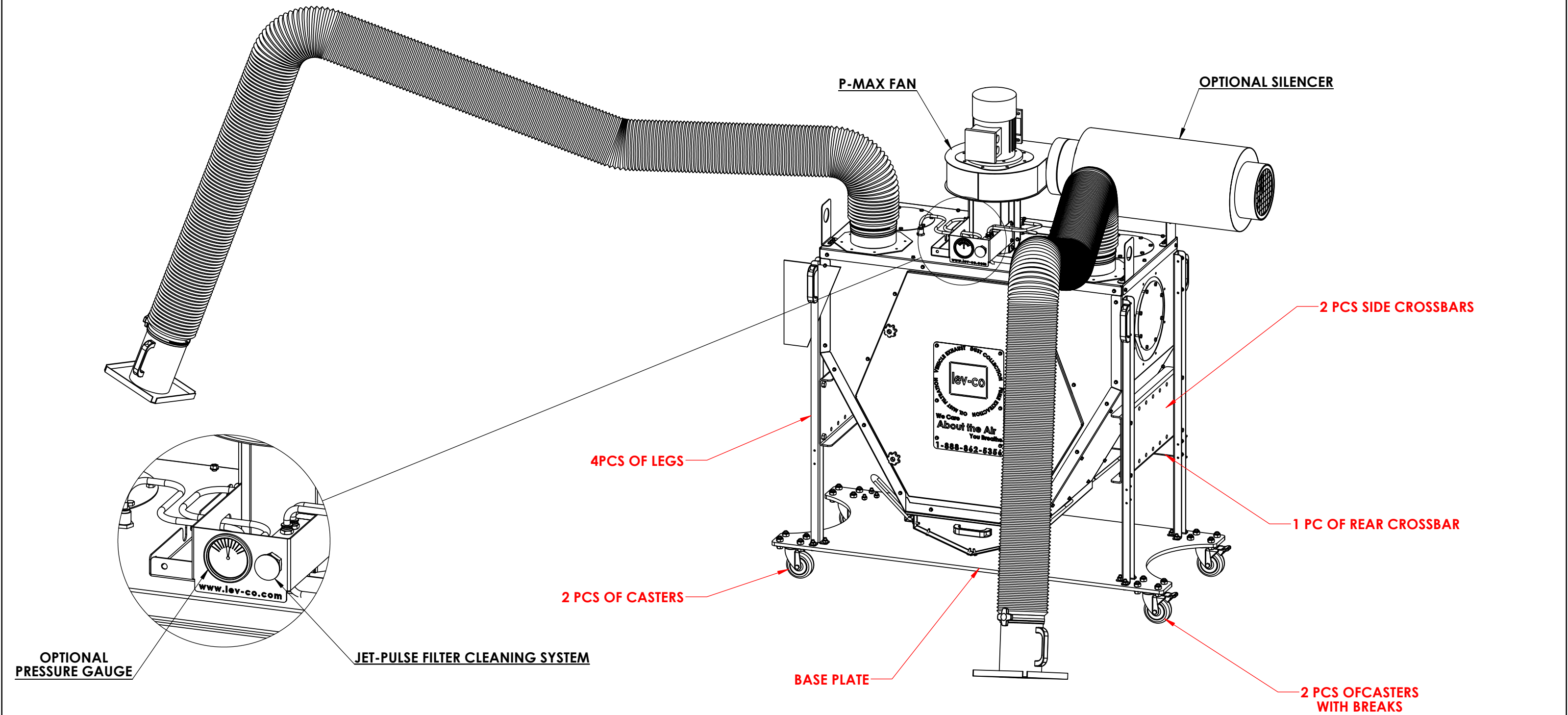

CUSTOMER:
CUSTOMER P.O.:
PROJECT:
ENGINEER:
SALES REP.:
IDENTIFICATION / TAGGING:



The device depicted and described hereon embodies proprietary information owned by the manufacturer. All design, manufacturing, reproduction, sales and patent rights regarding this device or drawing reserved except where explicit right is guaranteed in writing. We reserve the right to make design changes.

Drawn by:	Janos B
Date:	5/23/2014
Scale:	NTS
Weight:	N/A

(03-051) DUAL WALL FLEX Specification Drawing	
Drawing No.: -	File Name: (03-051) Dual Wall Flex - SD
Material: -	Sheet: 2/8

DUAL WF USAGE
WITH "PUSH-PULL" OPTION

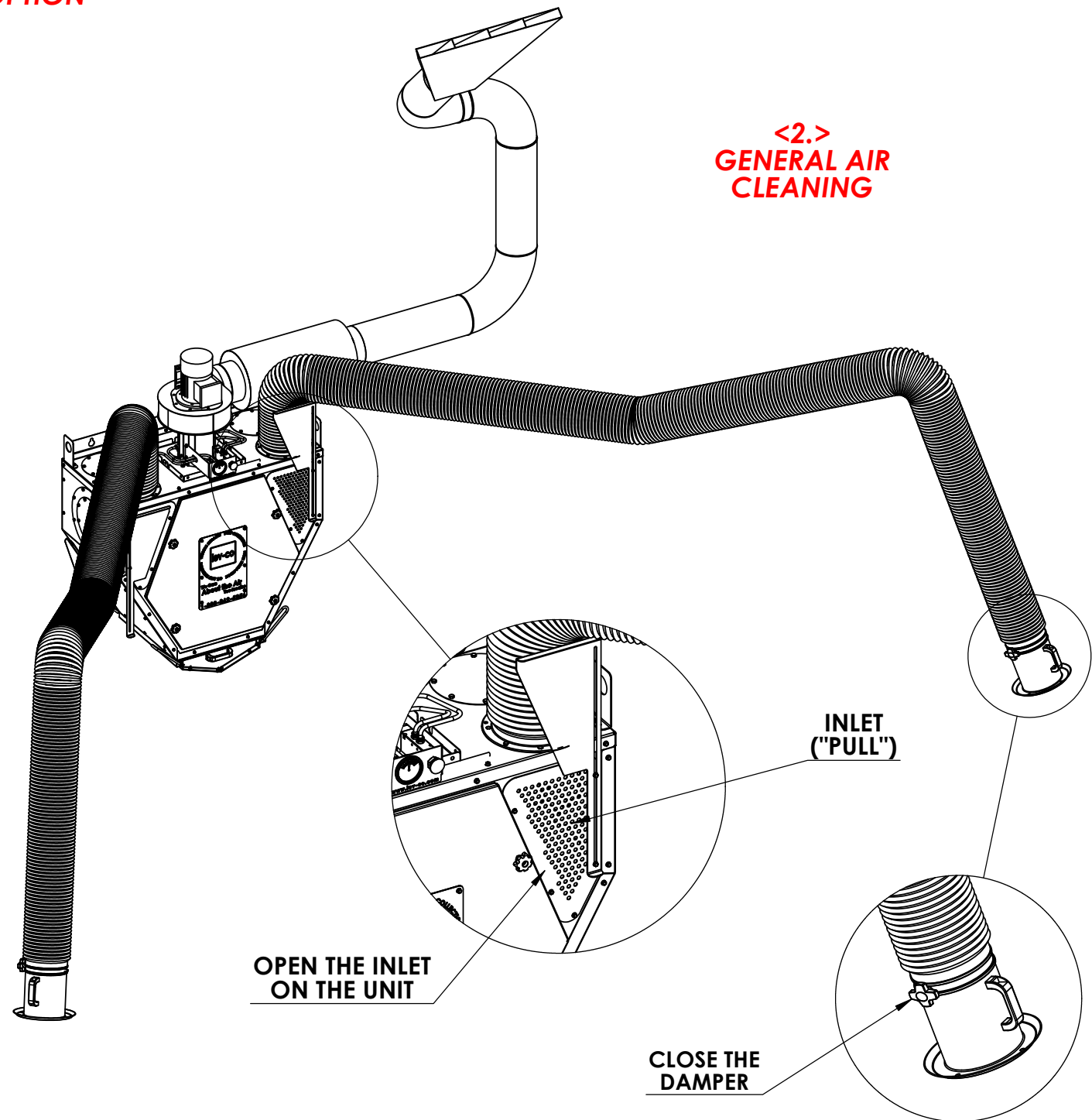
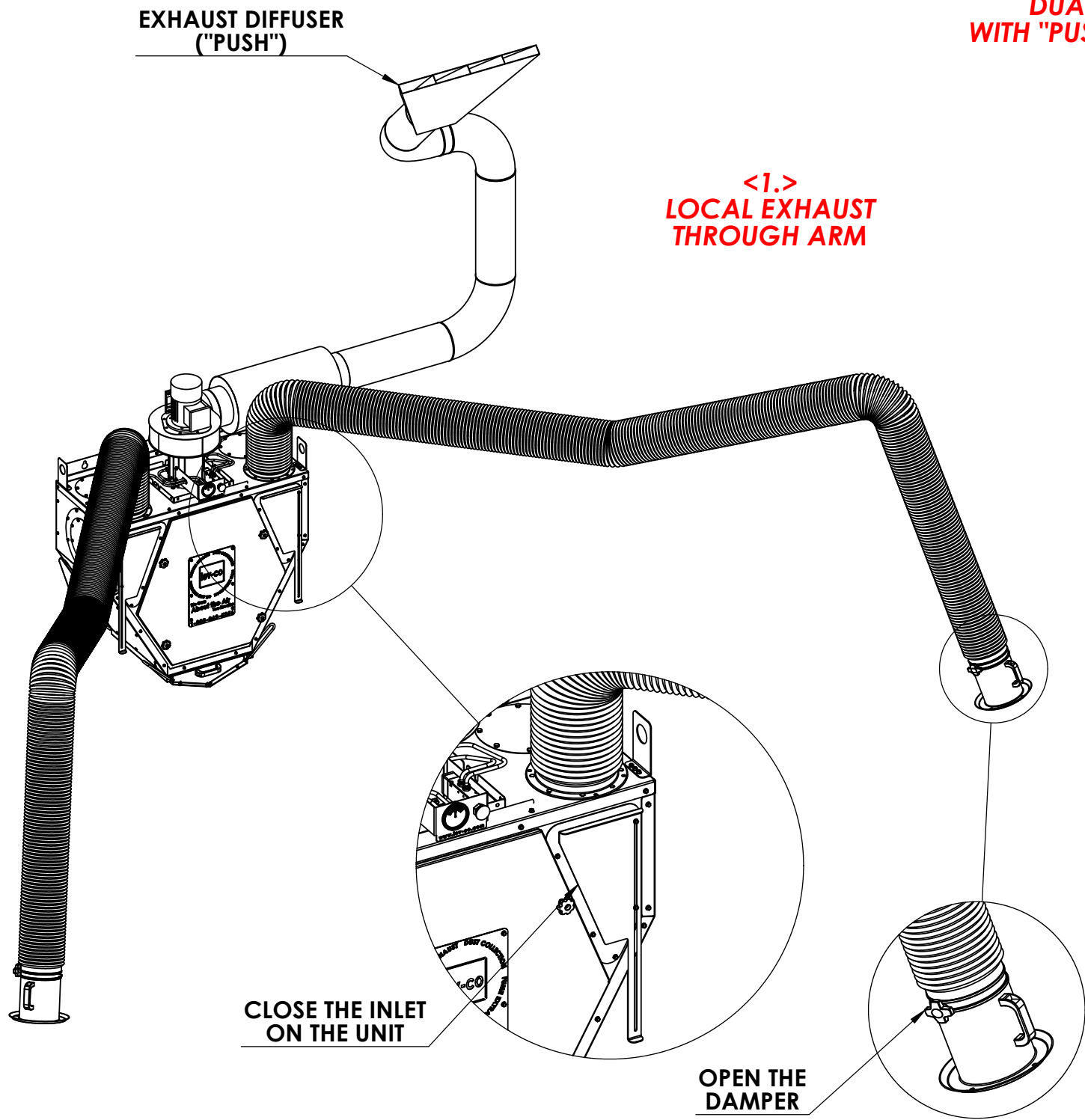

CUSTOMER:
CUSTOMER P.O.:
PROJECT:
ENGINEER:
SALES REP.:
IDENTIFICATION / TAGGING:



> www.lev-co.com • 1.888.862.5356



The device depicted and described hereon embodies proprietary information owned by the manufacturer. All design, manufacturing, reproduction, sales and patent rights regarding this device or drawing reserved except where explicit right is guaranteed in writing. We reserve the right to make design changes.

Drawn by:	Janos B
Date:	5/23/2014
Scale:	NTS
Weight:	N/A

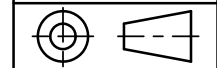

(03-051) DUAL WALL FLEX Specification Drawing	
Drawing No.: -	File Name: (03-051) Dual Wall Flex - SD
Material: -	Sheet: 3/8

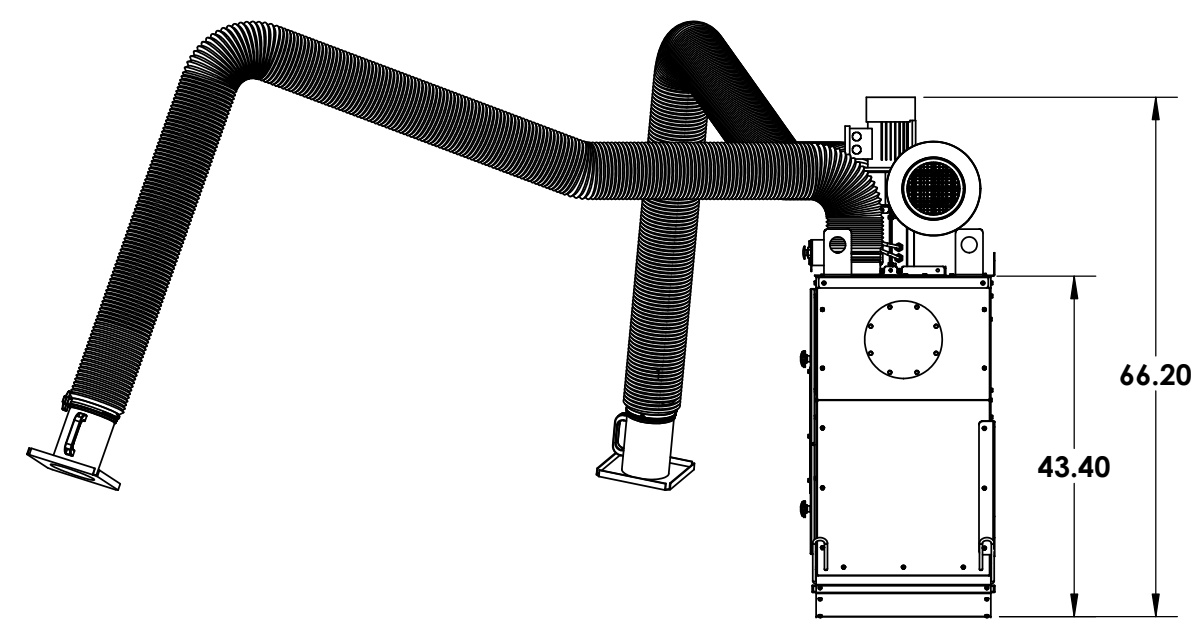
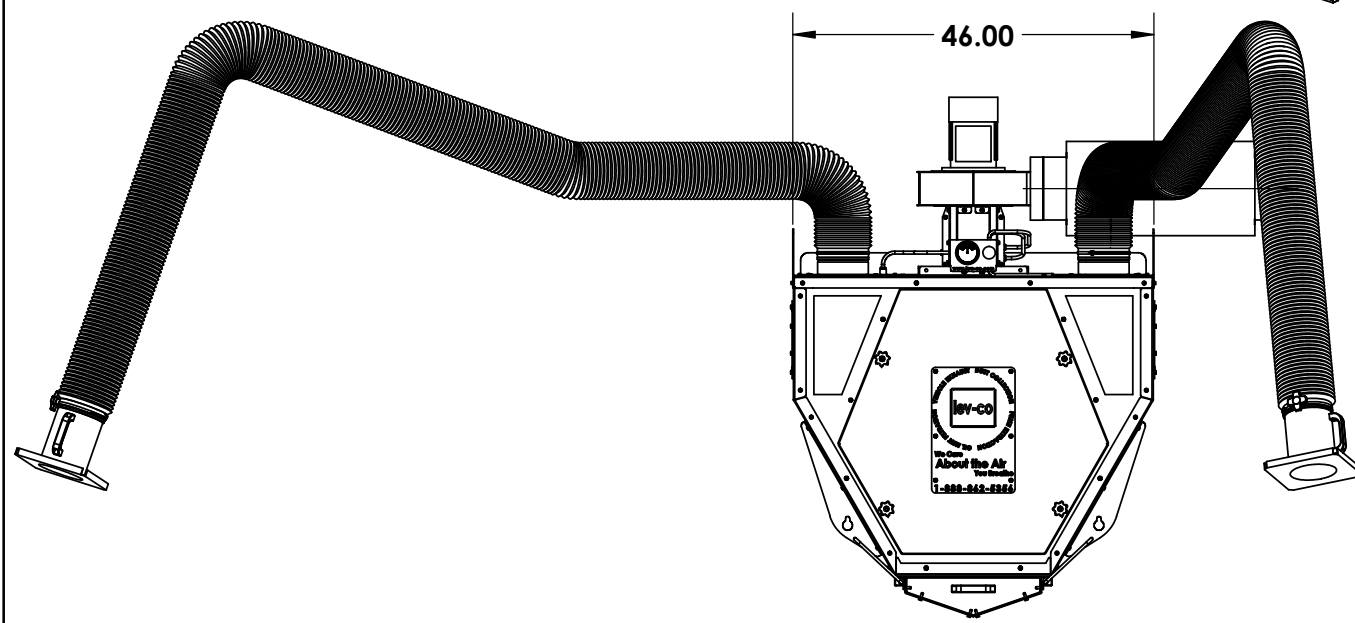
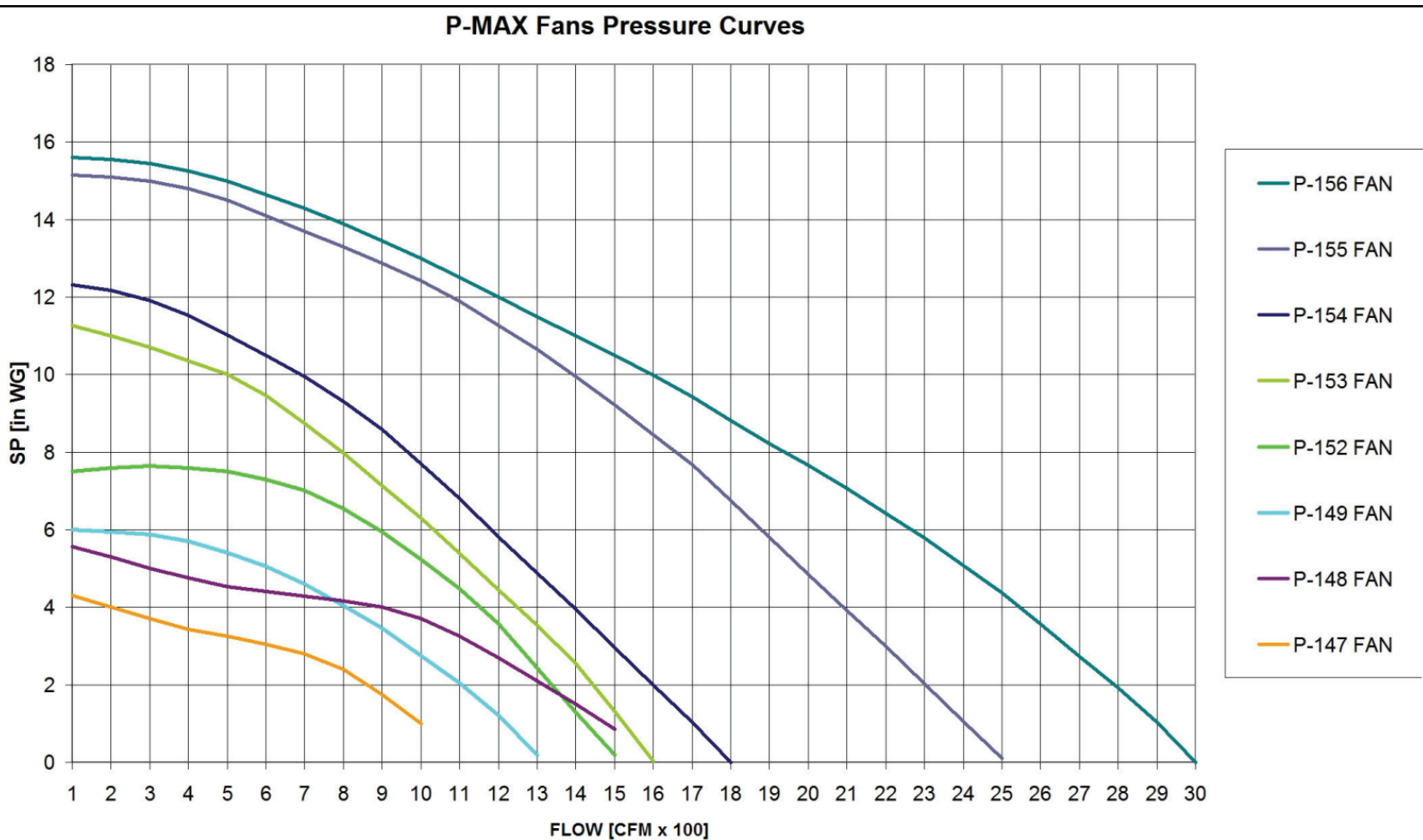
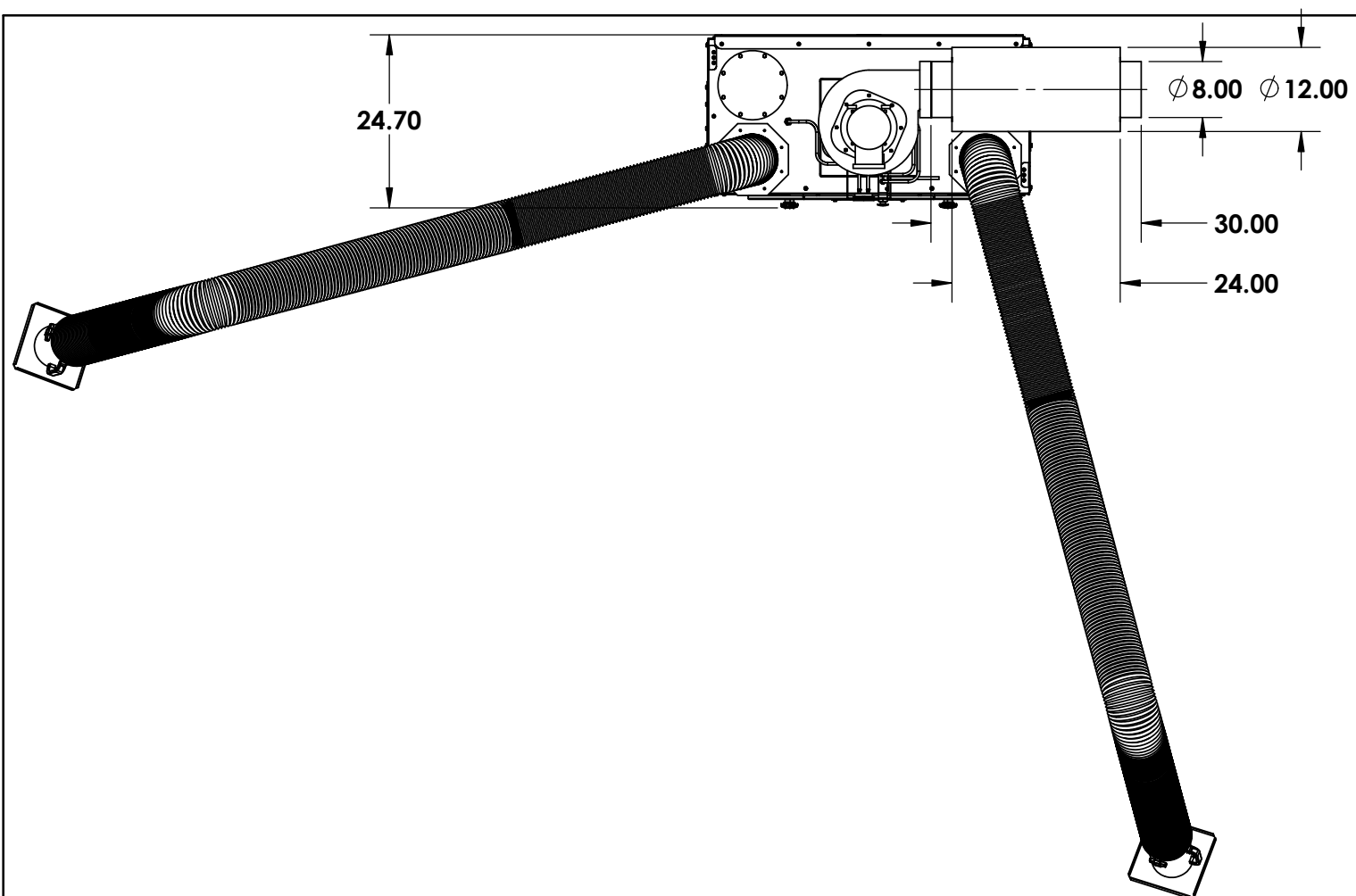

CUSTOMER:
CUSTOMER P.O.:
PROJECT:
ENGINEER:
SALES REP.:
IDENTIFICATION / TAGGING:

> www.lev-co.com • 1.888.862.5356



The device depicted and described hereon embodies proprietary information owned by the manufacturer. All design, manufacturing, reproduction, sales and patent rights regarding this device or drawing reserved except where explicit right is guaranteed in writing. We reserve the right to make design changes.

Drawn by: Janos B
Date: 5/23/2014
Scale: NTS
Weight: N/A

(03-051)
DUAL WALL FLEX
Specification Drawing

Drawing No.: - File Name: (03-051) Dual Wall Flex - SD
Material: - Sheet: 4/8

INSTALLATION DETAILS

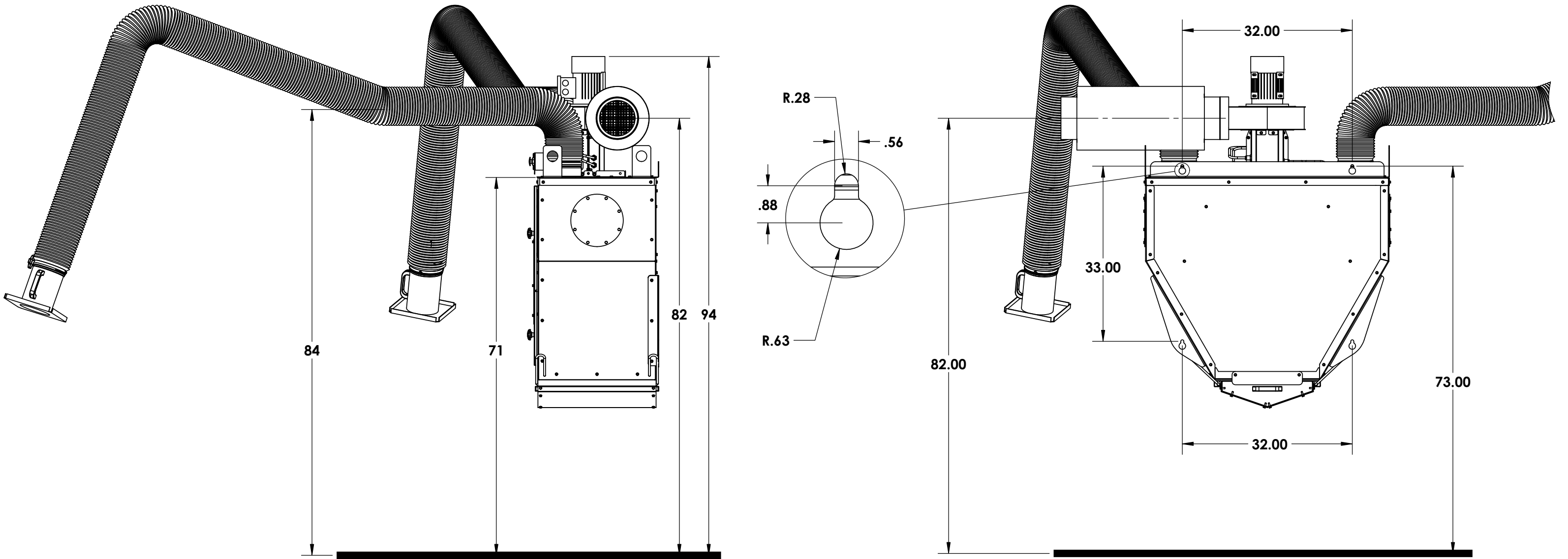

CUSTOMER:
CUSTOMER P.O.:
PROJECT:
ENGINEER:
SALES REP.:
IDENTIFICATION / TAGGING:

www.lev-co.com • 1.888.862.5356



The device depicted and described hereon embodies proprietary information owned by the manufacturer. All design, manufacturing, reproduction, sales and patent rights regarding this device or drawing reserved except where explicit right is guaranteed in writing. We reserve the right to make design changes.

Drawn by:	Janos B
Date:	5/23/2014
Scale:	NTS
Weight:	N/A

(03-051) DUAL WALL FLEX Specification Drawing	
Drawing No.: -	File Name: (03-051) Dual Wall Flex - SD
Material: -	Sheet: 5/8

THE SOURCE CAPTURE DRAWING

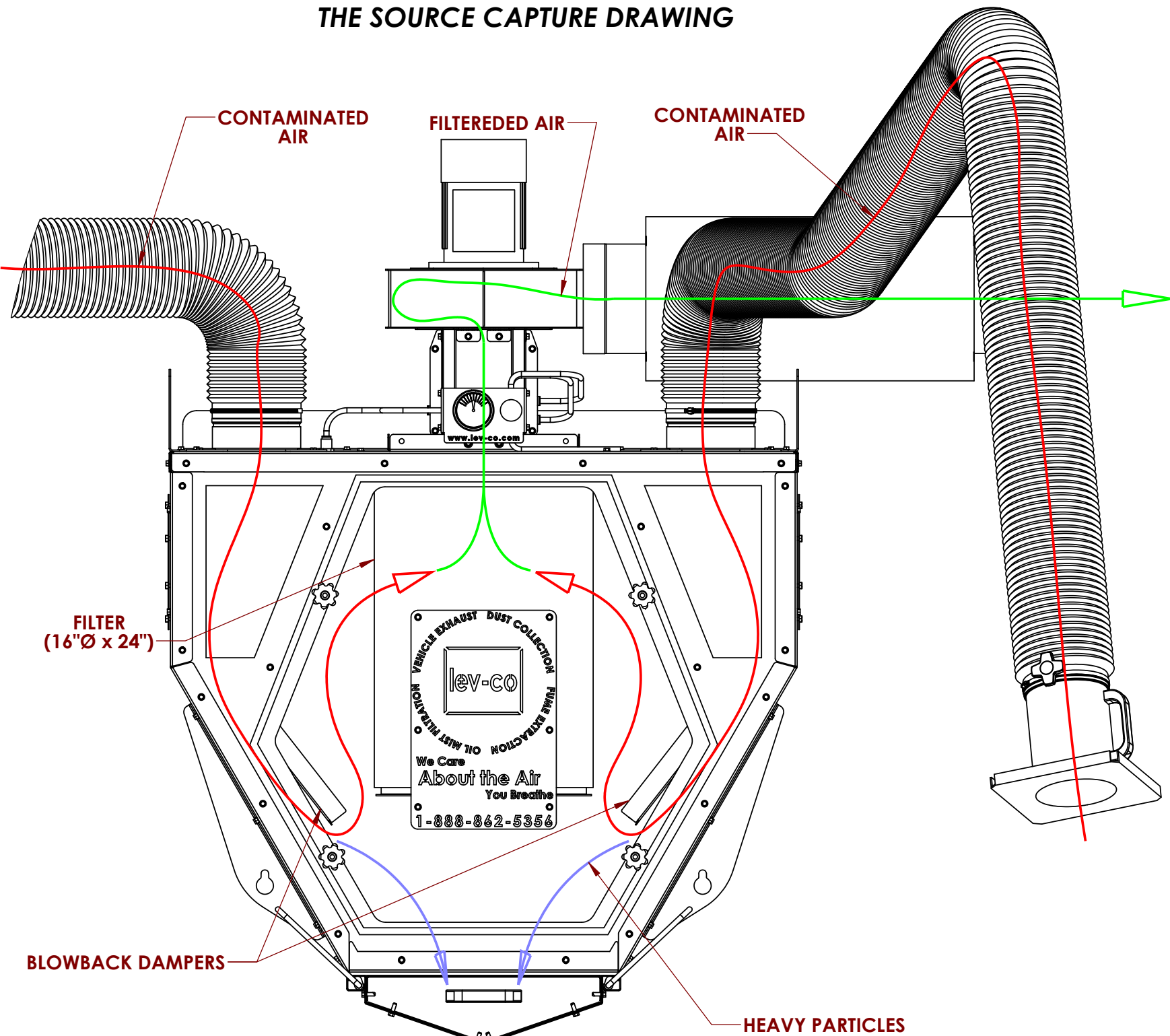

* IN THIS VIEW THE FRONT DOOR IS NOT SHOWN

CUSTOMER:
CUSTOMER P.O.:
PROJECT:
ENGINEER:
SALES REP.:
IDENTIFICATION / TAGGING:

www.lev-co.com • 1.888.862.5356



The device depicted and described hereon embodies proprietary information owned by the manufacturer. All design, manufacturing, reproduction, sales and patent rights regarding this device or drawing reserved except where explicit right is guaranteed in writing. We reserve the right to make design changes.

Drawn by:	Janos B
Date:	5/23/2014
Scale:	NTS
Weight:	N/A

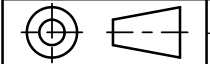

(03-051) DUAL WALL FLEX	
Specification Drawing	
Drawing No.: -	File Name: (03-051) Dual Wall Flex - SD
Material: -	Sheet: 6/8

<div> <div></div> <div></div> <div></div> <div></div> <div></div> <div></div> </div> <div> <div></div> <div></div> <div></div> <div></div> <div></div> <div></div> </div>				<div> <div></div> <div></div> <div></div> <div></div> <div></div> <div></div> </div> <div> <div></div> <div></div> <div></div> <div></div> <div></div> <div></div> </div>			
<div> <div></div> <div></div> <div></div> <div></div> <div></div> <div></div> </div> <div> <div></div> <div></div> <div></div> <div></div> <div></div> <div></div> </div>				<div> <div></div> <div></div> <div></div> <div></div> <div></div> <div></div> </div> <div> <div></div> <div></div> <div></div> <div></div> <div></div> <div></div> </div>			
<div> <div></div> <div></div> <div></div> <div></div> <div></div> <div></div> </div> <div> <div></div> <div></div> <div></div> <div></div> <div></div> <div></div> </div>				<div> <div></div> <div></div> <div></div> <div></div> <div></div> <div></div> </div> <div> <div></div> <div></div> <div></div> <div></div> <div></div> <div></div> </div>			
<div> <div></div> <div></div> <div></div> <div></div> <div></div> <div></div> </div> <div> <div></div> <div></div> <div></div> <div></div> <div></div> <div></div> </div>				<div> <div></div> <div></div> <div></div> <div></div> <div></div> <div></div> </div> <div> <div></div> <div></div> <div></div> <div></div> <div></div> <div></div> </div>			
<div> <div></div> <div></div> <div></div> <div></div> <div></div> <div></div> </div> <div> <div></div> <div></div> <div></div> <div></div> <div></div> <div></div> </div>				<div> <div></div> <div></div> <div></div> <div></div> <div></div> <div></div> </div> <div> <div></div> <div></div> <div></div> <div></div> <div></div> <div></div> </div>			
<div> <div></div> <div></div> <div></div> <div></div> <div></div> <div></div> </div> <div> <div></div> <div></div> <div></div> <div></div> <div></div> <div></div> </div>				<div> <div></div> <div></div> <div></div> <div></div> <div></div> <div></div> </div> <div> <div></div> <div></div> <div></div> <div></div> <div></div> <div></div> </div>			
<div> <div></div> <div></div> <div></div> <div></div> <div></div> <div></div> </div> <div> <div></div> <div></div> <div></div> <div></div> <div></div> <div></div> </div>				<div> <div></div> <div></div> <div></div> <div></div> <div></div> <div></div> </div> <div> <div></div> <div></div> <div></div> <div></div> <div></div> <div></div> </div>			
<div> <div></div> <div></div> <div></div> <div></div> <div></div> <div></div> </div> <div> <div></div> <div></div> <div></div> <div></div> <div></div> <div></div> </div>				<div> <div></div> <div></div> <div></div> <div></div> <div></div> <div></div> </div> <div> <div></div> <div></div> <div></div> <div></div> <div></div> <div></div> </div>			
<div> <div></div> <div></div> <div></div> <div></div> <div></div> <div></div> </div> <div> <div></div> <div></div> <div></div> <div></div> <div></div> <div></div> </div>				<div> <div></div> <div></div> <div></div> <div></div> <div></div> <div></div> </div> <div> <div></div> <div></div> <div></div> <div></div> <div></div> <div></div> </div>			
<div> <div></div> <div></div> <div></div> <div></div> <div></div> <div></div> </div> <div> <div></div> <div></div> <div></div> <div></div> <div></div> <div></div> </div>				<div> <div></div> <div></div> <div></div> <div></div> <div></div> <div></div> </div> <div> <div></div> <div></div> <div></div> <div></div> <div></div> <div></div> </div>			
<div> <div></div> <div></div> <div></div> <div></div> <div></div> <div></div> </div> <div> <div></div> <div></div> <div></div> <div></div> <div></div> <div></div> </div>				<div> <div></div> <div></div> <div></div> <div></div> <div></div> <div></div> </div> <div> <div></div> <div></div> <div></div> <div></div> <div></div> <div></div> </div>			
<div> <div></div> <div></div> <div></div> <div></div> <div></div> <div></div> </div> <div> <div></div> <div></div> <div></div> <div></div> <div></div> <div></div> </div>				<div> <div></div> <div></div> <div></div> <div></div> <div></div> <div></div> </div> <div> <div></div> <div></div> <div></div> <div></div> <div></div> <div></div> </div>			
<div> <div></div> <div></div> <div></div> <div></div> <div></div> <div></div> </div> <div> <div></div> <div></div> <div></div> <div></div> <div></div> <div></div> </div>				<div> <div></div> <div></div> <div></div> <div></div> <div></div> <div></div> </div> <div> <div></div> <div></div> <div></div> <div></div> <div></div> <div></div> </div>			
<div> <div></div> <div></div> <div></div> <div></div> <div></div> <div></div> </div> <div> <div></div> <div></div> <div></div> <div></div> <div></div> <div></div> </div>				<div> <div></div> <div></div> <div></div> <div></div> <div></div> <div></div> </div> <div> <div></div> <div></div> <div></div> <div></div> <div></div> <div></div> </div>			
<div> <div></div> <div></div> <div></div> <div></div> <div></div> <div></div> </div> <div> <div></div> <div></div> <div></div> <div></div> <div></div> <div></div> </div>				<div> <div></div> <div></div> <div></div> <div></div> <div></div> <div></div> </div> <div> <div></div> <div></div> <div></div> <div></div> <div></div> <div></div> </div>			
<div> <div></div> <div></div> <div></div> <div></div> <div></div> <div></div> </div> <div> <div></div> <div></div> <div></div> <div></div> <div></div> <div></div> </div>				<div> <div></div> <div></div> <div></div> <div></div> <div></div> <div></div> </div> <div> <div></div> <div></div> <div></div> <div></div> <div></div> <div></div> </div>			
<div> <div></div> <div></div> <div></div> <div></div> <div></div> <div></div> </div> <div> <div></div> <div></div> <div></div> <div></div> <div></div> <div></div> </div>				<div> <div></div> <div></div> <div></div> <div></div> <div></div> <div></div> </div> <div> <div></div> <div></div> <div></div> <div></div> <div></div> <div></div> </div>			
<div> <div></div> <div></div> <div></div> <div></div> <div></div> <div></div> </div> <div> <div></div> <div></div> <div></div> <div></div> <div></div> <div></div> </div>							

MODELS and OPTIONS:

Fan Control Panels (when ordering main unit)

	Part #	Description
<input type="checkbox"/>	P-024-2	Fan Motor control station. Permits manual start-stop of the fan. Comes complete with motor overload protection and on/off control. 0.6-1.0A OVERLOAD----> HP rating: 1/4@230/3/60, 1/2@460/3/60, 1/2@575/3/60
<input type="checkbox"/>	P-024-3	Fan Motor control station. Permits manual start-stop of the fan. Comes complete with motor overload protection and on/off control. 1-1.6A OVERLOAD ----> HP rating: 1/3@230/3/60. 3/4@460/3/60, 1.0@575/3/60
<input type="checkbox"/>	P-024-4	Fan Motor control station. Permits manual start-stop of the fan. Comes complete with motor overload protection and on/off control. 1.6-2.5A OVERLOAD ----> HP rating: 1/2@230/3/60, 1.0@460/3/60, 2@575/3/60
<input type="checkbox"/>	P-024-5	Fan Motor control station. Permits manual start-stop of the fan. Comes complete with motor overload protection and on/off control. 2.5-4A OVERLOAD----> HP rating: 1.0@230/3/60, 2.0@460/3/60, 3.0@575/3/60
<input type="checkbox"/>	P-024-6	Fan Motor control station. Permits manual start-stop of the fan. Comes complete with motor overload protection and on/off control. 4.0-6.3A OVERLOAD----> HP rating: 0.25@115/1/60, 0.5@230/1/60, 1.5@230/3/60, 3/0@460/3/60, 5.0@575/3/60
<input type="checkbox"/>	P-024-7	Fan Motor control station. Permits manual start-stop of the fan. Comes complete with motor overload protection and on/off control. 6.0-10A OVERLOAD----> HP rating: 0.5@115/1/60, 1.5@230/1/60, 3.0@230/3/60, 5.0@460/3/60, 7.5@575/3/60V
<input type="checkbox"/>	P-024-7	Fan Motor control station. Permits manual start-stop of the fan. Comes complete with motor overload protection and on/off control. 6.0-10A OVERLOAD----> HP rating: 3.0@230/3/60 BOM updated 10-01-2010
<input type="checkbox"/>	P-024-8	Fan Motor control station. Permits manual start-stop of the fan. Comes complete with motor overload protection and on/off control. 10-16A OVERLOAD----> HP rating: 1.0@115/1/60, 2.0@230/1/60, 5.0@230/3/60, 10@460/3/60, 10@575/3/60V
<input type="checkbox"/>	P-024-9	Fan Motor control station. Permits manual start-stop of the fan. Comes complete with motor overload protection and on/off control. 16-20A OVERLOAD----> HP rating: 1.5@115/1/60

Preventative Maintenance Pressure Gauges, etc. (when ordering main unit)

	Part #	Description
<input type="checkbox"/>	PG-5	Differential pressure gage, Range: 0-5in w.c.
	PG-10	Differential pressure gage, Range: 0-10in w.c.

Installation Accessories

	Part #	Description
<input type="checkbox"/>	WF-DUO-PP	Push Pull Ventilation kit for Wall Flex Duo. Kit includes the following: 2 - Dampened inlets that allow capture of fumes at ground level 1 - "Fan Tail" exhaust plenum that allows for air to be recycled up to highest portions of the shop allowing the cooler air from the lower to mix with the warm air in the ceiling. Returns energy savings and best dilution of fumes.
Replacement filters - (Quantity discounts available upon request)		
	Part #	Description
<input type="checkbox"/>	7FR0-2020-BB	FR Nano-Fiber Blend Cartridge for DCH-2, PCH-2 DT-1700 and Wall Flex Duo's C/W 2 Vibra-Pulse tubes.
	BB-2416-PTFE	Teflon Replacement Main Filter (PTFE) C/W 2 Vibra-Pulse tubes.

CUSTOMER:

CUSTOMER P.O.:

PROJECT:

ENGINEER:

SALES REP.:

IDENTIFICATION / TAGGING:



The device depicted and described hereon embodies proprietary information owned by the manufacturer. All design, manufacturing, reproduction, sales and patent rights regarding this device or drawing reserved except where explicit right is guaranteed in writing. We reserve the right to make design changes.

Drawn by: Janos B

Date: 5/23/2014

Scale: NTS

Weight: N/A

(03-051)
DUAL WALL FLEX

Specification Drawing

Drawing No.: -

File Name: (03-051) Dual Wall Flex - SD

Material: -

Sheet: 8/8