

SPECIFICATIONS:

CONSTRUCTION: Model 66-0; Base cabinet; 18 Gauge painted steel cabinet finished with a Powder-Coat finish. Includes Ultra-Seal filter mounting system, hinged side access door to filters, (2) 3" top Inlets, 2" swivel casters, filter change Indicator gauge, fully enclosed motor/blower, on-off switch, and 6' power cord.

WEIGHT: 83 lbs.

AIRFLOW: 120 CFM (Single arm)
210 CFM (Dual arms)
250 CFM (3 arms)

ELECTRICAL: 1/2 HP 115/1/60, 7.4 amps, std.
1/2 HP 220/1/50, 2.8 amps, opt.

NOISE: 61 dBA

FILTER SEAL: Ultra-Seal, with positive sealing filter locking mechanism for all main filters, optional HEPA filter and adsorber modules (when used). Slide In tracks shall be used for prefilters only.

FIRE SUPPRESSION: Equipment provided by others.

- PREFILTERS:** (1) 2" Pleated std.
 (1) Aluminum Mesh, opt.
- MAIN FILTERS:** (1) 95% cartridge, std.
 (1) HEPA 99.97% D.O.P., opt.
- AFTER FILTERS:** (1) 1" charcoal, std.
 (1) 1" polyester, opt.
- AD OPTION:** (1) Refillable v-bank adsorber module, 7 lb. capacity, with a 1" poly afterfilter.
- MODEL 66-1E:** (1) 2 1/2", 6' long E-Z Arm top mounted.
- MODEL 66-2E:** (2) 2 1/2", 6' long E-Z Arms top mounted.
- MODEL 66-3E:** (3) 2 1/2", 6' long E-Z Arms top mounted.
- MODEL 66-0:** (2) 3" Inlets on top-no arms.
 (1) 5' long E-Z Arm II mounted on top of unit.
- MODEL 68-0:** (3) 3" Inlets on side-no arms.

* AFS FILTER EFFICIENCIES BASED ON ASHRAE 52-76 TEST METHOD

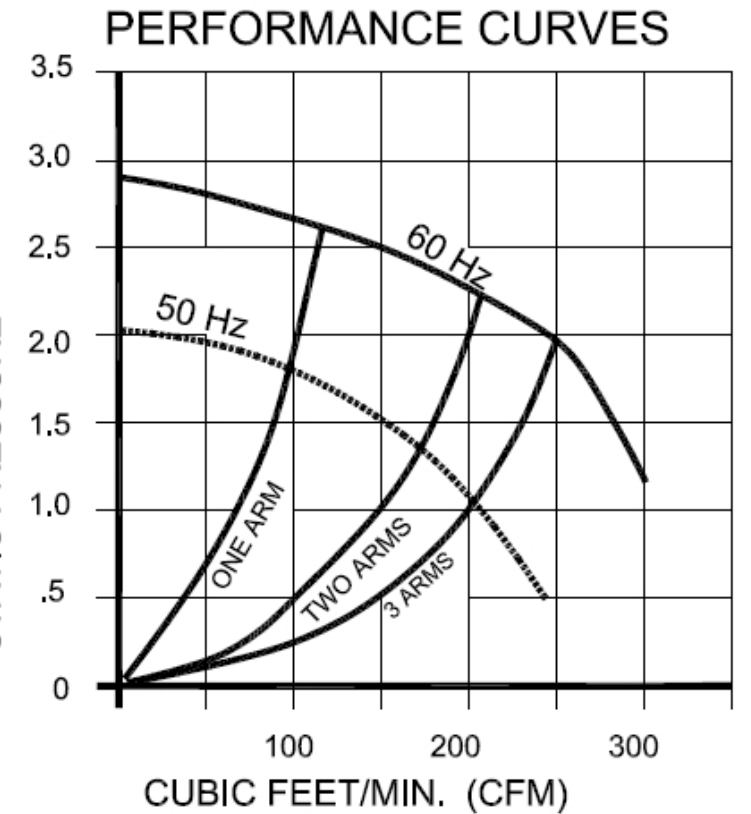
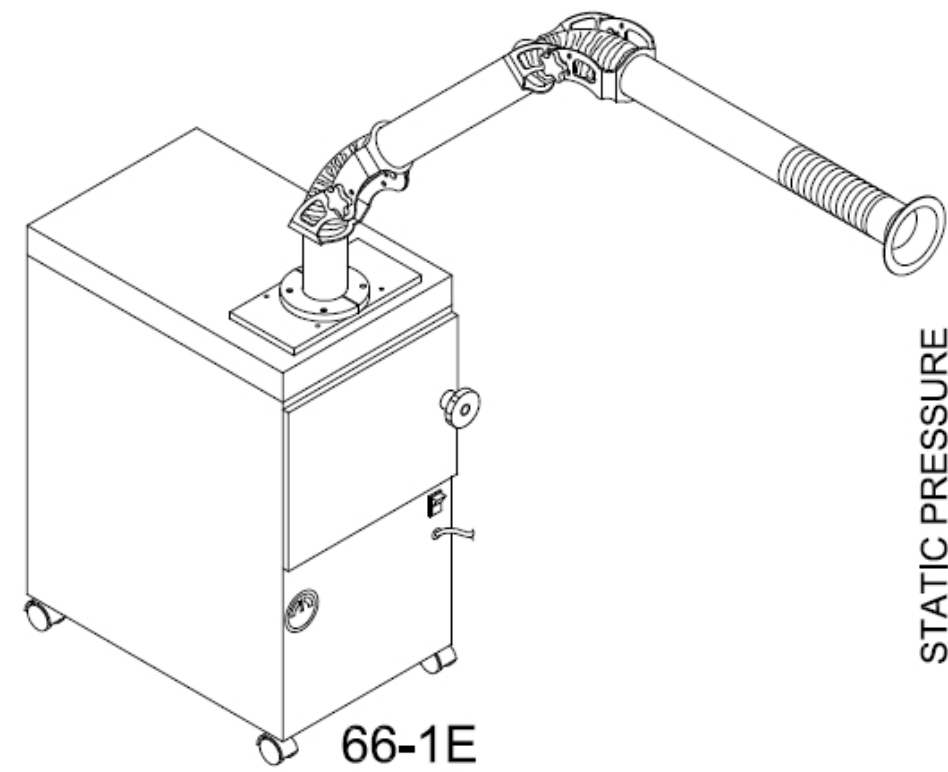
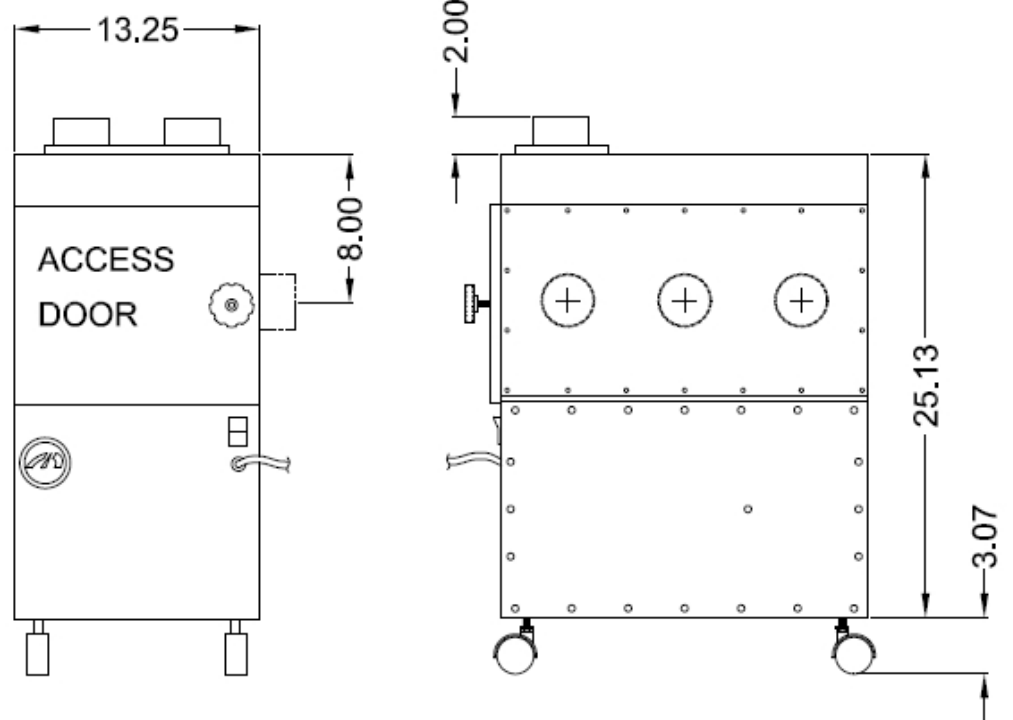
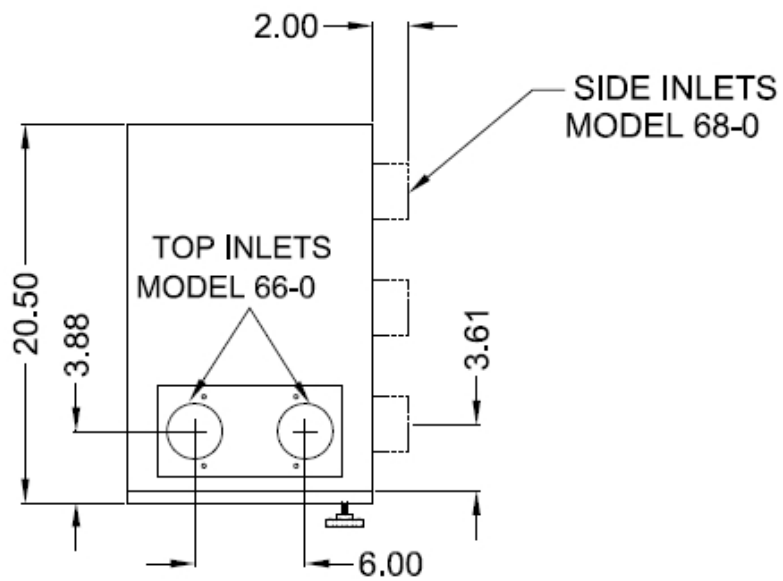

02-08

CUSTOMER:	
CUSTOMER P.O.:	
PROJECT:	
ENGINEER:	
SALES REP.:	
IDENTIFICATION / TAGGING:	

www.lev-co.com • 1.888.862.5356



The device depicted and described hereon embodies proprietary information owned by the manufacturer. All design, manufacturing, reproduction, sales and patent rights regarding this device or drawing reserved except where explicit right is guaranteed in writing. We reserve the right to make design changes.

Drawn by:	Janos B
Date:	5/1/2008
Scale:	NTS
Weight:	N/A

02-08 MiniVac	
PORTABLE DUST COLLECTOR	
Specification Drawing	
Drawing No.:	-
Material:	-
File Name:	(02-08) MiniVAC - SD
Sheet:	1/2

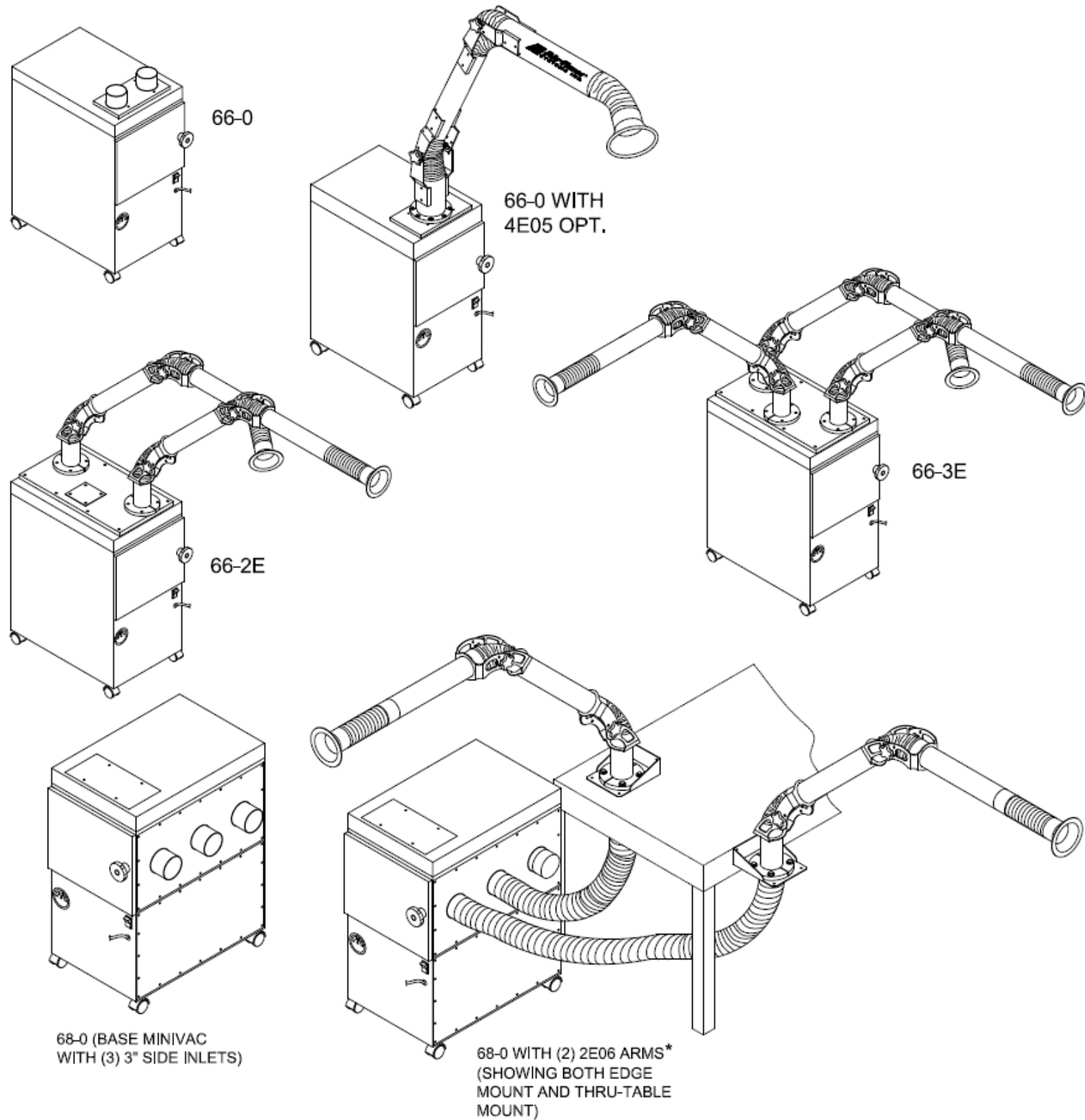

MODELS & OPTIONS:

Part #	Description
Main System / Part	
<input type="checkbox"/> 68-0	MiniVac portable air cleaner with (3) 3" inlets on side (arms not included).
<input type="checkbox"/> 66-0	MiniVac portable air cleaner with (2) 3" inlets on top (arms not included).
<input type="checkbox"/> 66-1E	MiniVac portable air cleaner with (1) E-Z Arm 2.5" Ø, 6' long arm mounted on top of unit.
<input type="checkbox"/> 66-2E	MiniVac portable air cleaner with (2) E-Z Arm 2.5" Ø, 6' long arms mounted on top of unit.
<input type="checkbox"/> 66-3E	MiniVac portable air cleaner with (3) E-Z Arm 2.5" Ø, 6' long arms mounted on top of unit.
Extraction Arms	
<input type="checkbox"/> MINIVAC-4E05	4" Dia. High Performance Fume Arm, 5' Long Option for Standard FUME-PAK 66-0 Unit only
<input type="checkbox"/> MINIVAC-3AA3	3" arm assembly. 42" long (26" compressed, 42" extended) with metal internal support, complete with universal mounting bracket (up, down or thru table) plenum assembly. 3" diameter white plastic hose and a 3" x 6" white plastic hood. For use with 66-0 and 68-0 units only.
<input type="checkbox"/> MINIVAC-3AA5	3" arm assembly. 60" long (42" compressed, 60" extended) with metal internal support, complete with universal mounting bracket (up, down or thru table) plenum assembly. 3" diameter white plastic hose and a 3" x 6" white plastic hood. For use with 66-0 and 68-0 units only.
Filter Options (when ordering main unit)	
<input type="checkbox"/> MINIVAC-AD	Internal adsorption option: includes (1) 2" pleated prefilter (1) refillable v-bank adsorber module 7 lbs. capacity and (1) 1" polyester after-filter. Order charcoal separately. (Adds 20 lbs. to ship weight.)
<input type="checkbox"/> MINIVAC-HEPA	99.97% HEPA Filter Option for Standard MINI-VAC Unit
Hose, Hood & Nozzle Options	
<input type="checkbox"/> MINIVAC-ARM HOSE KIT-1	Includes 5' of 3" white hose, two (2) hose clamps, and two (2) white rubber hose clamp covers. (To be used with Model 66-0 or 68-0 and one (1) table mounted fume extraction arm.)
<input type="checkbox"/> MINIVAC-ARM HOSE KIT-2	Includes 10' of 3" white hose, four (4) hose clamps, and four (4) white rubber hose clamp covers. (To be used with Model 66-0 or 68-0 and two (2) table mounted fume extraction arms.)
<input type="checkbox"/> MINIVAC-ARM HOSE KIT-3	Includes 15' of 3" white hose, six (6) hose clamps, and six (6) white rubber hose clamp covers. (To be used with Model 68-0 and three (3) table mounted fume extraction arms.)
Fan, Light & Other Electrical Accessories	
<input type="checkbox"/> LTK-20	Light Kit 20 watt for use with Mini-Vac Arms.

02-08

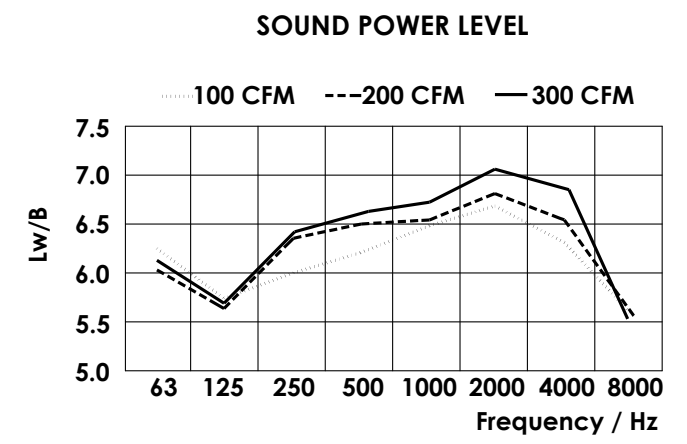
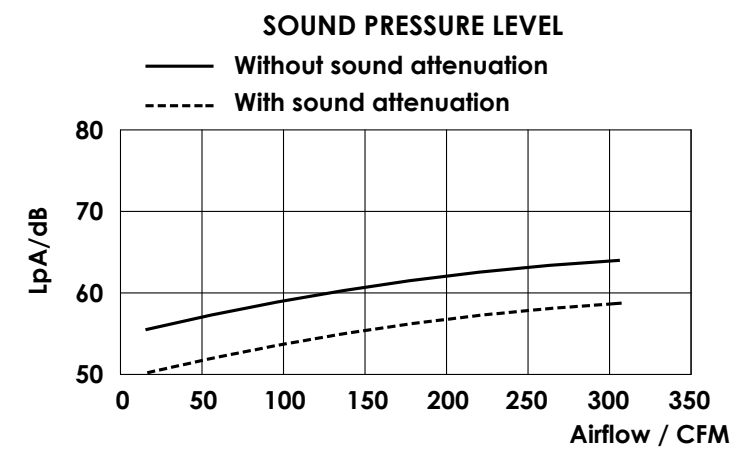

CUSTOMER:
CUSTOMER P.O.:
PROJECT:
ENGINEER:
SALES REP.:
IDENTIFICATION / TAGGING:

www.lev-co.com • 1.888.862.5356



The device depicted and described hereon embodies proprietary information owned by the manufacturer. All design, manufacturing, reproduction, sales and patent rights regarding this device or drawing reserved except where explicit right is guaranteed in writing. We reserve the right to make design changes.

Drawn by:	Janos B
Date:	5/1/2008
Scale:	NTS
Weight:	N/A

02-08 MiniVac	
PORTABLE DUST COLLECTOR	
Specification Drawing	
Drawing No.:	File Name: (02-08) MiniVAC - SD
Material:	Sheet: 2/2