

TOP VIEW
(SHOWN LESS ARM)

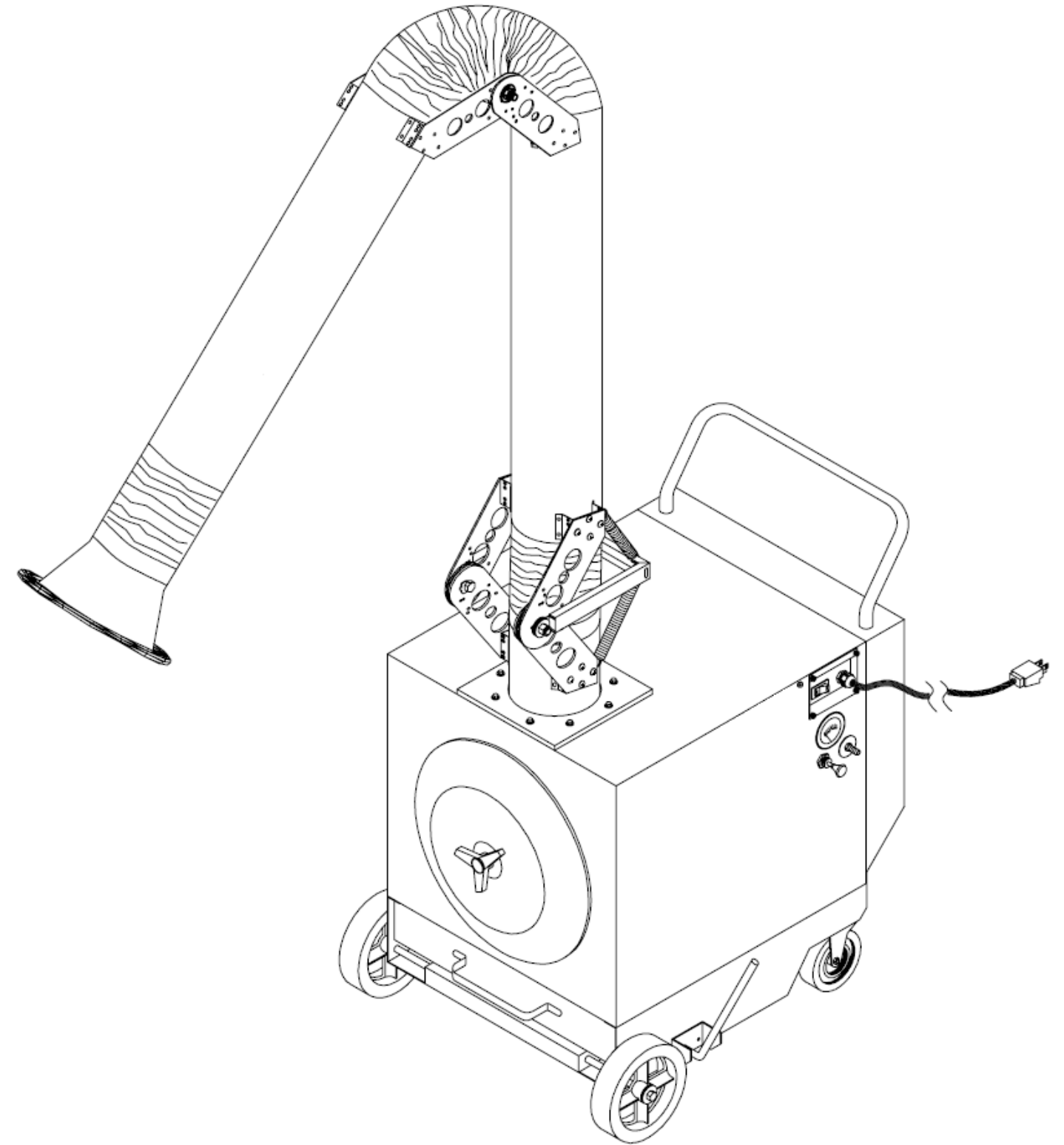

02-02

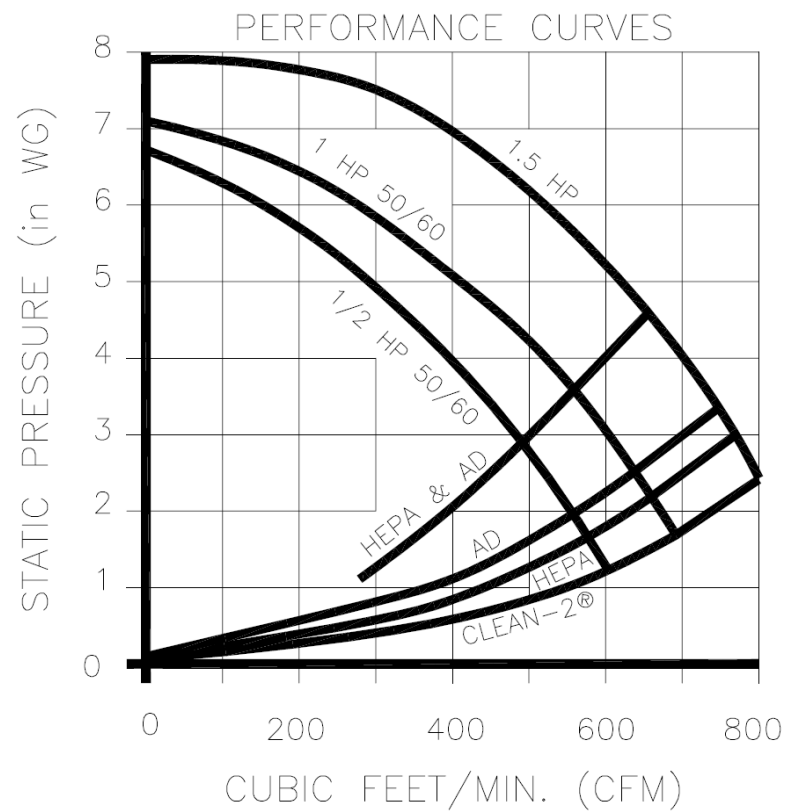
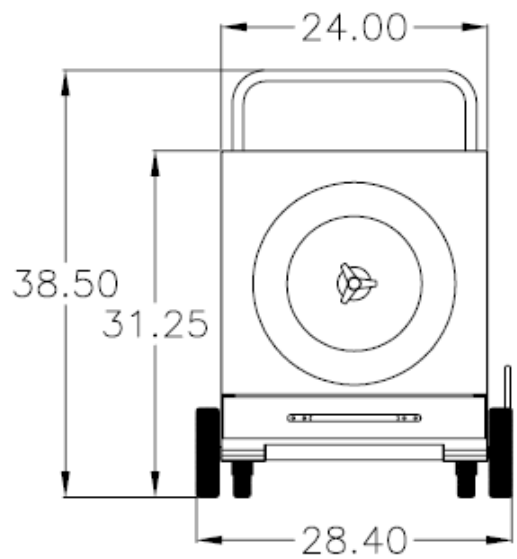

BACK VIEW
(SHOWN LESS ARM)

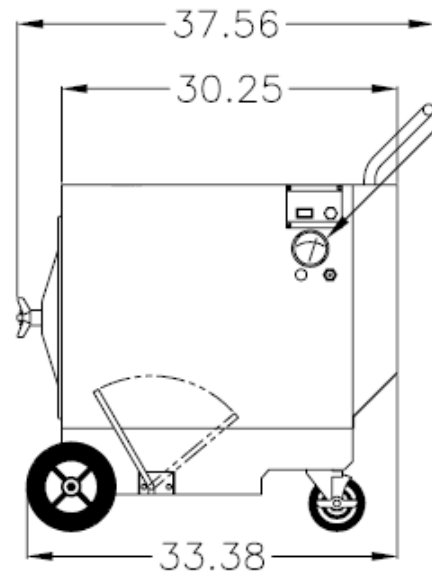

SIDE VIEW
(SHOWN LESS ARM)

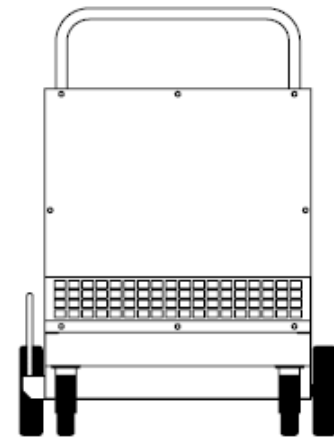

FRONT VIEW
(SHOWN LESS ARM)

OPTIONAL
PRESSURE
GAUGE
SHOWN

CUSTOMER:
CUSTOMER P.O.:
PROJECT:
ENGINEER:
SALES REP.:
IDENTIFICATION / TAGGING:

> www.lev-co.com • 1.888.862.5356

lev-co

The device depicted and described hereon embodies proprietary information owned by the manufacturer. All design, manufacturing, reproduction, sales and patent rights regarding this device or drawing reserved except where explicit right is guaranteed in writing. We reserve the right to make design changes.

Drawn by:	DAN
Date:	3/22/2008
Scale:	NTS
Weight:	N/A

02-02 PCH-1
PORTABLE DUST COLLECTOR
Specification Drawing

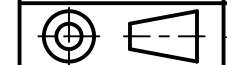

Drawing No.:	-	File Name:	PCH-1 - SD
Material:		Product manufactured by:	

Sheet: 1/2

Part #	Description
Main System / Part	
<input type="checkbox"/> PCH-1-1.5HP-1	800 cfm portable cartridge collector with (1) 7' long E-Z Arm® high flow extractor (WITH DAMPER), (1) CLEAN-2® cartridge filter (150 sq.ft. of media), manual VIBRA-PULSE® filter cleaning system, a 1.5 Hp TEFC motor 115/1/60Hz (12/6 amps), backward incline blower, removable 5 gallon external dust drawer, 8" front wheels and 5" rear swivel casters. 70 dBA
<input type="checkbox"/> PCH-1-1.5HP-2	800 cfm portable cartridge collector with (1) 7' long E-Z Arm® high flow extractor (WITH DAMPER), (1) CLEAN-2® cartridge filter (150 sq.ft. of media), manual VIBRA-PULSE® filter cleaning system, a 1.5 Hp TEFC motor 230/1/60Hz (12/6 amps), backward incline blower, removable 5 gallon external dust drawer, 8" front wheels and 5" rear swivel casters. 70 dBA
<input type="checkbox"/> PCH-1-1.5HP-3	800 cfm portable cartridge collector with (1) 7' long E-Z Arm® high flow extractor (WITH DAMPER), (1) CLEAN-2® cartridge filter (150 sq.ft. of media), manual VIBRA-PULSE® filter cleaning system, a 1.5 Hp TEFC motor 230/460/3/60Hz (12/6 amps), backward incline blower, removable 5 gallon external dust drawer, 8" front wheels and 5" rear swivel casters. 70 dBA
<input type="checkbox"/> PCH-1-1.5HP-4	800 cfm portable cartridge collector with (1) 7' long E-Z Arm® high flow extractor (WITH DAMPER), (1) CLEAN-2® cartridge filter (150 sq.ft. of media), manual VIBRA-PULSE® filter cleaning system, a 1.5 Hp TEFC motor 575/3/60Hz (12/6 amps), backward incline blower, removable 5 gallon external dust drawer, 8" front wheels and 5" rear swivel casters. 70 dBA
<input type="checkbox"/> PCH-1-1HP	700 cfm portable cartridge collector with (1) 7' long E-Z Arm® high flow extractor (WITH DAMPER), (1) CLEAN-2® cartridge filter (150 sq.ft. of media), manual VIBRA-PULSE® filter cleaning system, a 1 Hp TEFC motor 115/230/1/60Hz (12/6 amps), backward incline blower, removable 5 gallon external dust drawer, 8" front wheels and 5" rear swivel casters. 70 dBA

Part #	Description
Fan / Motor Upgrades or Options (when ordering main unit)	
<input type="checkbox"/> PCH-1-1/2HP	Replace standard 1 HP motor with a 1/2HP, TEFC motor, 115/230/1/60, BI (600 CFM)
Extraction Arms	
<input type="checkbox"/> PCH-1-7E10-DD	(1) 10' Long E-Z Arm Option for Standard PCH-1 Unit. Note: this is the upgrade cost and already includes the price deduction for the 7' arm.
<input type="checkbox"/> PCH-1-DA-4-DD	(2) 4" dia., x 8' long Option for Standard PCH-1 Unit
Filter Options (when ordering main unit)	
<input type="checkbox"/> PCH-1-EXAD	External AD Gas & Vapor adsorption Module Option
<input type="checkbox"/> PCH-1-EXDOP	External 95% DOP Filter Option
<input type="checkbox"/> PCH-1-EXHE	External 99.97% HEPA Filter Option
<input type="checkbox"/> PCH-1-EXT HE/AD	Kit using EXTERNAL HEPA and EXTERNAL AD options. Order Charcoal Separately.
Preventative Maintenance Pressure Gauges, etc. (when ordering)	
<input type="checkbox"/> PCH-1-PG-6	0-6" magna-helic pressure gauge, approximately 5" diameter size. Surface mounted.
Misc. Options	
<input type="checkbox"/> OM-019/160	Standing Flange for mounting Flexi-I Arms on DCH/PCH units
Sound Attenuation	
<input type="checkbox"/> PCH-1-S-EXT	External Silencer Option
Fan, Light & Other Electrical Accessories	
<input type="checkbox"/> PCH-1-LTH65	Light Kit on Option for Standard PCH-1 Unit
<input type="checkbox"/> PCH-1-LTH65L	Light Kit, Switch for light on hood Option for Standard PCH-1 Unit
<input type="checkbox"/> PCH-1-LTH65LB	Light Kit, Switches for light and unit on hood Option for Standard PCH-1 Unit
Retro-Fit Parts	
<input type="checkbox"/> 2KT51733	External HEPA Retrofit Kit for PCH-1, PCH-2, DCH-1, DCH-2, DTH-800, DTH-1700
<input type="checkbox"/> 2KT51734	External AD Retrofit Kit for PCH-1, PCH-2, DCH-1, DCH-2, DTH-800, DTH-1700. Charcoal not included. Please order charcoal separately.
<input type="checkbox"/> 2KT51739	External HEPA & AD Retrofit Kit for PCH-1, PCH-2, DCH-1, DCH-2, DTH-800, DTH-1700. Charcoal not included. Please order charcoal separately.
<input type="checkbox"/> 2KT51768	External Silencer Retrofit Kit for PCH-1, PCH-2, DCH-1, DCH-2, DTH-800, DTH-1700

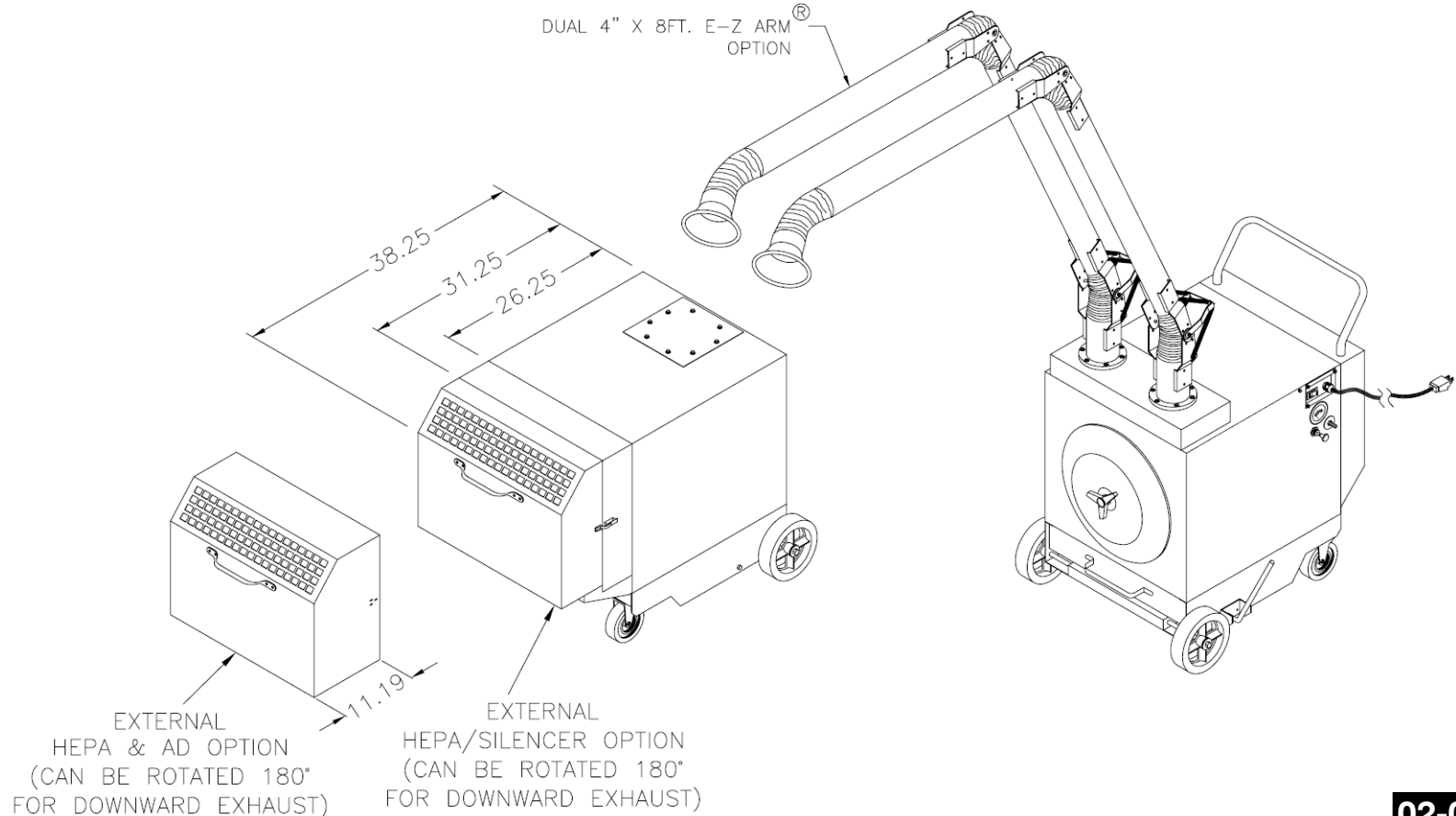

CONSTRUCTION: 12/14/16 Gauge steel cabinet finished with Powder-Coat Finish. Includes a 5 gallon external dust drawer, 7' E-Z ARM® High Flow Extractor arm, removable end cap for easy access to filter, removable panel for easy access to B.I. motor/blower, 8" casters, 25' 12 Ga. power cord, and on-off switch. Motor wired to junction box outside unit for 3 phase. Acoustical lining standard in blower compartment. Vibra-Pulse® cleaning standard.

WEIGHT: 254 lbs.

AIRFLOW: 600 CFM with opt. 1/2 HP motor
700 CFM with std. 1 HP motor
800 CFM with opt. 1.5 HP motor

NOISE: 65 dBA - 1/2 HP
70 dBA - 1 HP

ELECTRICAL: 1 HP 115/1/60, 12 amps, std.
 1 HP 208-230/460/3/60, 3.7-3.6/1.8 amps, opt
 1.5 HP 115/208-230/1/60, 15/7.9-7.5 amps, opt.
 1.5 HP 208-230/460/3/60, 4.9-4.6/2.3 amps, opt
 1/2 HP 115/1/60, 9.8 amps, opt

FIRE SUPPRESSION: Equipment provided by others.

SPECIFICATIONS:

MAIN FILTERS: (1) CLEAN-2® Filter cartridge, 16"Dx12", Std.
 (1) Cartridge, FIBERDUST®, Opt.
 (1) Cartridge, Spark Resistant, Opt.
 (1) Cartridge, Spunbond - H0, Opt.
 (1) Cartridge, CleanPlus double treated fire retardant, Opt.

AFTER FILTERS: (1) External HEPA filter, 99.97%, Opt.
 (1) External DOP filter, 95%, Opt.
 (1) External adsorber, 18 lb. capacity, Opt.
 (1) Activated Charcoal, Opt.
 (1) Purofil, Opt.

OTHER OPTIONS: Pressure gauge kit indicates filter changes
 10' E-Z ARM® High Flow Extractor
 Regulator
 Silencer (Adds 8" to depth of unit)

SPECIAL NOTES: Compressed air filter provided by others.
* AFS FILTER EFFICIENCIES BASED ON ASHRAE 52-76 TEST METHOD

02-02

CUSTOMER:
CUSTOMER P.O.:
PROJECT:
ENGINEER:
SALES REP.:
IDENTIFICATION / TAGGING:

www.lev-co.com • 1.888.862.5356



The device depicted and described hereon embodies proprietary information owned by the manufacturer. All design, manufacturing, reproduction, sales and patent rights regarding this device or drawing reserved except where explicit right is guaranteed in writing. We reserve the right to make design changes.

Drawn by:	DAN
Date:	3/22/2008
Scale:	NTS
Weight:	N/A

02-02 PCH-1
PORTABLE DUST COLLECTOR
Specification Drawing

Drawing No.: - File Name: PCH-1 - SD
Material: Product manufactured by: **Airflow SYSTEMS INC.** Sheet: 2/2